



26 Malvern Road

Swindon

£325,000



26 Malvern Road

Nestled in the sought-after Gorsehill location, this IMPRESSIVE and SUBSTANTIAL 3 Bedroom Semi Detached House has been lovingly RENOVATED THROUGHOUT BY CURRENT OWNERS, offering a blend of modern luxury and potential. The property features a GARAGE AND OFF ROAD PARKING, a MODERN FITTED KITCHEN, BAY WINDOWS providing natural light to the living area and BEDROOM ONE, as well as a charming CONSERVATORY perfect for relaxing or entertaining. The outdoor space of this property is as desirable as its interior, with a larger than average garden that wraps around the front, rear, and side of the property. The possibilities for enjoying this area are endless, whether it's hosting summer barbeques, creating a tranquil retreat, or cultivating a vibrant garden oasis. This exceptional outside space adds a unique dimension to the property, providing a private sanctuary within a bustling neighbourhood. Residents of this home will have the luxury of enjoying their own piece of nature, right at their doorstep. Don't miss out on the opportunity to own this exceptional property with a garden that is as remarkable as the house itself.



- RENOVATED THROUGHOUT BY CURRENT OWNERS
- POTENTIAL TO EXTEND STPC
- LARGE CORNER PLOT GARDEN
- GARAGE AND OFF ROAD PARKING
- MODERN FITTED KITCHEN
- BAY WINDOWS TO LIVING AREA AND BEDROOM ONE
- CONSERVATORY
- SEMI DETACHED
- POPULAR GORSEHILL LOCATION CLOSE TO LOCAL FACILITIES







Ground Floor

Approx. 58.8 sq. metres (633.2 sq. feet)

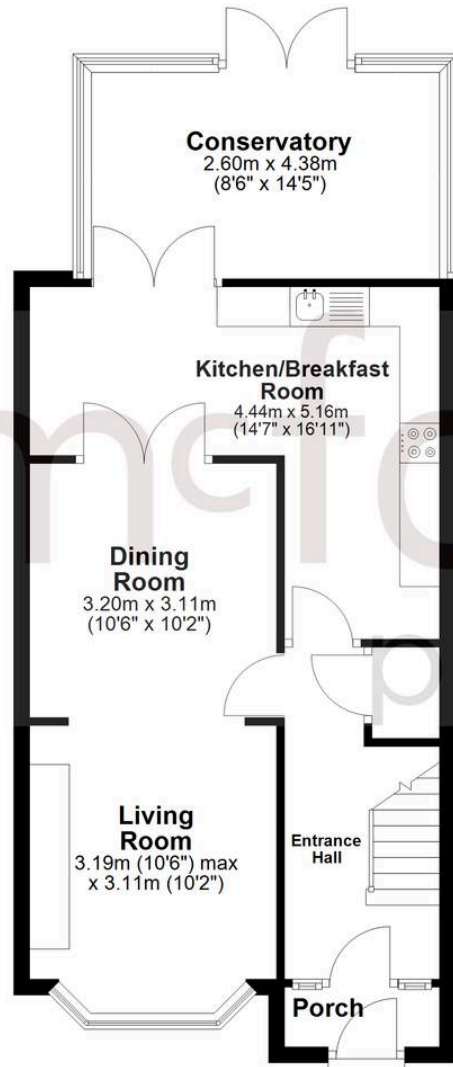

First Floor

Approx. 34.3 sq. metres (369.4 sq. feet)

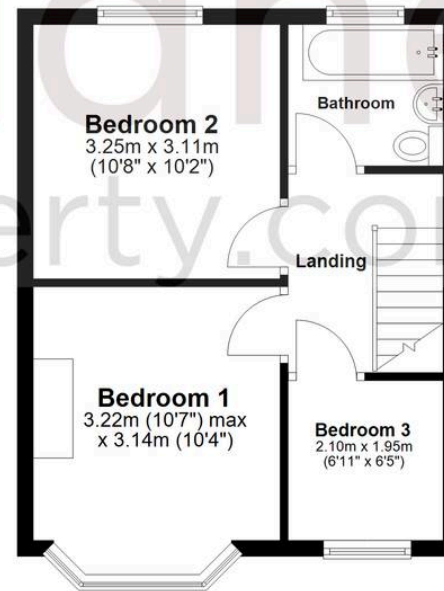

Total area: approx. 93.1 sq. metres (1002.6 sq. feet)

McFarlane Sales & Lettings

North Swindon, Redhouse Village Centre, Swindon – SN25 2FW

01793 296600 • swindon@mcfarlaneproperty.com • www.mcfarlaneproperty.com/