



33 Capesthorne Drive, Swindon

Swindon

Offers in Region of £560,000

mcFarlane
property.com



33 Capesthorne Drive

Swindon, Swindon

Situated in the sought-after Haydon Wick area, we present this impressive DETACHED and EXTENDED house that exudes modern charm. This property boasts not only a MODERN KITCHEN BREAKFAST ROOM but also THREE spacious RECEPTION rooms for all your entertaining needs. With FIVE BEDROOMS and THREE BATHROOMS, there is ample space for all your family or guests.

The house is WELL PRESENTED throughout, ensuring a warm and inviting atmosphere as soon as you step through the door. For added convenience, there is a single GARAGE and AMPLE PARKING for multiple vehicles. To the rear of the property the SOUTH FACING GARDEN is of a good size with a blend of lawn, shrub borders and an extensive patio area which is ideal for ALFRESCO dining.



- DETACHED
- EXTENDED
- THREE RECEPTIONS
- FIVE BEDROOMS
- MODERN KITCHEN BREAKFAST ROOM
- DESIRABLE HAYDON WICK LOCATION
- WELL PRESENTED THROUGHOUT
- SINGLE GARAGE
- AMPLE PARKING
- SOUTH FACING GARDEN



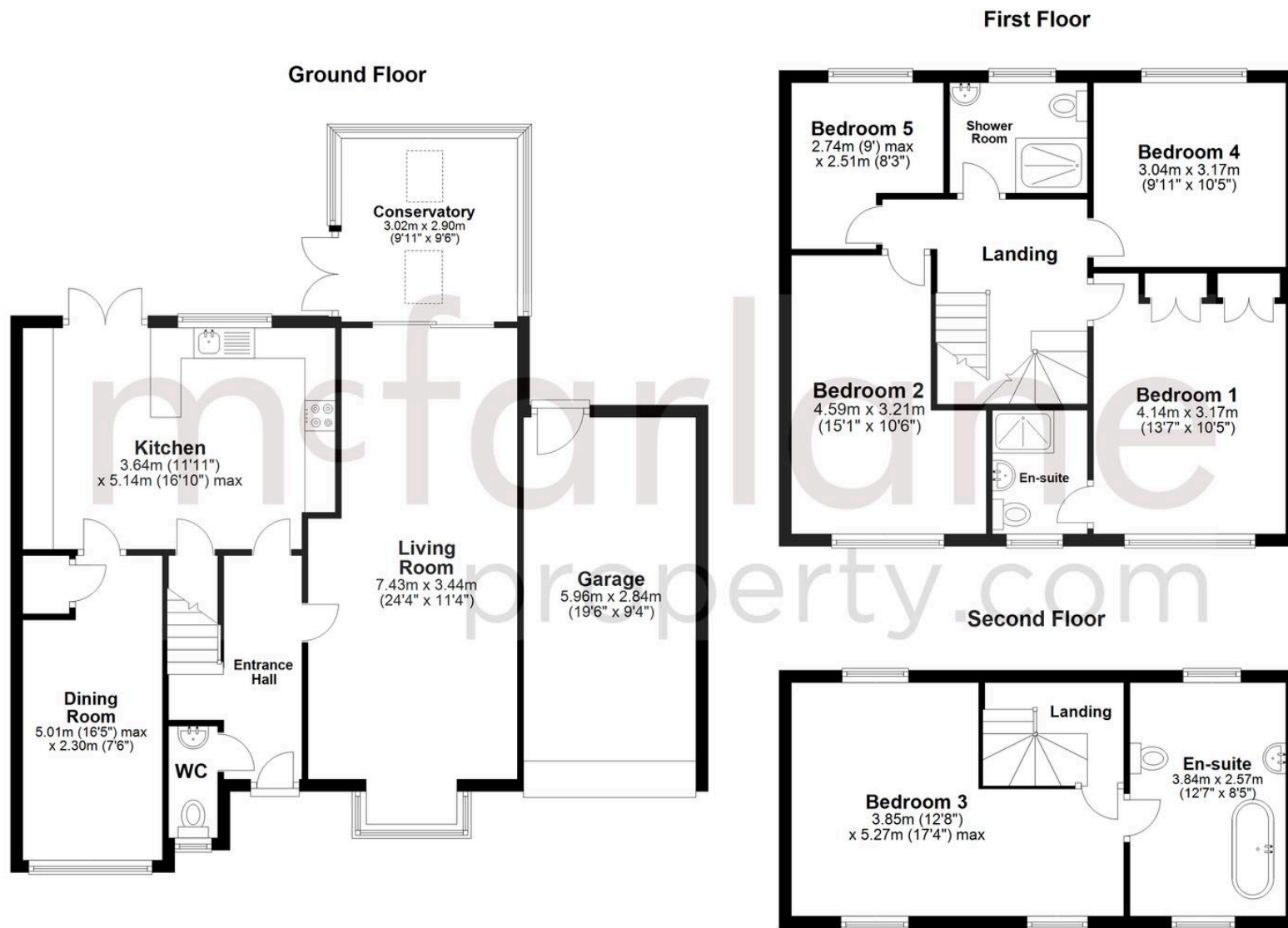

Total area: approx. 182.8 sq. metres (1968.0 sq. feet)

McFarlane Sales & Lettings

North Swindon, Redhouse Village Centre, Swindon – SN25 2FW

01793 296600 • swindon@mcfarlaneproperty.com • www.mcfarlaneproperty.com/