



2 Bedroom End Terraced House **£250,000**

10 Carter Close, Groundwell, Swindon, Wiltshire, SN25 4AD

**mcfarlane**  
property.com

## 2 Bedroom End Terraced House Swindon, North Swindon

- 2 BEDROOMS
- GARAGE AND DRIVEWAY
- DOWNSTAIRS CLOAKROOM
- LOW MAINTENANCE GARDEN

A well presented 2 bedroom END TERRACED home in the GROUNDWELL area of North Swindon. The property accommodation comprises, living room, kitchen/dining room, GROUND FLOOR CLOAKROOM, 2 bedrooms and family bathroom. Outside the property has a low maintenance rear garden, GARAGE and allocated parking. This would made an ideal FIRST TIME BUY or investment purchase.

Council Tax Band C - Estimated  
Cost £1,954 p.a.







## Ground Floor

Approx. 29.9 sq. metres (322.2 sq. feet)

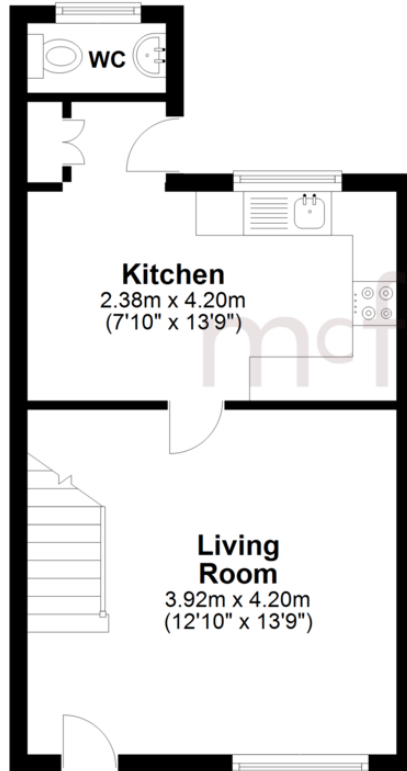

## First Floor

Approx. 26.9 sq. metres (289.7 sq. feet)

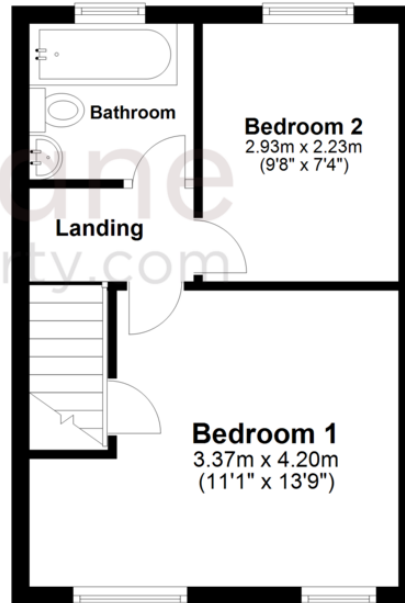

Total area: approx. 56.8 sq. metres (611.9 sq. feet)

We   
where you  
**LIVE**

Our team are friendly, experienced and are all local. They know it better than they do their own living rooms and can help you find what you're looking for because **we love where we live.**

We would be delighted to show you around this property.

**Because every home  
needs a personal touch.**

**If you would like to view this  
property then please get in touch.**

 01793 296600

 [swindon@mcfarlaneproperty.com](mailto:swindon@mcfarlaneproperty.com)

[mcfarlaneproperty.com](http://mcfarlaneproperty.com)

**mcfarlane**  
property.com

### **Cricklade.**

102 High Street  
Cricklade SN6 6AA

 01793 751044

### **Marlborough.**

106 High Street  
Marlborough SN8 1LT

 01672 514380

### **Old Town.**

28-30 Wood Street  
Swindon SN1 4AB

 01793 296880

### **Swindon.**

The Village Centre,  
Redhouse SN25 2FW

 01793 296600

Agents Note: Whilst every care has been taken to prepare these sales particulars, they are for guidance purposes only. All measurements are approximate are for general guidance purposes only and whilst every care has been taken to ensure their accuracy, they should not be relied upon and potential buyers are advised to recheck the measurements