



4 Bedroom Detached **Guide Price £425,000**

Hartington Road, Oakhurst, Swindon, Wiltshire , SN25 2EF

mcfarlane
property.com

4 Bedroom Detached North Swindon

- IMMACULATELY PRESENTED THROUGHOUT
- DETACHED
- DESIRABLE LOCATION
- AMPLE DRIVEWAY PARKING

McFarlane are delighted to offer this beautifully presented and improved throughout, four bedroom detached family home to the market, situated in the ever-popular area of Oakhurst, North Swindon. The internal accommodation must be viewed to be fully appreciated and offers an entrance hall, downstairs cloakroom, spacious living room with feature fireplace, fantastic study, separate dining room and impressive kitchen / breakfast room. Upstairs you will find four generous and immaculately presented bedrooms with the majority benefitting from built in wardrobes, master bedroom includes a modern ensuite, and a further re-fitted family bathroom suite completes this floor. Outside boasts a private and fully enclosed sunny aspect rear garden. In addition, the property further benefits from ample driveway parking and fantastic detached double garage.





We 
where you
LIVE

Our team are friendly, experienced and are all local. They know it better than they do their own living rooms and can help you find what you're looking for because **we love where we live.**

We would be delighted to show you around this property.

Because every home needs a personal touch.

If you would like to view this property then please get in touch.

 01793 296600

 swindon@mcfarlaneproperty.com

mcfarlaneproperty.com

Agents Note: Whilst every care has been taken to prepare these sales particulars, they are for guidance purposes only. All measurements are approximate are for general guidance purposes only and whilst every care has been taken to ensure their accuracy, they should not be relied upon and potential buyers are advised to recheck the measurements

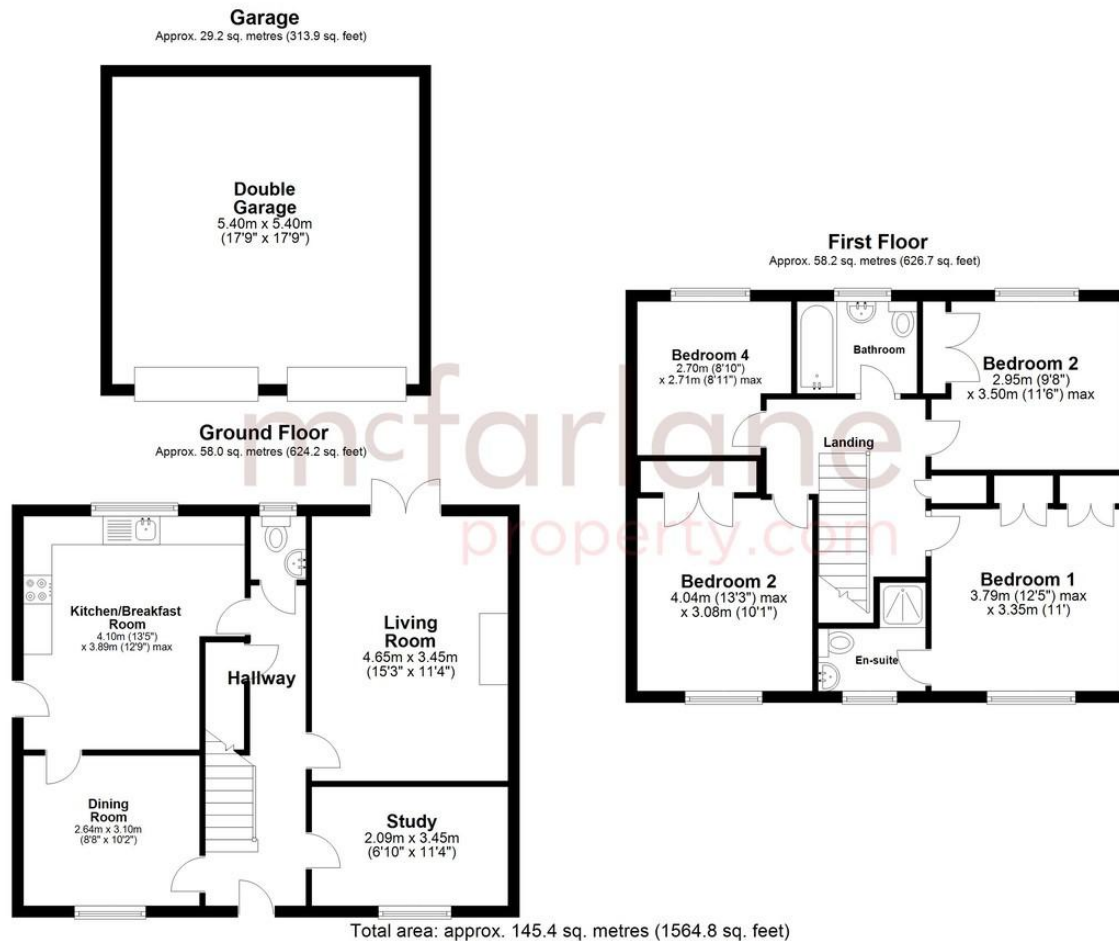

mcfarlane
property.com

Cricklade.
102 High Street
Cricklade SN6 6AA
 01793 751044

Marlborough.
106 High Street
Marlborough SN8 1LT
 01672 514380

Old Town.
28-30 Wood Street
Swindon SN1 4AB
 01793 296880

Swindon.
The Village Centre,
Redhouse SN25 2FW
 01793 296600