

A modern kitchen interior featuring a wooden countertop, grey cabinetry, and a black oven with a digital display. A stainless steel sink and a window with a view of a building under construction are also visible.

Trinity Street

Loughborough

1 Bed 1st Floor Apartment • LE11 1BY • £700 pcm • £800 Deposit



Trinity Street, Loughborough

An ideal apartment located in this quiet area close to Loughborough town centre. Situated on the first floor and presented in excellent condition. It's well Planned layout combined with its decor make for a bright and warm space. The apartment is within a short walk of the restaurants and cinema of the new Baxtergate development as well as the mainline station (both about 4 minutes by foot), with buses providing access to the surrounding areas.

Living Room 4.9m (16'1) x 3.2m (10'6)

A light and spacious room, neutrally decorated, with a door and large full height window leading to the balcony.

Kitchen 2.4m (7'10) x 2.3m (7'7)

Good quality modern kitchen in cappuccino with dark wood style worktop. Includes fridge-freezer, slim-line dishwasher, washing machine, oven and hob. Smart tiling completes the look.

Master bedroom 4.9m (16'1) x 3.1m (10'2)

A surprisingly generous proportioned and light room, with fitted wardrobes. Like the rest of the house it is presented in excellent condition.

Bathroom 2m (6'7) x 1.8m (5'11)

Modern three piece bathroom suite complete with shower over the bath. High grade tiling completes the look.

Parking

Car park situated to rear with one unallocated space.

Heating

Gas fired central heating with brand new top of the range boiler.

Glazing

Modern, good quality, uPVC double glazing.

Energy Performance

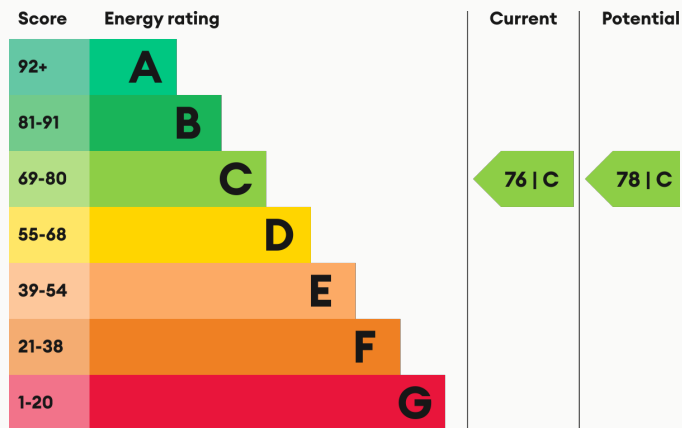

We aim to make our particulars both accurate and reliable. However they are not guaranteed; nor do they form part of an offer or contract. If you require clarification on any points then please contact us, especially if you are traveling some distance to view. All measurements are to widest point.



Kitchen



Bathroom



Bathroom



Bathroom

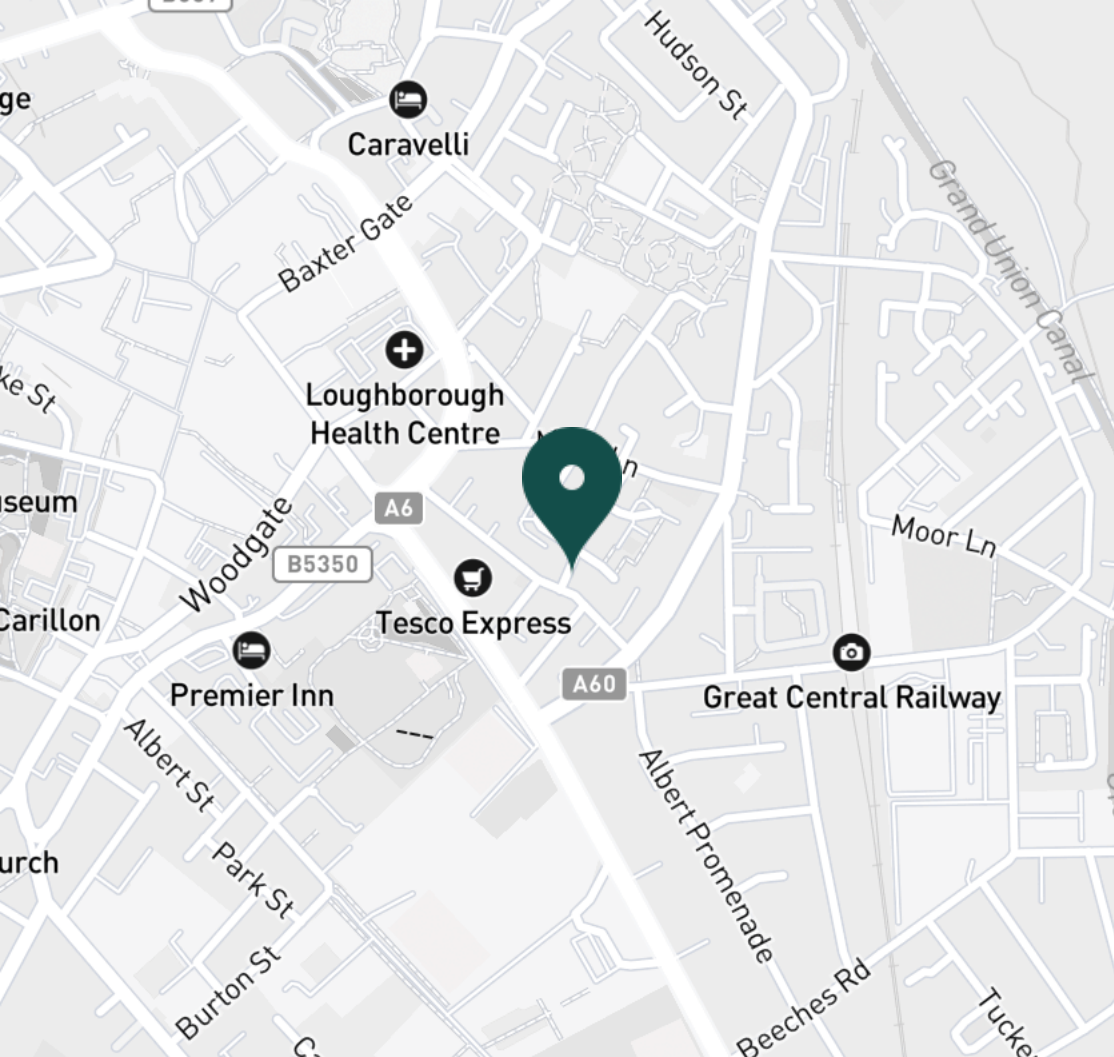

SUPERMARKETS

Marks & Spencer	0.5 mi
Tesco Superstore Loughborough	0.8 mi
Lidl Loughborough	1.1 mi
Sainsburys Loughborough	1.1 mi
Tesco Extra Loughborough	1.3 mi

GYMS

Dynamite Gym Ltd	0.2 mi
NPC Performance Centre	0.4 mi
Fit4Less	0.5 mi
PureGym Loughborough	0.5 mi
Anytime Fitness Loughborough	0.7 mi

TRAIN STATIONS

Loughborough	1.0 mi
Barrow upon Soar	3.4 mi
Sileby	5.2 mi
Syston	9.3 mi
South Wigston	10.5 mi

NURSERY SCHOOLS

Lime Tree Nursery	0.1 mi
Cobden Childrens Centre	0.6 mi
Westwards Nursery	0.6 mi
Emmanuel PS	0.6 mi
Babblebrooke Day Nursery	0.6 mi

PRIMARY SCHOOLS

Fairfield Preparatory Sch	0.2 mi
Cobden PS	0.3 mi
Loughborough Grammar Sch	0.6 mi
Loughborough High Sch	0.6 mi
Our Lady's Convent Sch	0.8 mi

HIGH SCHOOLS

Loughborough Grammar Sch	0.6 mi
Loughborough High Sch	0.6 mi
Limehurst Academy	0.7 mi
Our Lady's Convent Sch	0.8 mi
Loughborough College	1.4 mi

Discover
Loughborough



- ✓ Appliances included
- ✓ Walk to town
- ✓ Parking
- ✓ First floor
- ✓ Balcony
- ✓ Intercom





Living room



Living room



Living room



Balcony



Bedroom



Bedroom



Bedroom



Bedroom



Wardrobe



Hallway



Trinity Street

Available
From 07/06/2025

Comes
Unfurnished

Bedrooms
1

Receptions
1

Bathrooms
1

Parking
Off road

Postcode
LE11 1BY

Rent
£700 pcm

Deposit
£800

EPC
76 | C

Council Tax Band
A

ID
#2535

Updated
21/05/2025

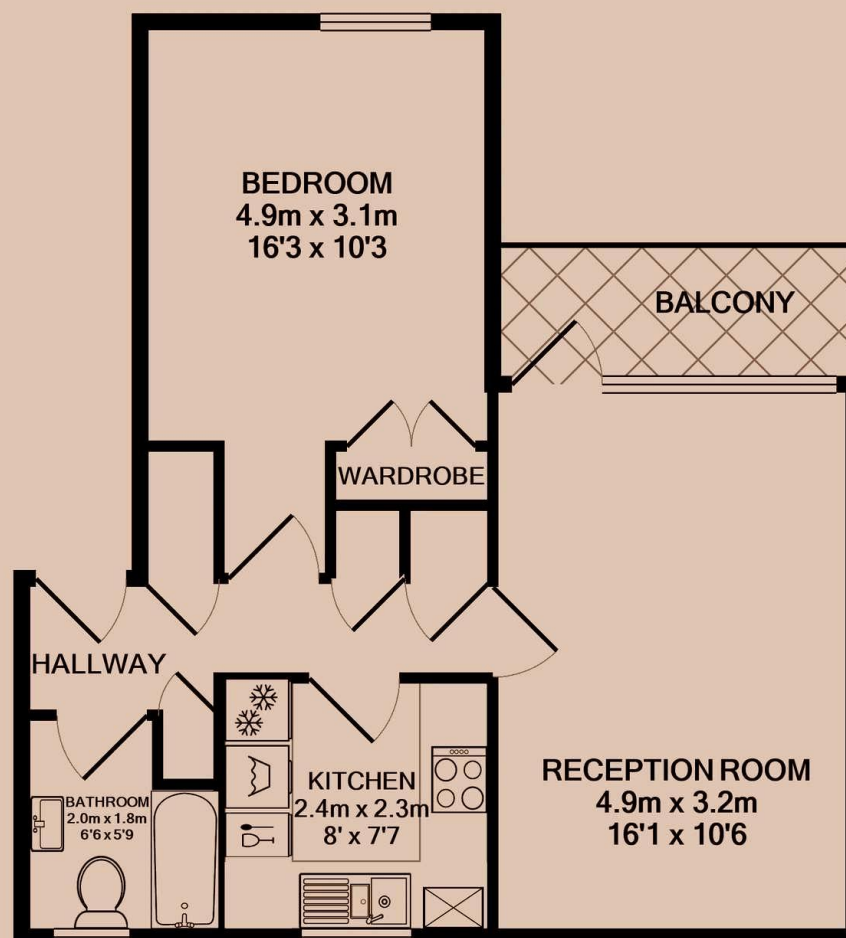

Have a property like this? Let's work together.

Design and marketing are at the heart of our approach. With most people now looking for property online, we can get our clients' properties in front of as many people as the most prominent national agents. Where we differ is in the quality of our work. We create stunning digital particulars that highlight the individual attributes of every property we market, with videos and floor plans as standard.



OUR OFFICE
7 Biggin Street
Loughborough, LE11 1UA

CONTACT US
01509 320 320
let@huntleys.net

