



Osier Fields
East Leake

2 Bed 1st Floor Apartment • LE12 6QG • £800 pcm • £920 Deposit



Osier Fields, East Leake

A contemporary two-bedroom apartment located in this popular development close to East Leake Village center. Located on the first floor it is presented in great condition. It's well-planned layout make for a bright and warm space. The apartment is located in a quiet neighbourhood, with buses providing access to the surrounding areas. Allocated parking for one car is included.

Lounge / Diner 6.88m (22'7) x 3.24m (10'8)

A well proportioned room that is large enough to be used as both lounge and diner. Open plan to the kitchen.

Kitchen 2.64m (8'8) x 2.18m (7'2)

A modern U-shaped kitchen in beech with contrasting worktop. Includes, washing machine, oven, hob and space for a fridge/freezer. Opens to the living room.

Master Bedroom 3.55m (11'8) x 3.48m (11'5)

A generously proportioned and light room with direct access to the room.

Bedroom Two 2.74m (9') x 2.64m (8'8)

This room can easily be used as a double bedroom or study.

Bathroom 2.87m (9'5) x 2.13m (7')

A modern four piece bathroom including a separate. A fitted mirror and smart flooring completes the look.

Parking

Allocated parking bay for one, can be located at the rear of the apartment.

Heating

Gas-fired central heating.

Glazing

Modern, good quality, uPVC double glazing.

Energy Performance

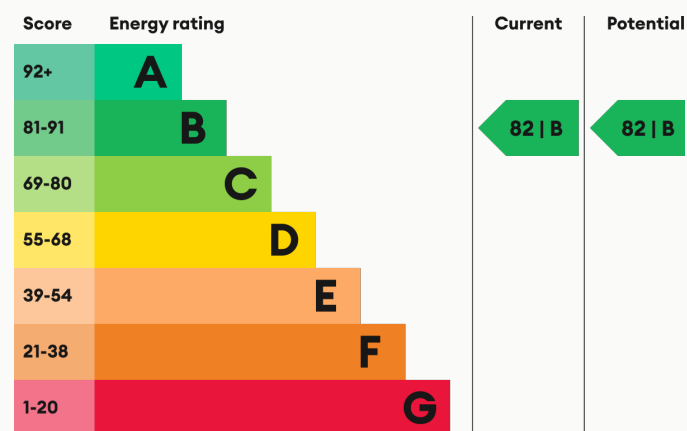

We aim to make our particulars both accurate and reliable. However they are not guaranteed; nor do they form part of an offer or contract. If you require clarification on any points then please contact us, especially if you are traveling some distance to view. All measurements are to widest point.



Lounge / Diner



Lounge / Diner



Lounge / Diner



Lounge / Diner

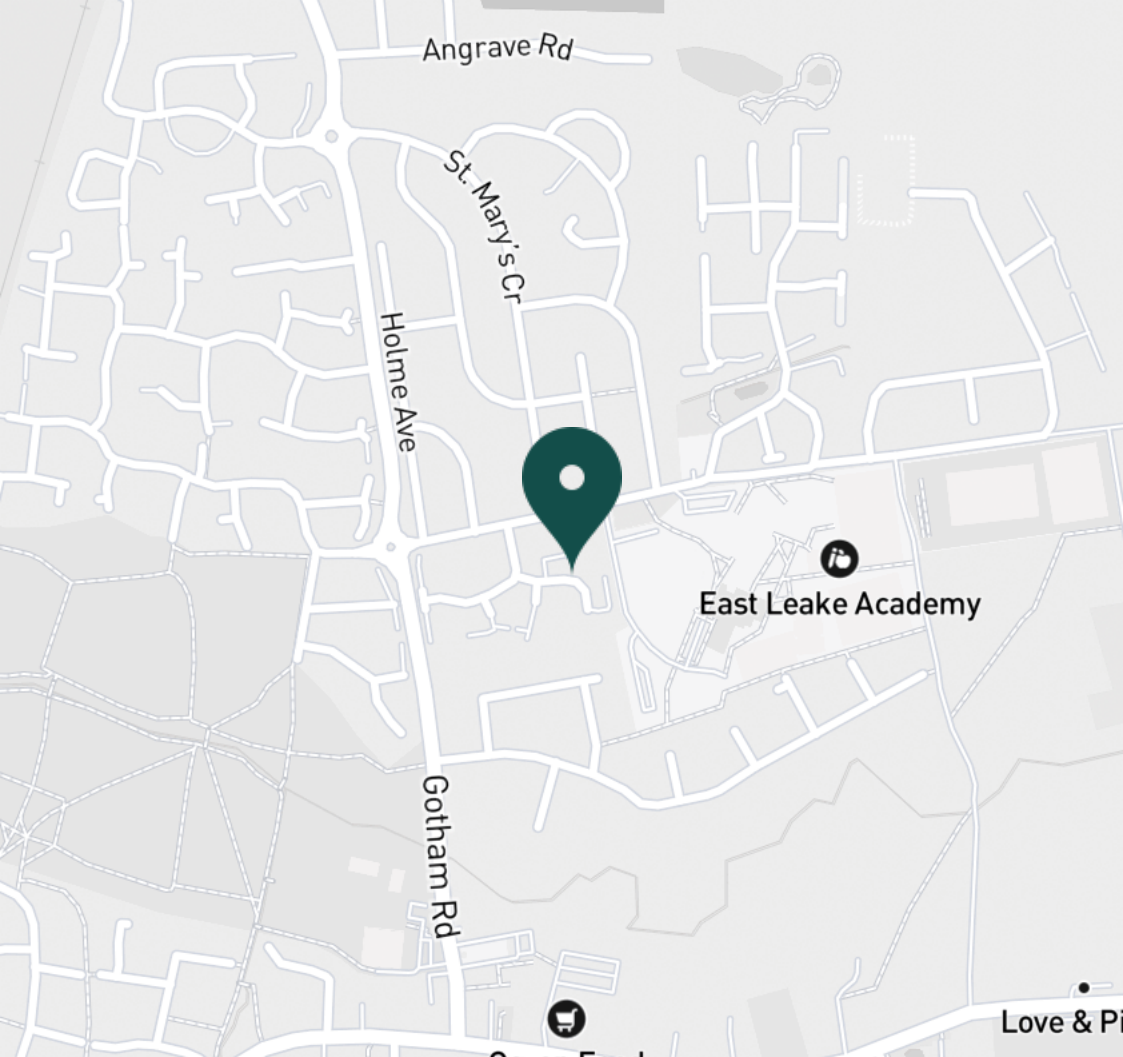

SUPERMARKETS

Co-op Food East Leake	0.5 mi
Aldi Loughborough	5.2 mi
Tesco Superstore Loughborough	5.5 mi
Lidl Loughborough	5.6 mi
Marks & Spencer	5.7 mi

GYMS

CrossFit Loughborough	5.0 mi
PureGym Loughborough	5.3 mi
Viking Fitness Centre	5.4 mi
Anytime Fitness Loughborough	5.4 mi
Dynamite Gym Ltd	5.8 mi

TRAIN STATIONS

Loughborough	5.0 mi
East Midlands Parkway	6.9 mi
Barrow upon Soar	8.3 mi
Sileby	10.2 mi
Nottingham	11.2 mi

NURSERY SCHOOLS

Lantern Lane P and N	0.2 mi
The Honey Bee Day Nursery	0.5 mi
East Leake Day Nursery & PS	1.0 mi
Costock Playgroup	1.5 mi
Babblebrooke Day Nursery	5.3 mi

PRIMARY SCHOOLS

Sutton Bonington PS	4.4 mi
Rendell Primary School	5.1 mi
Wymeswold CE PS	5.4 mi
Kegworth Primary School	5.8 mi
Cobden PS	5.9 mi

HIGH SCHOOLS

East Leake Academy	0.1 mi
Limehurst Academy	5.2 mi
RNIB College Loughborough	6.1 mi
Loughborough Grammar Sch	6.3 mi
Our Lady's Convent Sch	6.3 mi

Discover
East Leake

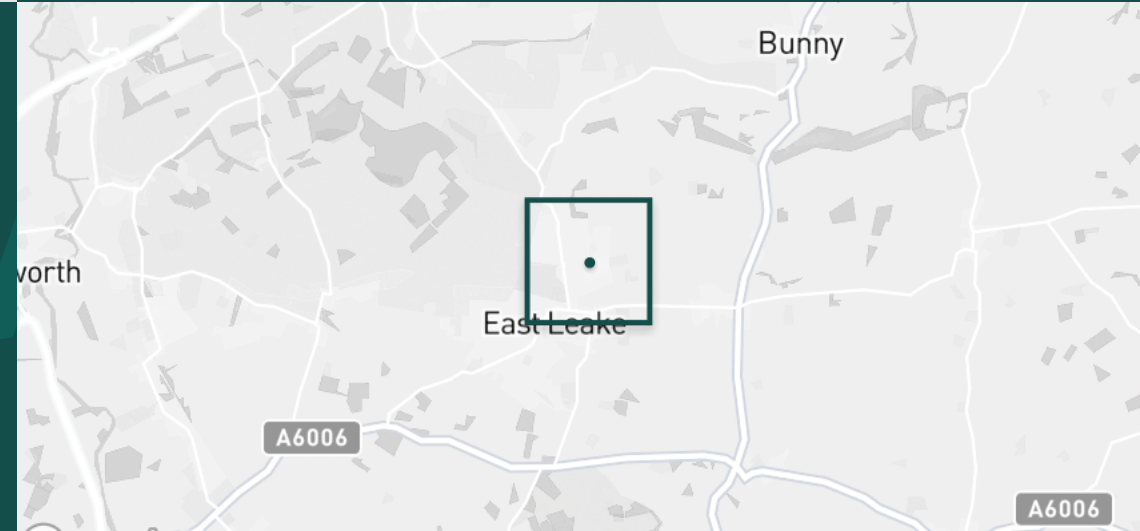

- ✓ First Floor
- ✓ Village location
- ✓ Two double bedrooms
- ✓ Four-piece bathroom
- ✓ Allocated parking
- ✓ Quiet area





Kitchen



Kitchen



Kitchen



Master Bedroom



Master Bedroom



Master Bedroom



Master Bedroom



Bedroom Two



Bedroom Two



Bedroom Two



Bathroom



Bathroom



Bathroom



Hallway



Osier Fields Car Park

Available
From 01/08/2024

Comes
Unfurnished

Bedrooms
2

Receptions
1

Bathrooms
1

Parking
Allocated

Postcode
LE12 6QG

Rent
£800 pcm

Deposit
£920

EPC
82 | B

Council Tax Band
B

ID
#8124

Updated
12/07/2024

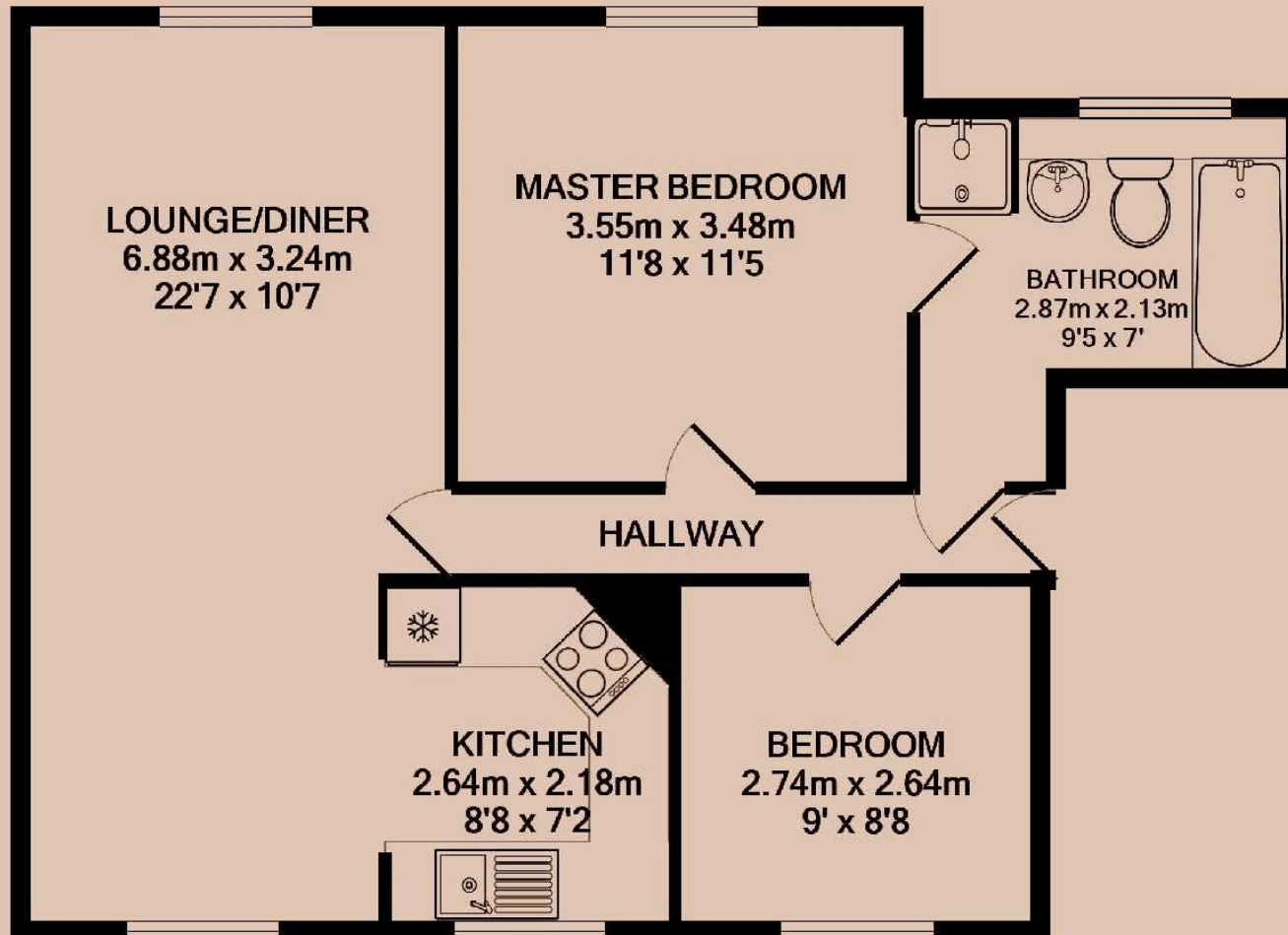

Have a property like this? Let's work together.

Design and marketing are at the heart of our approach. With most people now looking for property online, we can get our clients' properties in front of as many people as the most prominent national agents. Where we differ is in the quality of our work. We create stunning digital particulars that highlight the individual attributes of every property we market, with videos and floor plans as standard.



OUR OFFICE
7 Biggin Street
Loughborough, LE11 1UA

CONTACT US
01509 320 320
let@huntleys.net

