

A photograph of a living room. On the left, there is a red leather sofa with an orange patterned cushion. Behind it is a tall wooden bookshelf filled with books. A window with patterned curtains is in the center. A black leather ottoman sits on a rug with a red and grey circular pattern. In the background, there is a television on a wooden stand, a radiator, and several framed pictures on the wall. To the right, there are two wooden chairs with light-colored seats, a small wooden table, and a large mirror on the wall. A black jacket is draped over a chair in the foreground on the right.

Melton Road
Barrow-Upon-Soar

1 Bed Ground Floor Apartment • LE12 8NS • £650 pcm • £750 Deposit



Melton Road, Barrow-Upon-Soar

Presented in great condition, a one bedroom, unfurnished, ground-floor apartment set within the sought after village of Barrow-Upon-Soar. This property includes a lounge/diner, bedroom, kitchen and family bathroom. Set back from Melton Road, is allocated parking for this apartment. Soon available to let.

Lounge / Diner

A sizeable living room, easily used as both lounge and diner. This room overlooks Melton Road.

Kitchen

A practical L-shaped kitchen, including an integrated fridge/freezer, oven and hob.

Bedroom

A double bedroom including a built-in wardrobe, overlooking the block car park.

Bathroom

A bright three-piece bathroom, including a bath, sink, toilet and shower above the bath.

Parking

An allocated space included for one car, with further visitor parking spaces within the same car park.

Heating

Electric heaters throughout.

Glazing

Modern, good quality, uPVC double glazing.

Energy Performance

TBC

We aim to make our particulars both accurate and reliable. However they are not guaranteed; nor do they form part of an offer or contract. If you require clarification on any points then please contact us, especially if you are traveling some distance to view. All measurements are to widest point.



Lounge / Diner



Lounge / Diner



Kitchen



Kitchen

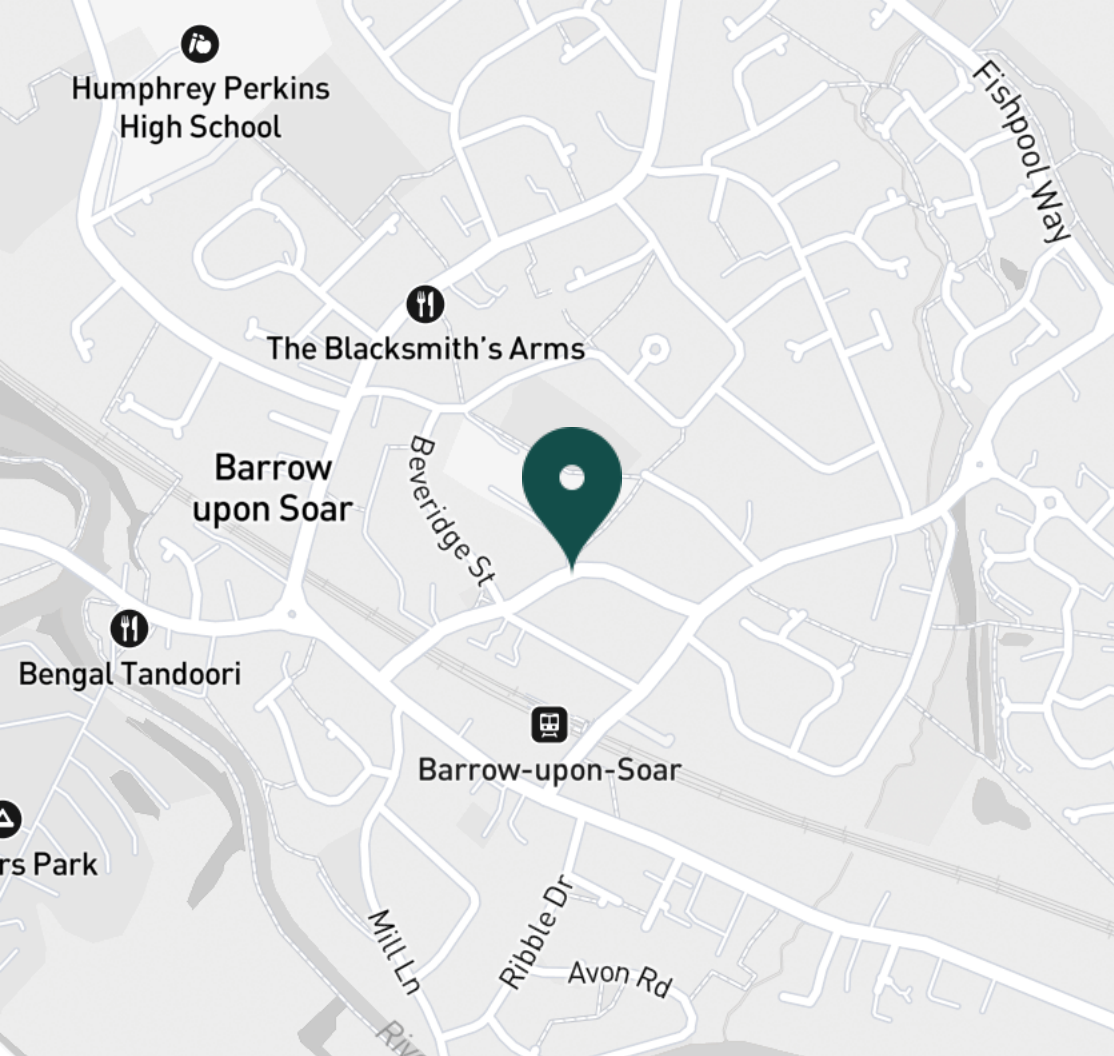

SUPERMARKETS

Co-op Food Barrow Upon Soar	0.6 mi
Co-op Food Quorn	2.3 mi
Waitrose Mountsorrel	2.6 mi
Tesco Extra Loughborough	3.5 mi
Marks & Spencer	4.1 mi

GYMS

Physfit Gyms	2.1 mi
Total Fitness Centre	2.3 mi
Rosemary Conley Fitness Club	2.7 mi
Onestep fitness	3.0 mi
bofitness	3.2 mi

TRAIN STATIONS

Barrow upon Soar	0.2 mi
Sileby	2.3 mi
Loughborough	4.0 mi
Syston	8.4 mi
South Wigston	8.6 mi

NURSERY SCHOOLS

Sileby Littlestars PS	2.3 mi
Peter Pan Playgroup	2.3 mi
Quorn Nursery School	2.4 mi
Radmoor Nursery	2.4 mi
Radmoor Nursery	2.4 mi

PRIMARY SCHOOLS

Hall Orchard CE PS	0.0 mi
St Bartholomew's CE PS	2.4 mi
Redlands Community PS	2.4 mi
Burton-on-the-Wolds PS	2.8 mi
Christ Church & St Peters CE	2.9 mi

HIGH SCHOOLS

Humphrey Perkins High Sch	0.8 mi
Rawlins Academy	2.3 mi
Loughborough Grammar Sch	3.6 mi
Loughborough High Sch	3.6 mi
Our Lady's Convent Sch	3.8 mi

Discover
Barrow-Upon-Soar

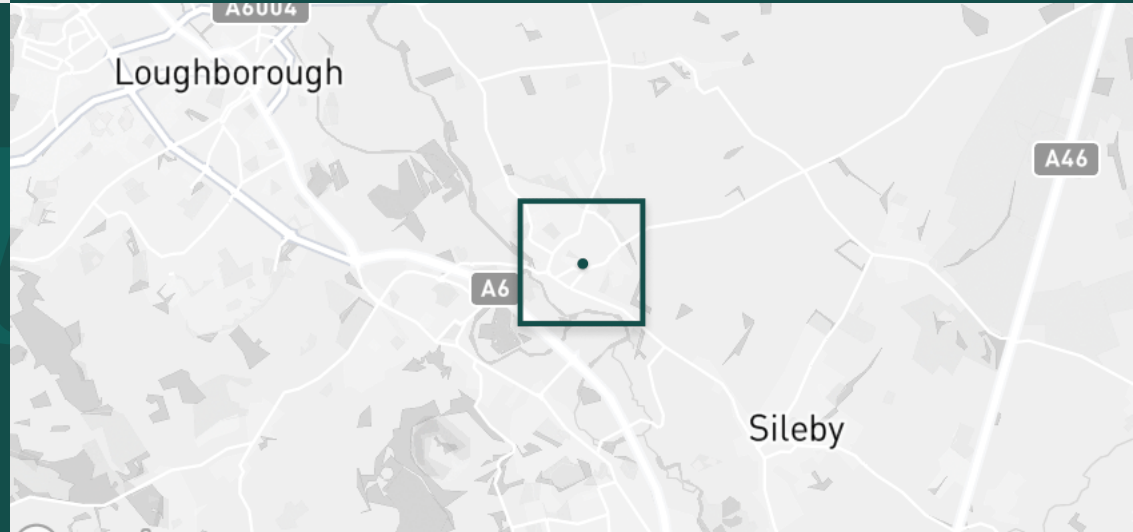

- ✓ One-Bed Apartment
- ✓ Ground Floor
- ✓ Allocated Parking
- ✓ Unfurnished
- ✓ Available Soon
- ✓ Barrow-Upon-Soar

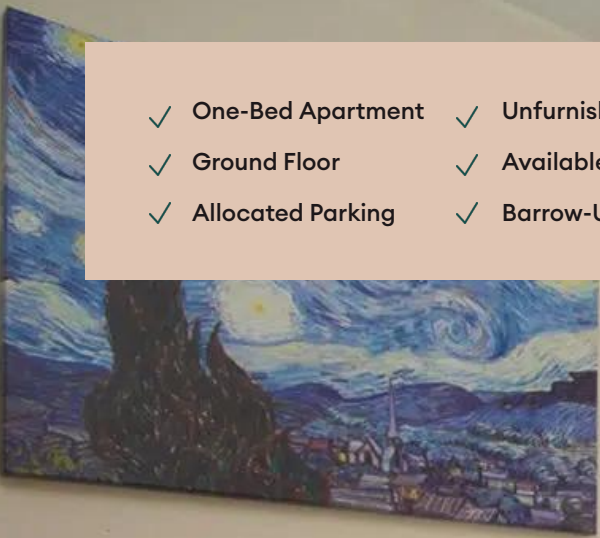



Bedroom



Bedroom



Bathroom



Bathroom



Hallway



Apartment Entrance



Car Park



Block Entrance

Available
From 24/05/2024

Comes
Unfurnished

Bedrooms
1

Receptions
1

Bathrooms
1

Parking
Ask Agent

Postcode
LE12 8NS

Rent
£650 pcm

Deposit
£750

EPC
Ordered

Council Tax Band
B

ID
#13464

Updated
07/05/2024

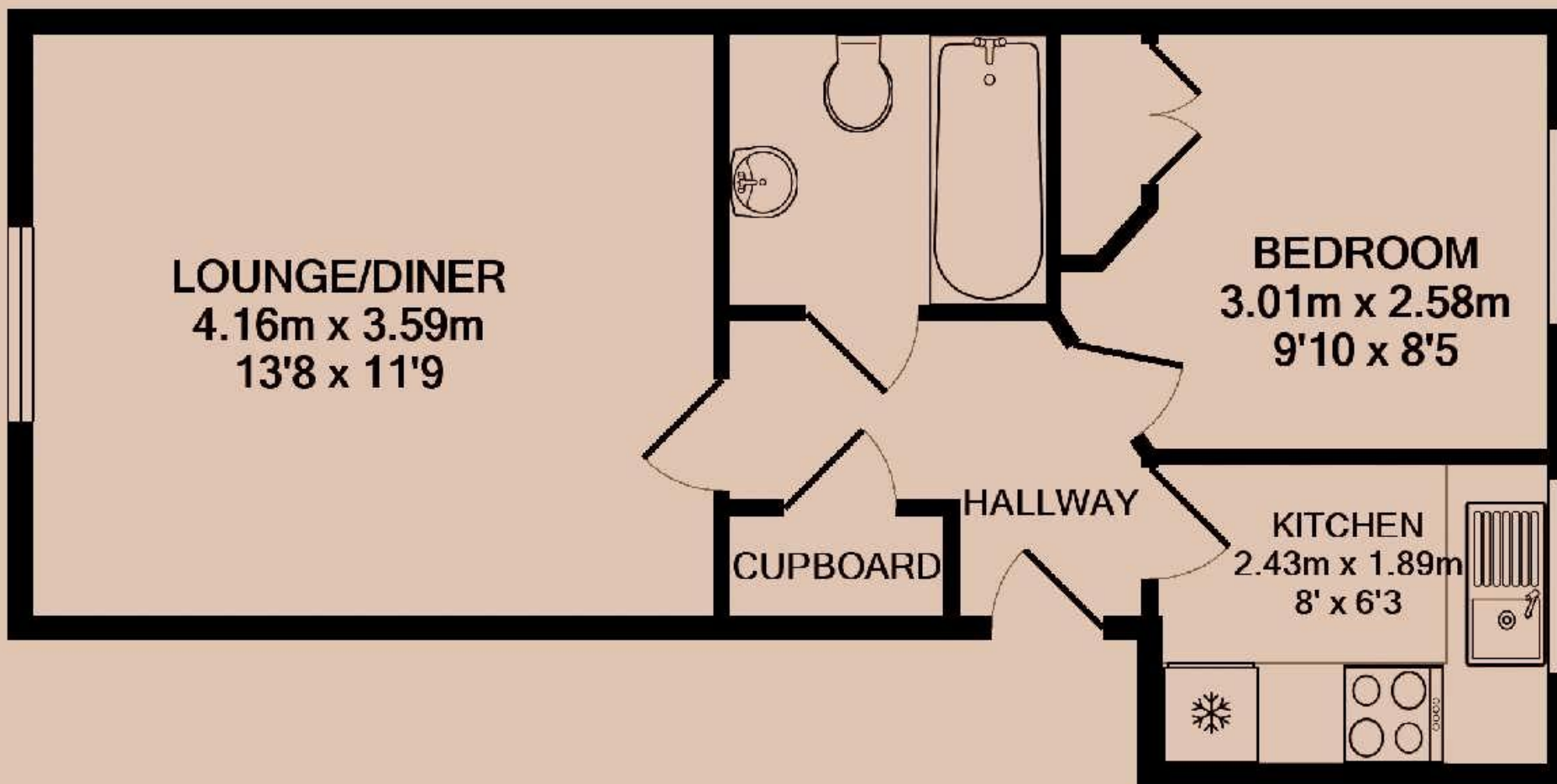

Have a property like this? Let's work together.

Design and marketing are at the heart of our approach. With most people now looking for property online, we can get our clients' properties in front of as many people as the most prominent national agents. Where we differ is in the quality of our work. We create stunning digital particulars that highlight the individual attributes of every property we market, with videos and floor plans as standard.



OUR OFFICE
7 Biggin Street
Loughborough, LE11 1UA

CONTACT US
01509 320 320
let@huntleys.net



Huntleys

