



Flat 2 6 St. Stephens Road, Cheltenham, GL51 3AA

£625 Per month

TO LET



- Studio Flat
- Close to Station
- Shared Courtyard
- On Street Parking
- Council Tax Band - A
- Furnished
- Electric Heating
- Appliances Included
- Good location
- EPC Rating - E

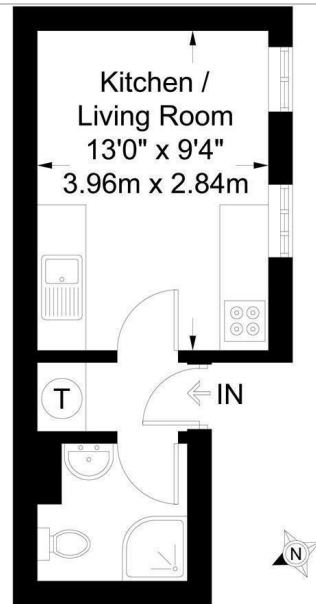

Approximate Gross Internal Area = 179 sq ft / 16.6 sq m
 Illustration for identification purposes only, measurements are approximate and are not to scale.
 Please check all details before making any decisions reliant upon them.
 Copyright Reed Maurice. (0200138)

Directions

THE PROPERTY

A furnished, self contained studio apartment located in Tivoli within a short walk of the Cheltenham Spa station and the Town Centre.

The studio is located on the lower ground floor of a period building and comprises of a bed-sitting room with sofa bed and storage cupboard, kitchenette with hob, oven, fridge & washer dryer and a modern shower room with electric shower. The property is warmed by electric heating.

Externally there is a shared courtyard garden. Street parking is available to the front and rear.

THIS PROPERTY IS SUITABLE FOR ONE PERSON ONLY.

SITUATION