



Flat 3, Chelholm 46 Lansdown Road, Cheltenham, GL51 6PU

£1,695 Per month

TO LET



- Two Bedrooms & Study
- Top Floor Apartment
- Allocated Off Road Parking
- Gas Central Heating
- Council Tax Band - D
- Part Furnished
- Spacious Open Plan Living
- Communal Gardens
- Lift Access
- EPC Rating - C

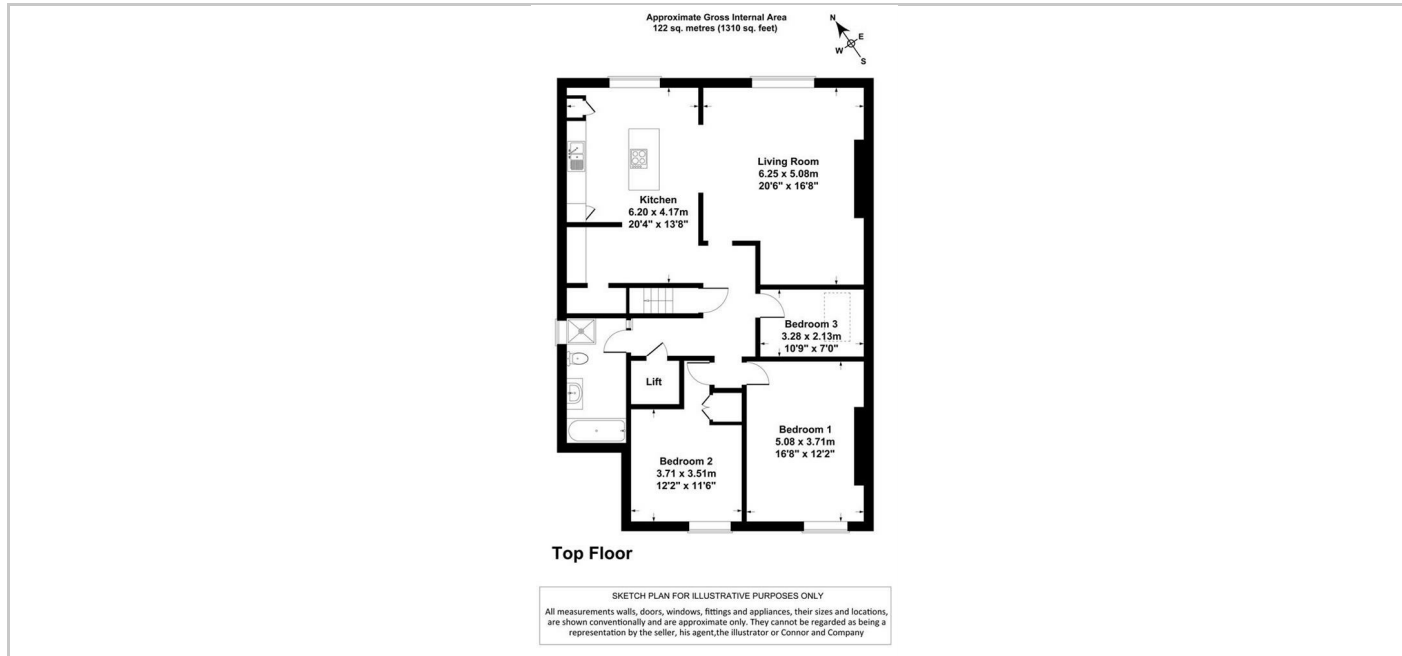

THE PROPERTY

A superb, two bedroom apartment occupying the entire top floor of this magnificent period property on Lansdown Road, within easy reach of the Town Centre in one direction and the railway station in the other.

The property is presented in good order and offers very spacious open plan living accommodation and is partially furnished. The property is accessed via private lift access or stairs to the side of the building Briefly comprising of a large entrance hallway, very generous sitting room with rooftop views, spacious kitchen / dining room with breakfast bar and integrated appliances, study / dressing room, two large double bedrooms and a bathroom with shower and bath. The property is warmed by gas central heating throughout.

Externally the building has communal gardens and allocated off road parking for one car.

SITUATION

Directions