



15 Sarah Siddons Walk, Cheltenham, GL50 2LW

£1,950 Per month

TO LET



- Three / Four Bedrooms
- Three Bathrooms
- Quiet Location
- Conservatory
- Council Tax - Band E
- Unfurnished
- Garage & Off Road Parking
- Close to Central Cheltenham
- Private Courtyard & Communal Gardens
- EPC Rating - C

THE PROPERTY

A recently redecorated, three / four bedroom unfurnished Town House situated on The Park, within short walking distance of Bath Road, The Suffolks, Tivoli and Montpellier.

The property benefits externally from off road parking, integral garage and a patio garden with access into a communal garden beyond.

Internally the property is very well presented and has been recently redecorated and carpeted throughout. The house is arranged over three floors with the ground floor comprising of an entrance hallway with built in storage, access to the integral garage, utility room, reception room which could also be a fourth double bedroom, conservatory and shower room. The first floor has a modern kitchen breakfast room with hob, oven, dishwasher and fridge freezer all integrated and space for a dining table plus a large I-shaped living / dining room. The top floor has a master bedroom with built in storage and en suite shower room, second double bedroom, third large single bedroom room with storage and a family bathroom.

The property is warmed by gas central heating throughout.

SITUATION

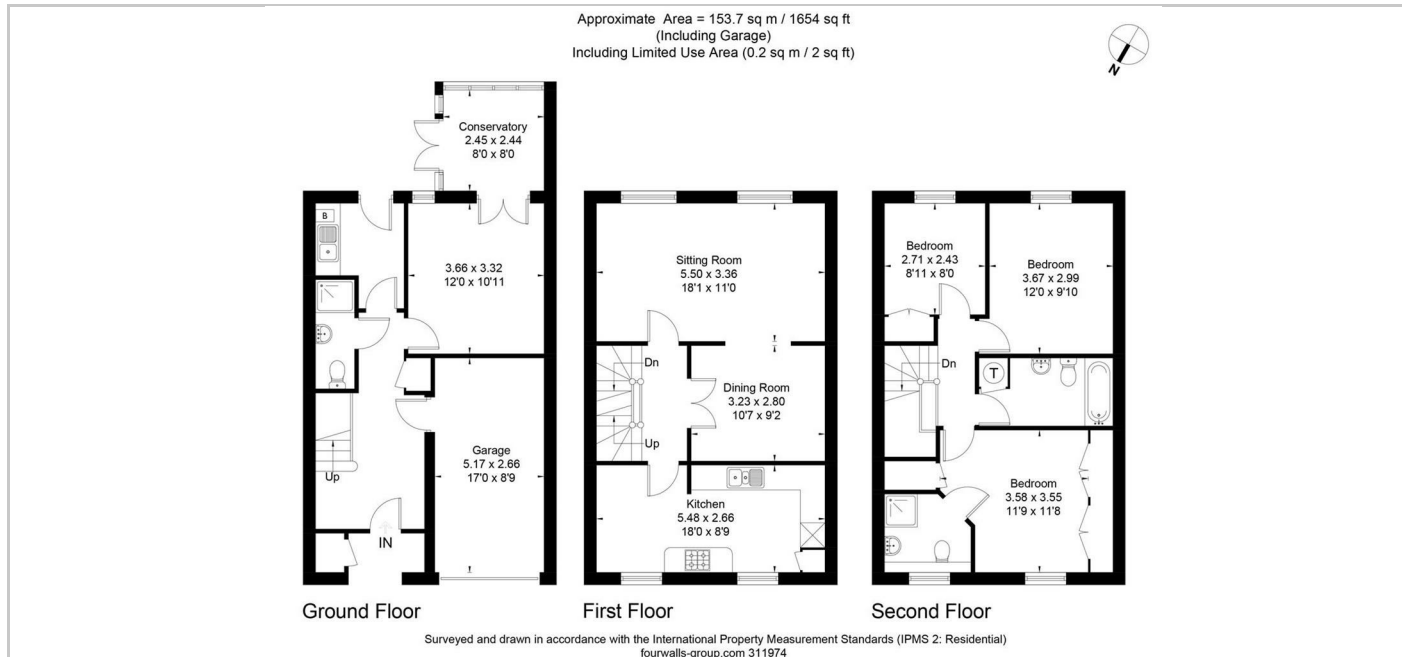

Directions