

Frinton Office
 88 Connaught Avenue
 Frinton-on-Sea
 Essex CO13 9PT
 Tel: (01255) 677688

Harwich Office
 147 High Street
 Harwich
 Essex CO12 3AX
 Tel: (01255) 506655

GROUND FLOOR

1ST FLOOR

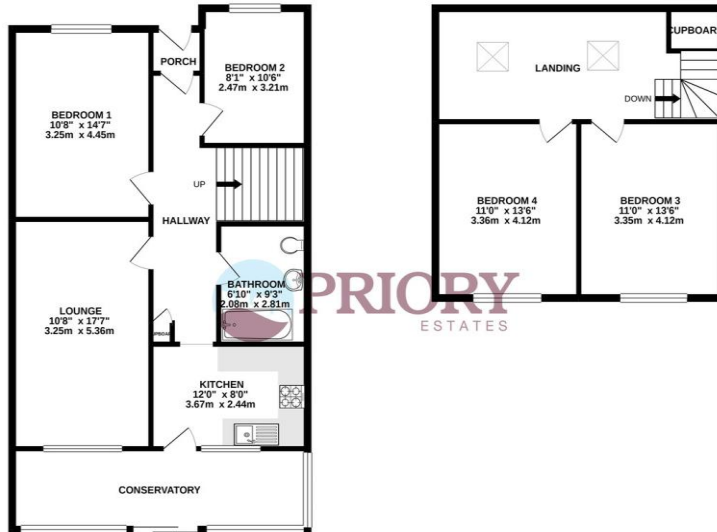

Field Walk

Rent: £1,450 pcm

Walton On The Naze

Energy Efficiency Rating D

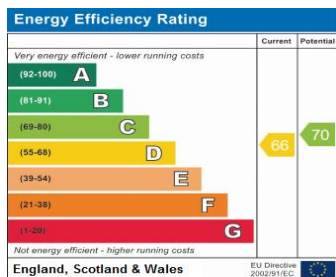

Council Tax Band

Council Tax Band C

LOCAL AUTHORITY

Tendring District Council

OFFICE
 88 Connaught Avenue
 Frinton-On-Sea
 Essex
 CO13 9PT

T: 01255 677688
E: admin@prioryestates.co.uk
W: www.prioryestates.co.uk
Whatsapp: 07972573258

Agents Note: Whilst every care has been taken to prepare these particulars, they are for guidance purposes only. All measurements are approximate, are for general guidance purposes only and whilst every care has been taken to ensure their accuracy they should not be relied upon and potential tenant are advised to recheck the measurements.





Property Description

Priory Estates are pleased to present this versatile four bedroom semi detached chalet bungalow located in Frinton Homelands. Close to local amenities and just a short distance from Frinton Railway Station, this property also offers modern décor throughout, spacious bedrooms, conservatory and off road parking. Available from the start of July on an unfurnished basis.



Accommodation

Entrance Hall
Lounge (5.39m x 3.29m)
Kitchen (3.65m x 2.43m)
Conservatory (6.49m x 1.88m)
Bathroom
Bedroom One (4.38m x 3.29m)
Bedroom Two (3.23m x 2.49m)
First Floor Landing/Playroom
Bedroom Three (4.14m x 3.35m)
Bedroom Four (4.14m x 3.35m)

Features

Gas Central Heating
Double Glazing
New Modern Kitchen
Versatile Accommodation
On Road Parking
Close to Local Amenities



Financial Requirements

A minimum of one month's rent, plus a deposit of £1,670 is required in deared funds prior to the commencement of the tenancy.

Term

A minimum of 6 months under an Assured Shorthold Tenancy Agreement, with an extension to the contract should both parties agree.

Restrictions

Certain Restrictions have been placed on this property, please ask for details.