

Frinton Office
 88 Connaught Avenue
 Frinton-on-Sea
 Essex CO13 9PT
 Tel: (01255) 677688

Harwich Office
 147 High Street
 Harwich
 Essex CO12 3AX
 Tel: (01255) 506655

Approximate Gross Internal Area
 829 sq ft - 77 sq m

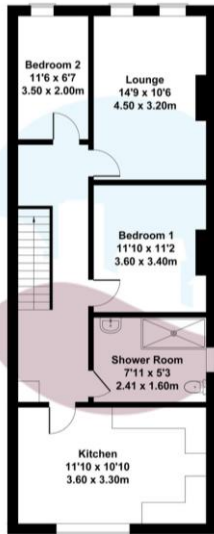

FIRST FLOOR

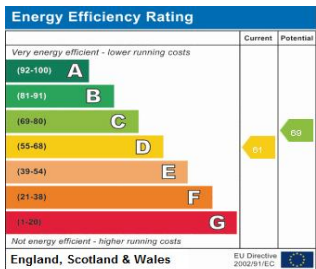

Council Tax Band
 Council Tax Band A

LOCAL AUTHORITY
 Tendring District Council

OFFICE
 88 Connaught Avenue
 Frinton-On-Sea
 Essex
 CO13 9PT

T: 01255 677688
E: admin@prioryestates.co.uk
W: www.prioryestates.co.uk

Agents Note: Whilst every care has been taken to prepare these particulars, they are for guidance purposes only. All measurements are approximate, are for general guidance purposes only and whilst every care has been taken to ensure their accuracy they should not be relied upon and potential tenants are advised to recheck the measurements.



Frinton Road

Kirby Cross, Frinton-on-Sea

Rent: £850 pcm

Energy Efficiency Rating D





Accommodation

Entrance Hallway
Lounge (4.5m x 3.2m)
Kitchen (3.6m x 3.3m)
Bedroom One (3.5m x 2m)
Bedroom Two (3.6m x 3.4m)
Shower Room

Features

Central Location
Close to Local Amenities & Transport Links
Gas Central Heating
Double Glazing
Private Access
Shower Room



Property Description

Situated within the popular village of Kirby Cross, is this spacious two bedroom first floor flat. Conveniently located close to the railway station with links to Colchester and London Liverpool Street and Connaught Avenue, which holds ample amenities. This property also benefits from private access, gas central heating and double glazing. Available from the middle of March on an unfurnished basis.

Please note these photos are from a previous listing



Financial Requirements

A minimum of one month's rent, plus a deposit of £980 is required in cleared funds prior to the commencement of the tenancy.

Term

A minimum of 6 months under an Assured Shorthold Tenancy Agreement, with an extension to the contract should both parties agree.

Restrictions

Certain Restrictions have been placed on this property, please ask for details.