



3213 Imperial Drive, Harrow, HA2 7DP  
£1,400



3213 Imperial Drive, Harrow, HA2 7DP

£1,400

Newly Refurbished. Flagstones are delighted to present this modern 1 bedroom, 1 bathroom apartment.

Located in North West London. Minutes away is Rayners Lane Train Station, making it a short journey to Wembley Stadium, Hammersmith & Central London.

This flat location has a vast choice of shops and restaurants and comprises two large shopping centres nearby.

There's a wealth of Character and History within reach, including the picturesque Harrow on the Hill, St Marys Church, Battle of Britain Bunker and Bentley Priory Museum.

1/5th of the borough is collected of parkland and open spaces including Roxbourne park and Northwick park.

Furniture includes : Double Bed with mattress, Sofa, Wardrobe, Bedside unit, Washing machine, Dishwasher, Blinds. Photos are for illustration purposes only.

**Description**



**Situation**



Furnished  
Council Tax Band:  
Available:

## Floor Plans

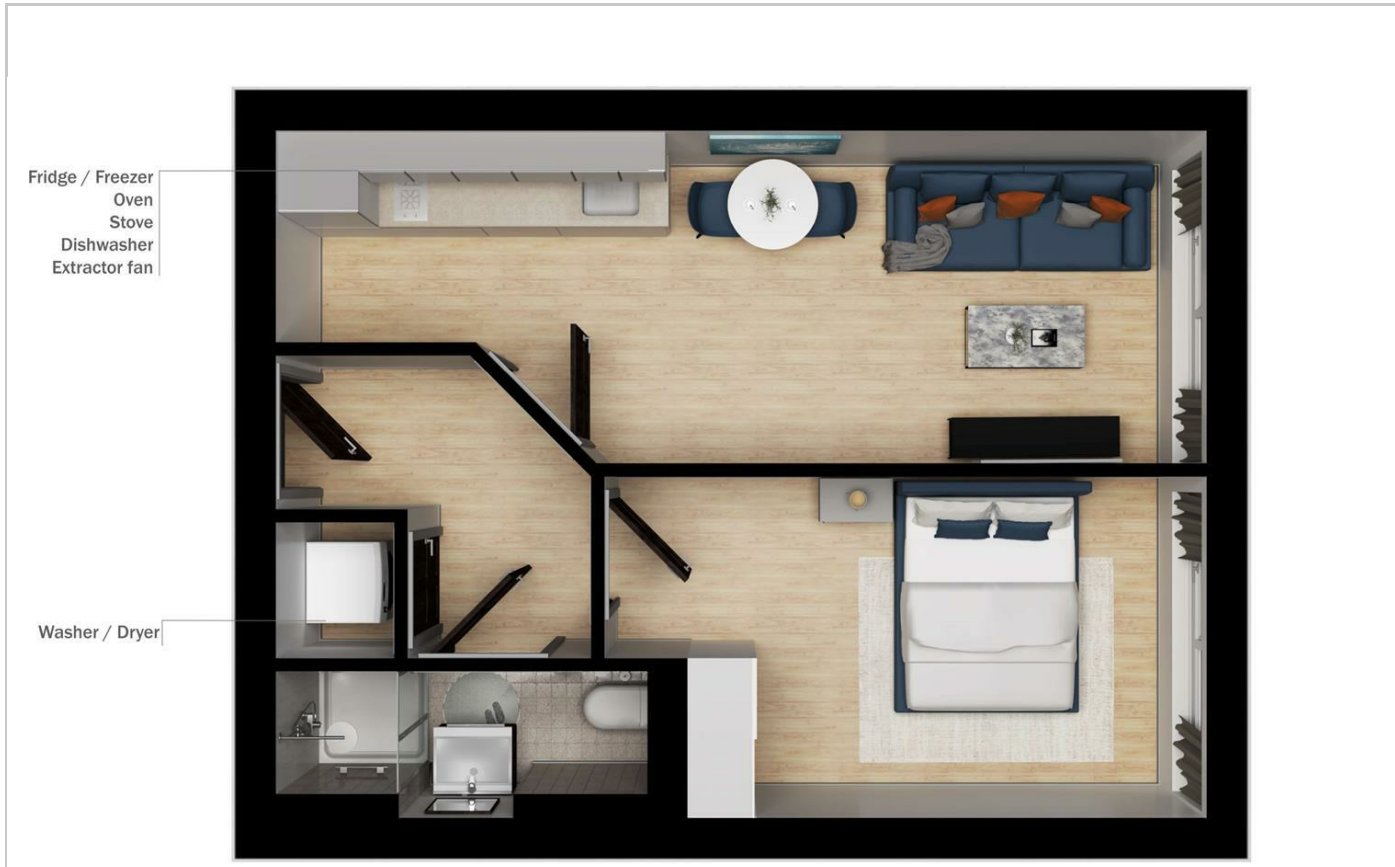

**Imperial Drive**  
- Harrow

**Approx. total area**  
34.44 m<sup>2</sup>  
370.69 ft<sup>2</sup>  
(excluding balconies and terraces)

**Property Type** - Flat  
**Bedrooms** - x1  
**Bathrooms** - x1



## Area Map

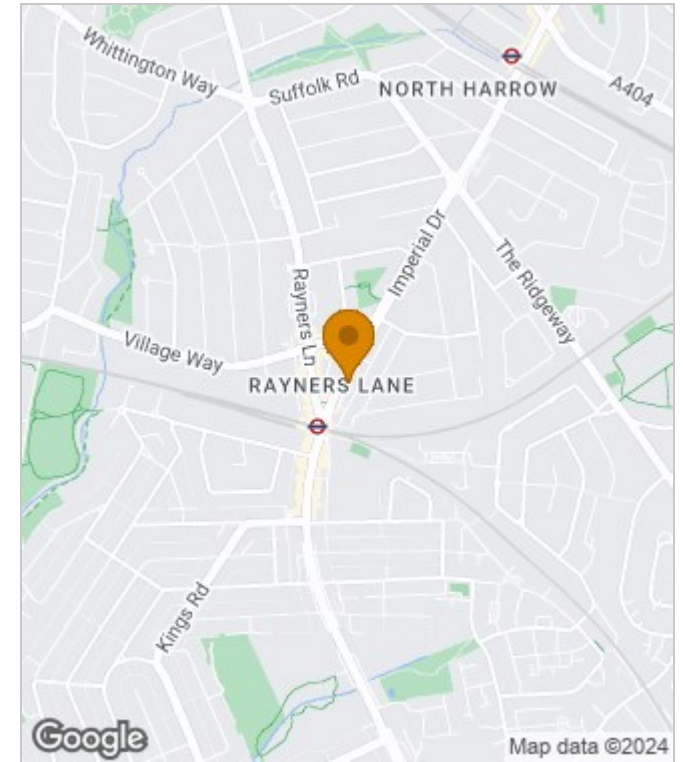

## Energy Performance Graph

Energy Efficiency Rating		Current	Potential
Very energy efficient - lower running costs			
(92 plus) <b>A</b>			
(81-91) <b>B</b>			
(69-80) <b>C</b>			
(55-68) <b>D</b>			
(39-54) <b>E</b>			
(21-38) <b>F</b>			
(1-20) <b>G</b>			
Not energy efficient - higher running costs			
<b>England &amp; Wales</b>	EU Directive 2002/91/EC		

These particulars, whilst believed to be accurate are set out as a general outline only for guidance and do not constitute any part of an offer or contract. Intending purchasers should not rely on them as statements of representation of fact, but must satisfy themselves by inspection or otherwise as to their accuracy. No person in this firm's employment has the authority to make or give any representation or warranty in respect of the property.