

59 Beale Close, London, N13 6DF  
£300,000



59 Beale Close, London, N13 6DF

£300,000

Flagstones presents this inviting two-bedroom apartment on the first floor which boasts a spacious layout with a generously sized living room, perfect for both relaxation and entertaining guests. The residence features laminate flooring throughout, providing a sleek and modern aesthetic. With two well-appointed bedrooms, this apartment offers comfortable living spaces.

Additionally, ample storage options are seamlessly integrated into the design, ensuring a clutter-free and organized living experience. This residence combines practicality with style, making it an ideal choice for those seeking a comfortable and contemporary home.

**Description**



**Situation**



null  
Council Tax Band:  
Available:

# Floor Plans

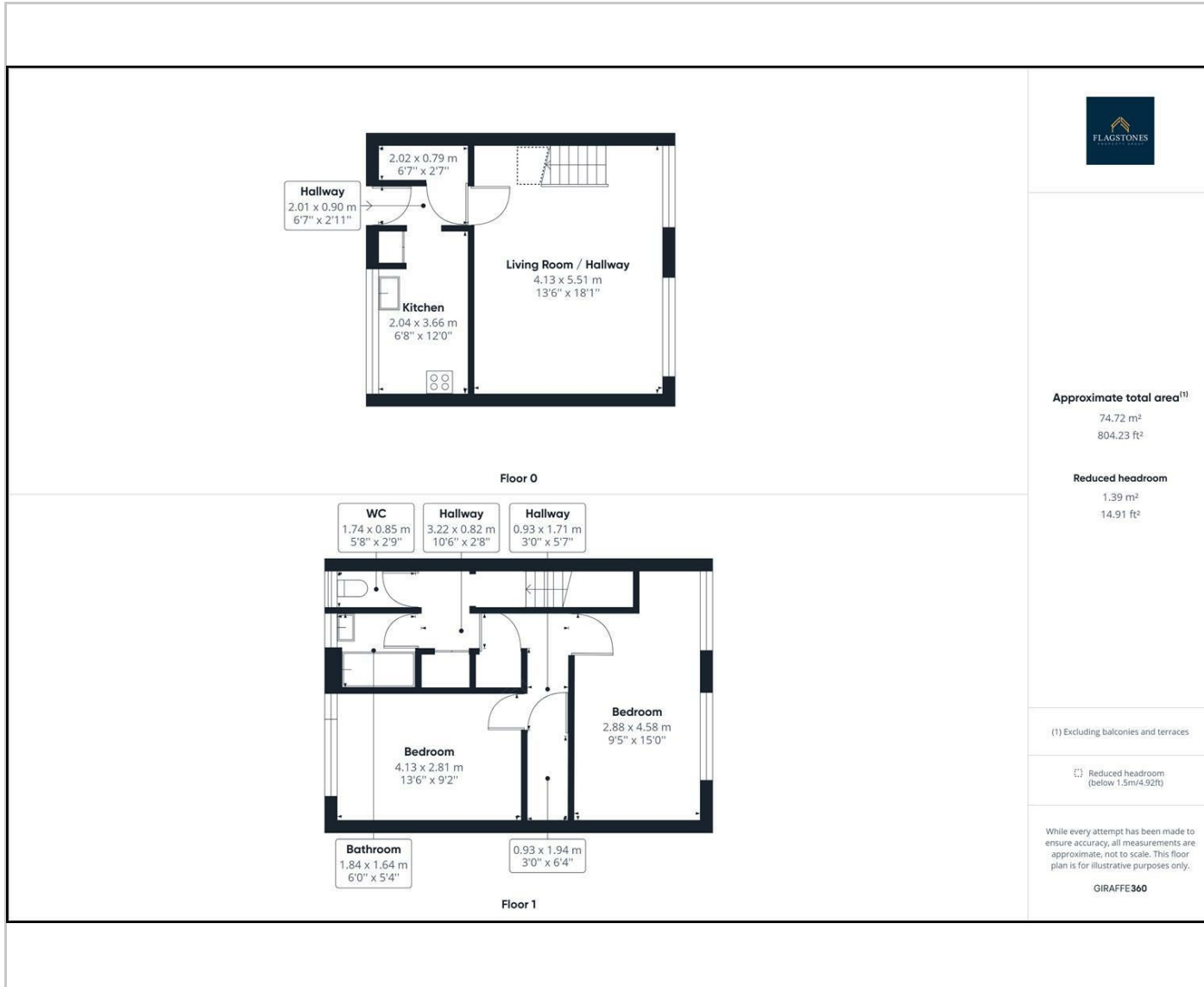

# Area Map

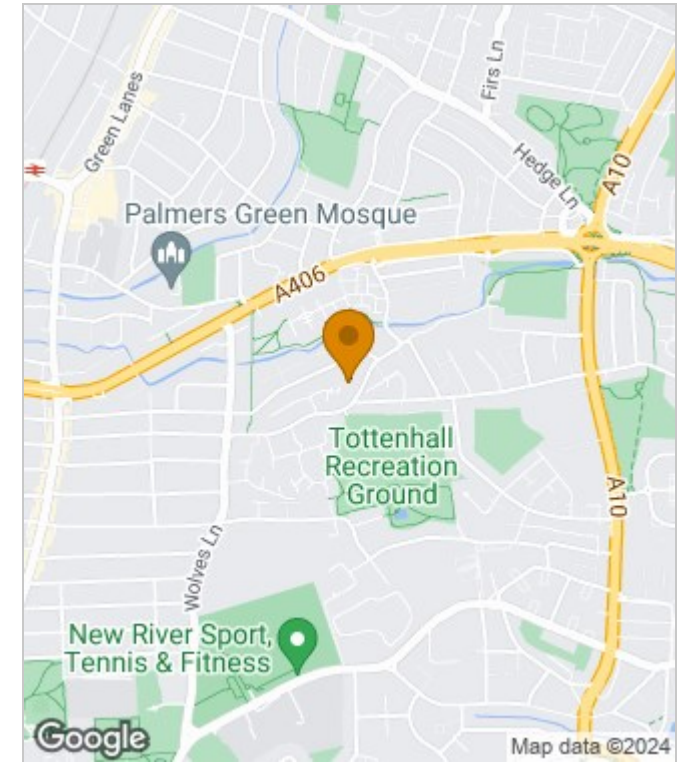

# Energy Performance Graph

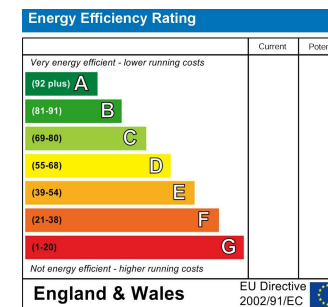

These particulars, whilst believed to be accurate are set out as a general outline only for guidance and do not constitute any part of an offer or contract. Intending purchasers should not rely on them as statements of representation of fact, but must satisfy themselves by inspection or otherwise as to their accuracy. No person in this firm's employment has the authority to make or give any representation or warranty in respect of the property.