



Wellington Paddocks

DEAL, KENT

A beautiful collection of two, three, four and five bedroom homes nestled in the historical town of Deal, Kent.

Taylor
Wimpey

Contents

→ **Welcome to Wellington Paddocks**



→ **Personalise your home**

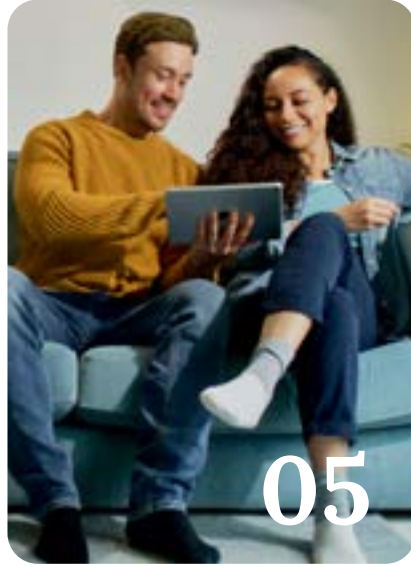

→ **Our homes**



→ **Ways to buy**



→ **Take your next step**



Welcome to Wellington Paddocks

Situated in Walmer, on the outskirts of Deal, Wellington Paddocks is a small community that provides the ideal balance of coastal and town living.

This beautiful collection of homes has been carefully designed to enhance energy efficiency, accommodate modern living and are positioned to compliment the developments green open spaces.



[→ View the site plan](#)

Love coastal life



A beautiful area to put down roots, Walmer is perfectly placed to cater to a variety of lifestyles. Wellington Paddocks offers a peaceful coastal escape while benefiting from its neighbouring large towns and cities.

Boasting a wide variety of everyday amenities, including schools, excellent transport links, shops and restaurants, Walmer is a fantastic location for a range of buyers.

Beach huts in Deal



Local church



Local amenities

[→ Watch development video](#)



Personalise your home

A new Taylor Wimpey home is a blank canvas, ready for you to put your stamp on even before you move in. You can choose from a range of high quality options for your kitchen, bedroom and bathroom to suit your taste – and all from the comfort of your sofa. We offer dark and light kitchen units and patterned or plain tiles for your bathroom, so whatever your preferred style we've got you covered.

Using our innovative Options Online tool, you can visualise your new home room-by-room and customise each as you go. You can also choose your options with the help of your Sales Executive if you'd prefer.

Our customers have created some fantastic spaces in their homes and you can get inspiration from their choices by following us on Instagram. You can also check out a host of interior design tips on our website.

[→ Find out more](#)



Options availability is subject to build stage of plots and options won't be available if plots have reached a certain build stage. Please contact the Sales Executive for further information.

Our homes

→ 2 bedroom homes



→ 3 bedroom homes



→ 4 bedroom homes



→ 5 bedroom homes

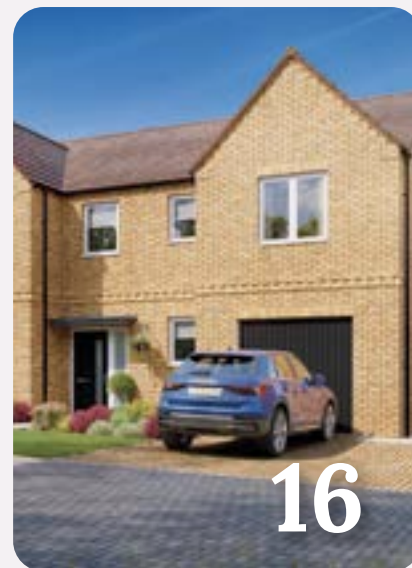

→ [View the site plan](#)



The Beaford

2 BEDROOM HOME, TOTAL 777 sq ft / 72.20m²



GROUND FLOOR

Kitchen/Dining/Living Area max.
6.72m × 4.06m 22'0" × 13'4"



FIRST FLOOR

Bedroom 1 max.
4.06m × 3.78m 13'4" × 12'5"

Bedroom 2 max.
4.06m × 2.69m 13'4" × 8'10"

[→ View development](#)

[→ View our current availability](#)

The floor plans depict a typical layout of this house type. For exact plot specification, details of external and internal finishes, dimensions and floor plan differences consult your Sales Executive. All dimensions are + or - 50mm and floor plans are not shown to scale. The kitchen layout and furniture positions are for indicative purposes only. The computer generated image is for illustrative purposes only and it is from an imaginary viewpoint within an open space area. Its purpose is to give a feel for the development, not an accurate description of each property. The illustration shows a typical Taylor Wimpey home of this type, but there are, however, variances from site to site. External materials, finishes, landscaping and the position of garages (where provided) may vary throughout the development. Properties may also be built handed (mirror image). Images may include optional upgrades at an additional cost. Please ask for further details. Please speak to our Sales Executives regarding the tenure of our new homes. 52752 / January 2023.



The Byford

3 BEDROOM HOME, TOTAL 961 sq ft / 89.30m²



GROUND FLOOR

Kitchen/Dining Area

5.07m × 2.87m 16'8" × 9'5"

Living Room max.

4.24m × 3.98m 13'11" × 13'1"



FIRST FLOOR

Bedroom 1 max.

4.03m × 3.00m 13'3" × 9'10"

Bedroom 2

2.82m × 2.57m 9'3" × 8'5"

Bedroom 3

3.91m × 2.15m 12'10" × 7'1"



[Discover more about this home](#)



[View our current availability](#)

The floor plans depict a typical layout of this house type. For exact plot specification, details of external and internal finishes, dimensions and floor plan differences consult your Sales Executive. All dimensions are + or - 50mm and floor plans are not shown to scale. The kitchen layout and furniture positions are for indicative purposes only. The computer generated image is for illustrative purposes only and it is from an imaginary viewpoint within an open space area. Its purpose is to give a feel for the development, not an accurate description of each property. The illustration shows a typical Taylor Wimpey home of this type, but there are, however, variances from site to site. External materials, finishes, landscaping and the position of garages (where provided) may vary throughout the development. Properties may also be built handed (mirror image). Images may include optional upgrades at an additional cost. Please ask for further details. Please speak to our Sales Executives regarding the tenure of our new homes. 52752 / January 2023.



The Wellington

3 BEDROOM HOME, TOTAL 1,024 sq ft / 95.20m²



GROUND FLOOR

Kitchen/Dining Area max.

5.41m × 3.35m 17'9" × 11'0"

Living Room

5.41m × 3.07m 17'9" × 10'1"



FIRST FLOOR

Bedroom 1

4.10m × 3.09m 13'6" × 10'2"

Bedroom 2 max.

2.95m × 2.53m 9'8" × 8'4"

Bedroom 3

3.30m × 2.37m 10'10" × 7'9"

[→ View development](#)

[→ View our current availability](#)

The floor plans depict a typical layout of this house type. For exact plot specification, details of external and internal finishes, dimensions and floor plan differences consult your Sales Executive. All dimensions are + or - 50mm and floor plans are not shown to scale. The kitchen layout and furniture positions are for indicative purposes only. The computer generated image is for illustrative purposes only and it is from an imaginary viewpoint within an open space area. Its purpose is to give a feel for the development, not an accurate description of each property. The illustration shows a typical Taylor Wimpey home of this type, but there are, however, variances from site to site. External materials, finishes, landscaping and the position of garages (where provided) may vary throughout the development. Properties may also be built handed (mirror image). Images may include optional upgrades at an additional cost. Please ask for further details. Please speak to our Sales Executives regarding the tenure of our new homes. 52752 / January 2023.



The Kingdale

3 BEDROOM HOME, TOTAL 1,024 sq ft / 95.20m²



GROUND FLOOR

Kitchen/Dining Area max.

5.41m × 3.35m 17'9" × 11'0"

Living Room

5.41m × 3.07m 17'9" × 10'1"



FIRST FLOOR

Bedroom 1

4.10m × 3.09m 13'6" × 10'2"

Bedroom 2

2.95m × 2.53m 9'8" × 8'4"

Bedroom 3

3.30m × 2.37m 10'10" × 7'9"



[View development](#)



[View our current availability](#)

The floor plans depict a typical layout of this house type. For exact plot specification, details of external and internal finishes, dimensions and floor plan differences consult your Sales Executive. All dimensions are + or - 50mm and floor plans are not shown to scale. The kitchen layout and furniture positions are for indicative purposes only. The computer generated image is for illustrative purposes only and it is from an imaginary viewpoint within an open space area. Its purpose is to give a feel for the development, not an accurate description of each property. The illustration shows a typical Taylor Wimpey home of this type, but there are, however, variances from site to site. External materials, finishes, landscaping and the position of garages (where provided) may vary throughout the development. Properties may also be built handed (mirror image). Images may include optional upgrades at an additional cost. Please ask for further details. Please speak to our Sales Executives regarding the tenure of our new homes. 52752 / January 2023.



The Braxton

3 BEDROOM HOME, TOTAL 1,070 sq ft / 99.50m²



GROUND FLOOR

Kitchen/Dining Area max.

4.26m x 3.39m 14'0" x 11'2"

Living Room max.

4.19m x 3.19m 13'9" x 10'6"



FIRST FLOOR

Bedroom 2 max.

4.26m x 2.82m 14'0" x 9'3"

Bedroom 3

3.59m x 2.15m 11'10" x 7'1"



SECOND FLOOR

Bedroom 1 max.

5.56m x 2.76m 18'3" x 9'1"



[Discover more about this home](#)



[View our current availability](#)

The floor plans depict a typical layout of this house type. For exact plot specification, details of external and internal finishes, dimensions and floor plan differences consult your Sales Executive. All dimensions are + or - 50mm and floor plans are not shown to scale. The kitchen layout and furniture positions are for indicative purposes only. The computer generated image is for illustrative purposes only and it is from an imaginary viewpoint within an open space area. Its purpose is to give a feel for the development, not an accurate description of each property. The illustration shows a typical Taylor Wimpey home of this type, but there are, however, variances from site to site. External materials, finishes, landscaping and the position of garages (where provided) may vary throughout the development. Properties may also be built handed (mirror image). Images may include optional upgrades at an additional cost. Please ask for further details. Please speak to our Sales Executives regarding the tenure of our new homes. 52752 / January 2023.



The Huxford

4 BEDROOM HOME, TOTAL 1,158 sq ft / 107.60m²



GROUND FLOOR

Kitchen/Dining Area

5.75m × 3.00m 18'10" × 9'10"

Living Room

4.66m × 3.64m 15'4" × 11'11"

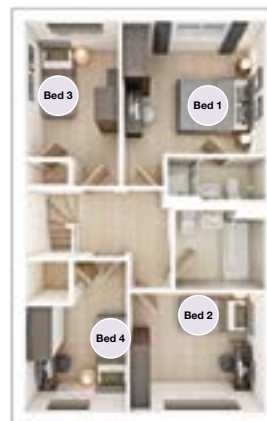

FIRST FLOOR

Bedroom 1

3.42m × 3.16m 11'3" × 10'5"

Bedroom 2

3.24m × 2.84m 10'8" × 9'4"

Bedroom 3

3.25m × 2.23m 10'8" × 7'4"

Bedroom 4

2.52m × 2.42m 8'3" × 7'11"

[→ View development](#)

[→ View our current availability](#)

The floor plans depict a typical layout of this house type. For exact plot specification, details of external and internal finishes, dimensions and floor plan differences consult your Sales Executive. All dimensions are + or - 50mm and floor plans are not shown to scale. The kitchen layout and furniture positions are for indicative purposes only. The computer generated image is for illustrative purposes only and it is from an imaginary viewpoint within an open space area. Its purpose is to give a feel for the development, not an accurate description of each property. The illustration shows a typical Taylor Wimpey home of this type, but there are, however, variances from site to site. External materials, finishes, landscaping and the position of garages (where provided) may vary throughout the development. Properties may also be built handed (mirror image). Images may include optional upgrades at an additional cost. Please ask for further details. Please speak to our Sales Executives regarding the tenure of our new homes. 52752 / January 2023.



The Trusdale

4 BEDROOM HOME, TOTAL 1,226 sq ft / 113.90m²



GROUND FLOOR

Kitchen/Dining Area max.

6.09m × 3.58m 20'0" × 11'9"

Living Room

6.09m × 3.46m 20'0" × 11'4"



FIRST FLOOR

Bedroom 1

3.52m max. × 3.03m 11'7" max. × 9'11"

Bedroom 2

3.64m × 2.95m 11'11" × 9'8"

Bedroom 3

3.05m × 2.51m 10'0" × 8'3"

Bedroom 4

3.54m × 2.25m 11'7" × 7'5"



[Discover more about this home](#)



[View our current availability](#)

The floor plans depict a typical layout of this house type. For exact plot specification, details of external and internal finishes, dimensions and floor plan differences consult your Sales Executive. All dimensions are + or - 50mm and floor plans are not shown to scale. The kitchen layout and furniture positions are for indicative purposes only. The computer generated image is for illustrative purposes only and it is from an imaginary viewpoint within an open space area. Its purpose is to give a feel for the development, not an accurate description of each property. The illustration shows a typical Taylor Wimpey home of this type, but there are, however, variances from site to site. External materials, finishes, landscaping and the position of garages (where provided) may vary throughout the development. Properties may also be built handed (mirror image). Images may include optional upgrades at an additional cost. Please ask for further details. Images may include optional upgrades at an additional cost. Please ask for further details. Images may include optional upgrades at an additional cost. Please speak to our Sales Executives regarding the tenure of our new homes. 52752 / January 2023.



The Elliston

4 BEDROOM HOME, TOTAL 1,274 sq ft / 118.40m²



GROUND FLOOR

Kitchen/Dining Area

4.90m x 2.90m 16'1" x 9'6"

Living Room max.

4.26m x 3.81m 14'0" x 12'6"



FIRST FLOOR

Bedroom 2

3.15m x 2.73m 10'4" x 9'0"

Bedroom 3 max.

3.31m x 2.35m 10'10" x 7'9"

Bedroom 4 max.

3.31m x 2.45m 10'10" x 8'1"



SECOND FLOOR

Bedroom 1 max.

5.43m x 3.89m 17'10" x 12'9"

[→ Discover more about this home](#)

[→ View our current availability](#)

The floor plans depict a typical layout of this house type. For exact plot specification, details of external and internal finishes, dimensions and floor plan differences consult your Sales Executive. All dimensions are + or - 50mm and floor plans are not shown to scale. The kitchen layout and furniture positions are for indicative purposes only. The computer generated image is for illustrative purposes only and it is from an imaginary viewpoint within an open space area. Its purpose is to give a feel for the development, not an accurate description of each property. The illustration shows a typical Taylor Wimpey home of this type, but there are, however, variances from site to site. External materials, finishes, landscaping and the position of garages (where provided) may vary throughout the development. Properties may also be built handed (mirror image). Images may include optional upgrades at an additional cost. Please ask for further details. Images speak to our Sales Executives regarding the tenure of our new homes. 52752 / January 2023.



The Marford

4 BEDROOM HOME, TOTAL 1,545 sq ft / 143.60m²



GROUND FLOOR

Kitchen	4.79m × 3.32m	15'9" × 10'11"
Family Room	3.91m × 3.26m	12'10" × 10'8"
Living Room	4.74m × 3.91m	15'7" × 12'0"
Dining Room/Study	3.04m × 2.66m	10'0" × 8'9"



FIRST FLOOR

Bedroom 1 max.	4.91m × 3.64m	16'2" × 12'0"
Bedroom 2 max.	4.00m × 3.32m	13'2" × 10'11"
Bedroom 3 max.	4.72m × 3.23m	15'6" × 10'7"
Bedroom 4	3.81m × 2.55m	12'6" × 8'4"

[→ Discover more about this home](#)

[→ View our current availability](#)

*Plot specific window to plot 56. The floor plans depict a typical layout of this house type. For exact plot specification, details of external and internal finishes, dimensions and floor plan differences consult your sales executive. All dimensions are + or - 50mm and floor plans are not shown to scale. The kitchen layout and furniture positions are for indicative purposes only. The computer generated image is for illustrative purposes only and it is from an imaginary viewpoint within an open space area. Its purpose is to give a feel for the development, not an accurate description of each property. The illustration shows a typical Taylor Wimpey home of this type, but there are, however, variances from site to site. External materials, finishes, landscaping and the position of garages (where provided) may vary throughout the development. Properties may also be built handed (mirror image). Images may include optional upgrades at an additional cost. Please ask for further details. Please speak to our Sales Executives regarding the tenure of our new homes. 52752 / January 2023.



The Thirlford

5 BEDROOM HOME, TOTAL 1,826 sq ft / 169.70m²



GROUND FLOOR

Kitchen/Dining Area max.

6.80m × 4.12m 22'3" × 13'6"

Living Room max.

4.88m × 3.90m 16'0" × 12'10"

Family Area

3.52m × 3.23m 11'7" × 10'7"

Study

3.38m × 2.18m 11'1" × 7'2"



FIRST FLOOR

Bedroom 1 max.

3.38m × 3.10m 11'1" × 10'2"

Bedroom 2 max.

3.73m × 3.25m 12'3" × 10'8"

Bedroom 3 max.

3.60m × 2.94m 11'10" × 9'8"

Bedroom 4 max.

4.09m × 2.54m 13'5" × 8'4"

Bedroom 5

3.26m × 2.45m 10'8" × 8'1"



[View development](#)



[View our current availability](#)

The floor plans depict a typical layout of this house type. For exact plot specification, details of external and internal finishes, dimensions and floor plan differences consult your Sales Executive. All dimensions are + or - 50mm and floor plans are not shown to scale. The kitchen layout and furniture positions are for indicative purposes only. The computer generated image is for illustrative purposes only and it is from an imaginary viewpoint within an open space area. Its purpose is to give a feel for the development, not an accurate description of each property. The illustration shows a typical Taylor Wimpey home of this type, but there are, however, variances from site to site. External materials, finishes, landscaping and the position of garages (where provided) may vary throughout the development. Properties may also be built handed (mirror image). Images may include optional upgrades at an additional cost. Please ask for further details. Please speak to our Sales Executives regarding the tenure of our new homes. 52752 / January 2023.



The Patterham

5 BEDROOM HOME, TOTAL 1,956 sq ft / 181.80m²



GROUND FLOOR

Kitchen/Dining Area max.

7.72m × 5.49m 25'3" × 18'0"

Living Area

4.09m × 3.61m 13'5" × 11'10"

Family Area

3.45m × 2.85m 11'3" × 9'4"

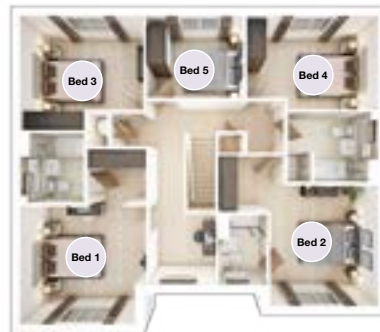

FIRST FLOOR

Bedroom 1

3.68m × 3.61m 12'1" × 11'10"

Bedroom 2 max.

3.77m × 3.38m 12'4" × 11'1"

Bedroom 3 max.

3.85m × 3.58m 12'8" × 11'9"

Bedroom 4 max.

4.10m × 2.93m 13'5" × 9'8"

Bedroom 5

3.12m × 2.57m 10'3" × 8'5"

[→ View development](#)

[→ View our current availability](#)

The floor plans depict a typical layout of this house type. For exact plot specification, details of external and internal finishes, dimensions and floor plan differences consult your Sales Executive. All dimensions are + or - 50mm and floor plans are not shown to scale. The kitchen layout and furniture positions are for indicative purposes only. The computer generated image is for illustrative purposes only and it is from an imaginary viewpoint within an open space area. Its purpose is to give a feel for the development, not an accurate description of each property. The illustration shows a typical Taylor Wimpey home of this type, but there are, however, variances from site to site. External materials, finishes, landscaping and the position of garages (where provided) may vary throughout the development. Properties may also be built handed (mirror image). Images may include optional upgrades at an additional cost. Please ask for further details. Please speak to our Sales Executives regarding the tenure of our new homes. 52752 / January 2023.

Ways to buy

Everyone knows buying a new home is an exciting time. But it can be a stressful one too, which is why our Sales Executives and customer relations managers are there to help every step of the way, from your initial enquiry right through to opening the front door of your new home for the first time.



First time buyer?

→ Here's how we can help

Existing home owner?

→ Here's how we can help



Please speak to your Sales Executive for further details.

Take your next step



Find your dream home on our website.



Book an appointment to visit our Sales Team.



Take a virtual tour of our homes from the comfort of your sofa.



Have your questions answered by calling our Sales Executives on **01304 700 048**.



Find out how we can get you moving with our buying schemes.

[→ Visit our Sales Team](#)

[→ How to buy a home](#)



WELLINGTON PADDOCKS Off Dover Road, Walmer, Deal, Kent, CT14 7PG
CONTACT US ON 01304 700 048

**Taylor
Wimpey**