



3 Riverside, Whitchurch

Myddelton&Major



3 Riverside, London Street,
Whitchurch, RG28 7LW

- Attractive period features
- Three double bedrooms
- Sitting room with open fireplace
- Dining room with log burner
- Short level walk to Town Centre
- South-West facing garden

The Property

A gravel path leads to a terrace of period properties and number 3 can be found on the end. The property is light and airy with high ceilings, large sash windows and period features. A semi-glazed front door provides light into the hallway off which is the sitting-room, a good sized room with a large bay window and Victorian fireplace with open fire. From the hall there is access to the kitchen which has a range of wall and base units and leads to a conservatory style utility area which opens to the gardens. The dining room is off the kitchen and benefits from dual aspect sash windows and log burner. On the first floor are three light and bright bedrooms, all of which are double. There is a family bathroom with a white suite and shower over bath and tongue and groove panelling. The property benefits from recent external redecoration and improvements to internal décor.

Outside

There is pedestrian access to the property from London Street and on-street car parking can often be found there or on Test Road, a short walk from the property. There is side access to the rear gardens which benefit from a south-west aspect. The gardens are mainly laid to lawn with trees and shrubs in the borders. Tucked away is a handy shed and there is a raised bed which is ideal for a vegetable patch. The property benefits from a good-sized decking area.

An attractive period property in a quiet location with a
South-West facing garden

Tenure: Freehold Size: 924.3 ft² EPC Rating: D (62) Council Tax Band: D



3



2



1

Services - Mains Water, Electricity, Gas, & Drainage. Gas Boiler - Central Heating.

Andover 8 Miles • Winchester 12 Miles • Basingstoke 12 Miles • Newbury 13 Miles





Location

Nestled in the heart of the Hampshire countryside and situated on the River Test is Whitchurch, a small town with a range of local shops and amenities. These include two small supermarkets, a bakery, coffee shop, Post Office, doctors surgery, dentist, vets and the White Hart Hotel. In addition, Whitchurch has a nursery, primary and secondary school. Transport links are excellent with access to both M3 and M4 corridors and good access onto the A34 linking north and south and the A303 linking east and west. The town is very well located with easy access to Basingstoke, Newbury, Andover and the city of Winchester. There is a mainline railway station to London Waterloo in under 1 hour.



The extent of the property is shaded green.

Note: This is for identification purposes only.



3 Riverside - Floor Plan

Ground Floor

Approx. 44.8 sq. metres (482.6 sq. feet)

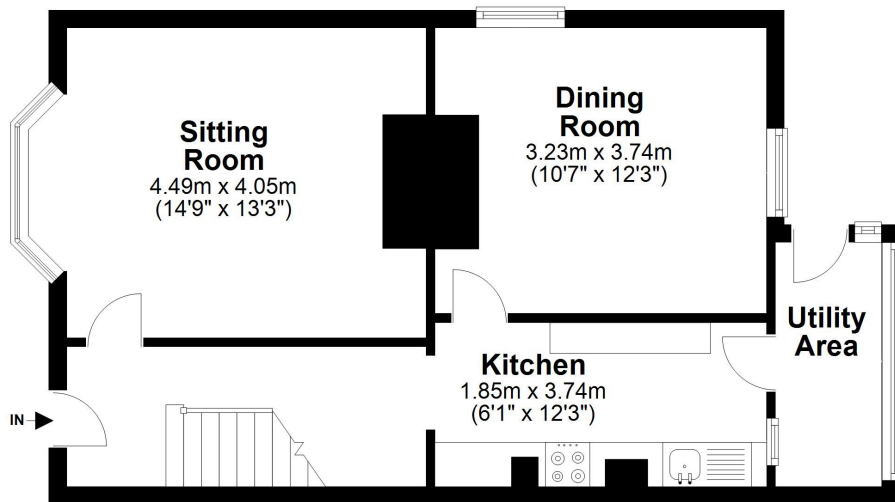

First Floor

Approx. 41.0 sq. metres (441.8 sq. feet)

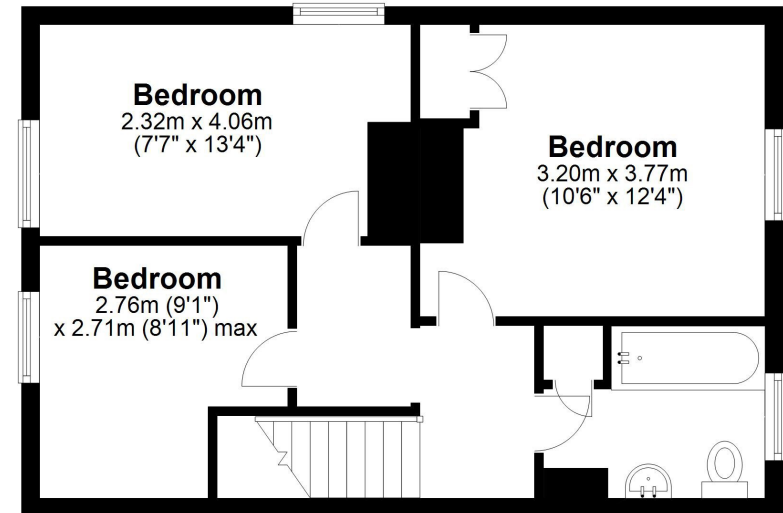

Total area: approx. 85.9 sq. metres (924.3 sq. feet)

FOR EXCLUSIVE USE BY MYDDELTON MAJOR ESTATE AGENTS
Plan for illustration only. Windows and doors are approximate. Whilst care is taken preparing this plan, please check details before making decisions reliant upon them. Measured and drawn to RICS guidelines
COPYRIGHT CLEARPLANZ



Disclaimer Notice

Myddelton & Major and their clients give notice that:- i) they have no authority to make or give any representations or warranties in relation to the property, ii) these particulars do not form part of any offer or contract and must not be relied upon as statements or representations of fact, iii) any areas, measurements or distances are approximate. The text, photographs and plans are for guidance only and are not necessarily comprehensive. It should not be assumed that the property has all the necessary planning, Building Regulation or other consents, and, any services, equipment or facilities have not been tested by the agent, iv) the purchaser must satisfy themselves by inspection or otherwise.



The Old Police House, High Street, Stockbridge, Hampshire, SO20 6HE
01264 810 400 stockbridgeresidential@myddeltonmajor.co.uk
www.myddeltonmajor.co.uk

Myddelton & Major