

Hammonds



19 Heathfield Court, 248 Tredegar Road, London, E3 2GQ

Guide Price £400,000

- Guide Price: £400,000 to £425,000
- Lease: 110 year
- Bright & Spacious
- Modern Apartment

- Ground Rent: £250 pa
- Fully Furnished
- Up and Coming Area

- Service Charge: £3000 pa
- Fully Fitted Kitchen
- Excellent Transport Links

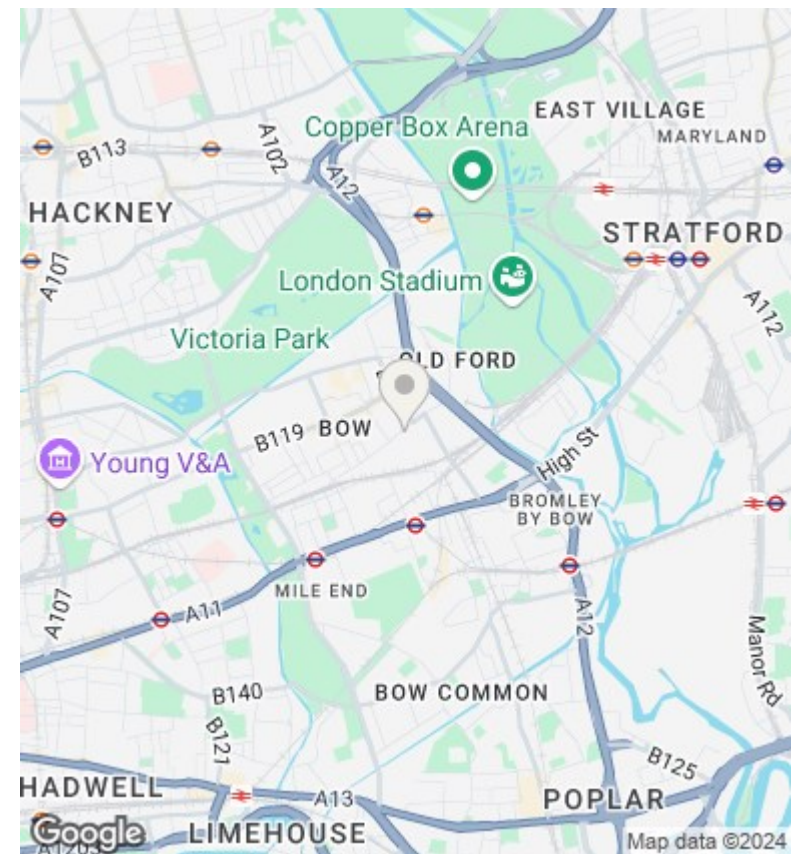
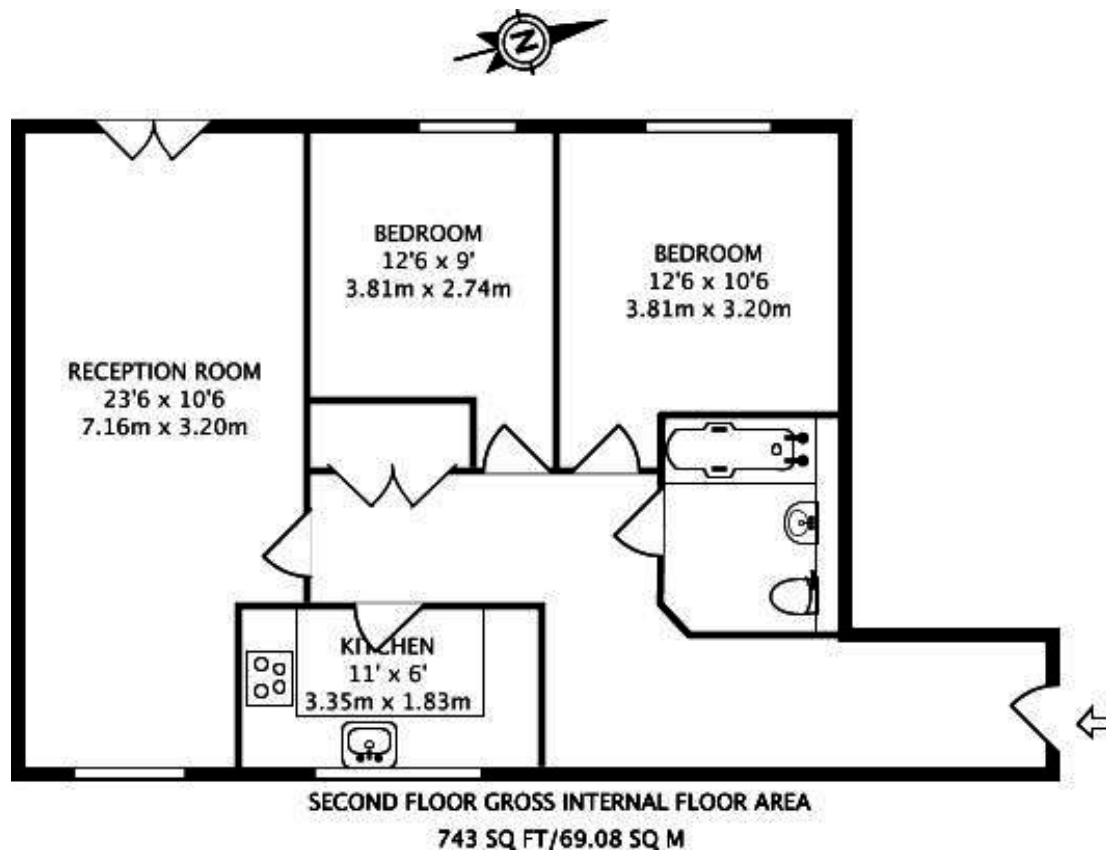

Directions

Viewings

Viewings by arrangement only. Call 02089802226 to make an appointment.

Council Tax Band

D

EPC Rating:

Energy Efficiency Rating		
	Current	Potential
<i>Very energy efficient - lower running costs</i>		
(92 plus) A		
(81-91) B		
(69-80) C		
(55-68) D		
(39-54) E		
(21-38) F		
(1-20) G		
<i>Not energy efficient - higher running costs</i>		
England & Wales	EU Directive 2002/91/EC	