









Offers Over

**£230,000**

## 52 Kenilworth Drive

Liberton | Edinburgh | EH16 6DD

This spacious and well presented terraced villa with private garden, is pleasantly situated within the popular district of Liberton, close to a fantastic range of amenities and excellent commuting links. Ideal for the growing families, internal viewing is recommended to be fully appreciated.

-  3 bedrooms
-  2 public rooms
-  1 bathroom
-  Private front and rear gardens
-  EPC rating – D
-  Council tax band - C



## Description

Offering lovely open views towards Arthur's Seat, the property in brief comprises; welcoming entrance hallway, generously proportioned and bright lounge, attractive fitted kitchen/dining pleasantly overlooking the rear garden with built-in storage and door providing direct access to the garden, well proportioned principal bedroom with fitted mirrored wardrobes, two further good sized bedrooms with built-in storage and contemporary bathroom with white three-piece suite and shower over bath. Further benefits include gas central heating and double glazing.



## Extras

All fitted floor coverings and blinds will be included in the sale together with the washing machine, tumble dryer, oven/hob, fridge/freezer and dishwasher.

## Gardens & Parking

To the front lies a well maintained private garden and to the rear there is a good sized private garden which is mainly laid to lawn with an area of patio. Ample on-street parking can be found to the front and surrounding area.

## Viewing

By appointment through Neilsons (0131 625 2222).







## Location

The property is situated within the popular area of Liberton, lying to the south of the city centre. The area has a good range of local shopping facilities at nearby Cameron Toll and there are additional shopping facilities at the nearby Straiton Retail Park and Fort Kinnaird. The City of Edinburgh Bypass is on hand linking the main Scottish motorway network system and excellent bus services serve the area linking the city centre and surrounding areas. Leisure and recreational facilities in the area include Liberton Golf Course, Gracemount Leisure and lovely walks can be enjoyed at the Hermitage of Braids and Blackford Hill nature reserve. The Royal Infirmary and the University of Edinburgh's King's Buildings are also nearby and within walking distance.





Approx. Gross Internal Floor Area 91.21 Sq M / 982 Sq Ft.

Ground Floor

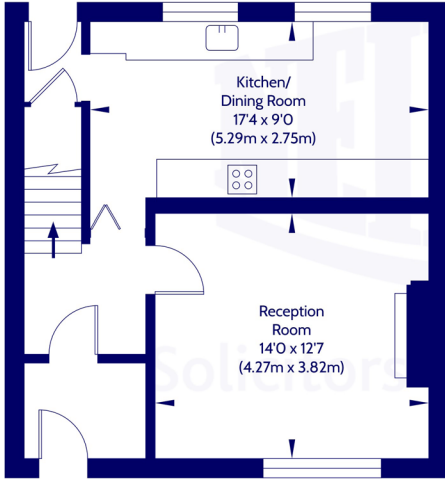

First Floor

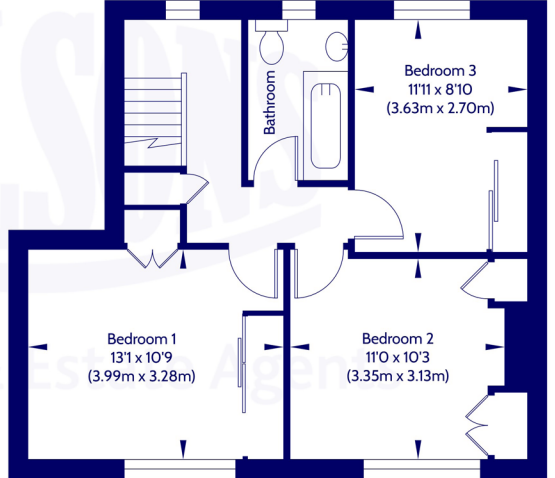

Area excludes garages, outbuildings, attics and eaves if applicable.  
All measurements are approximate. Not to scale. For identification only.  
© 2024 Neilsons Solicitors & Estate Agents. Plans by Planography.co.uk

Whilst we endeavour to ensure that our sales particulars are accurate and reliable, the following general points should be noted with regard to the extent of our investigations prior to marketing the property and therefore if any particular aspect is of crucial relevance to you, please contact this office for verification particularly if you are contemplating travelling some distance to view.

- [1] All measurements have been taken using a sonic measuring device and there may be some minor fluctuations in measurements due to the limitations of the device.
- [2] None of the items included in the sale of a working or running nature have been tested by us and this Firm gives no warranty as to their condition.
- [3] Where alterations or improvements have been undertaken by the sellers or their predecessors, we have not specifically established that the renewal or replacement of any of the services or facilities have been whole or partial.
- [4] Verification of Council Tax banding can be obtained from City of Edinburgh Council or Public Libraries.



Scan the QR code or [click here](#) for the virtual 360 tour, floor plan and further information.



Solicitors & Estate Agents

## Our Services:

- Full estate agency service
- Buying & Selling
- Buy to let advice
- Wills & Powers of Attorney
- Estate Planning
- Executries
- Powers of Attorney

For helpful, friendly, personal advice, get in touch.

✉ [mail@neilsons.co.uk](mailto:mail@neilsons.co.uk)

☎ 0131 625 2222

💻 [www.neilsons.co.uk](http://www.neilsons.co.uk)

### Head Office

138 St John's Road  
Edinburgh

### Property Department

142 St John's Road  
Edinburgh

### City Centre

2a Picardy Place  
Edinburgh

### South Queensferry

37 High Street  
South Queensferry

### Bonnyrigg

72 High Street  
Bonnyrigg

