

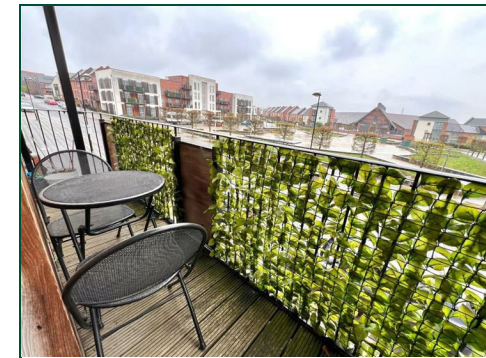

Strobel Drive

Upton, Northampton

oriordanbond
SALES & LETTINGS



GROUND FLOOR
674 sq.ft. (62.6 sq.m.) approx.

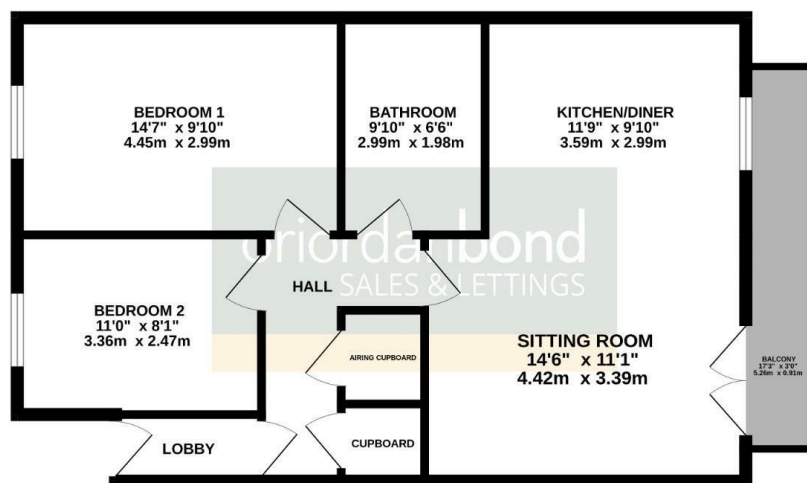

TOTAL FLOOR AREA : 674 sq.ft. (62.6 sq.m.) approx.
Whilst every attempt has been made to ensure the accuracy of the floorplan contained here, measurements of doors, windows, rooms and any other items are approximate and no responsibility is taken for any error, omission or mis-statement. This plan is for illustrative purposes only and should be used as such by any prospective purchaser. The services, systems and appliances shown have not been tested and no guarantee as to their operability or efficiency can be given.
Made with Metropix (02025)

Strobel Drive

Upton
NN5 4FA

PRICE £185,000

Presented to an immaculate standard and located within the heart of Upton is this two bedroom apartment. Located on the first floor in the block, the property would make an ideal purchase for first time buyers and investors, and is situated within close proximity to local schools along with Upton Country Park and all the amenities at Sixfields Leisure Park.

Accommodation comprises entrance hall, sitting room with patio doors leading to the balcony, kitchen/diner with integrated appliances, two double size bedrooms and a family bathroom. The property also benefits from uPVC double glazing, gas central heating with solar powered hot water and one allocated parking space within a secure gated area to the rear. (B/674/balc)

Leasehold Information: Remaining Lease - 114 years (as on 2025) / Service Charge - £144.67 per month / Ground Rent - £0

Additional information

- Council Tax Band: C
- Energy Efficiency Rating: C

Viewing

Viewing strictly by appointment – details below

Disclaimer

O'Riordan Bond Estate Agents Limited has not tested apparatus, equipment, fittings or services and so cannot verify they are in working order. The buyer is advised to obtain verification from their solicitor or surveyor.

O'Riordan Bond Duston Sales
01604 589007
duston@oriordanbond.co.uk

