



Handsworth Avenue, London, E4

BUTLER  STAG



A top floor, part furnished two double bedroom apartment just moments from Highams Park Train Station and the open spaces of Epping Forest.



- Two Double Bedrooms
- Available April
- Excellent Access To Transport
- Top Floor
- Part Furnished
- Great Location

Butler & Stag are delighted to offer to great tenants this top floor, two double bedroom apartment set close to the heart of Highams Park.

The property has been lightly refurbished and offers a modern kitchen, a large three piece bathroom suite and two double bedrooms with amazing views across London.

Excellent access to local Train Station (TFL Zone 4), schools, shops and not a million miles away from the open spaces of Epping Forest.

Council Tax Band C





Melrose Court

Approx. Gross Internal Area 61.1 Sq M (658 Sq Ft)

BUTLER & STAG



Second Floor

Approx. 61.1 sq. metres (658.0 sq. feet)

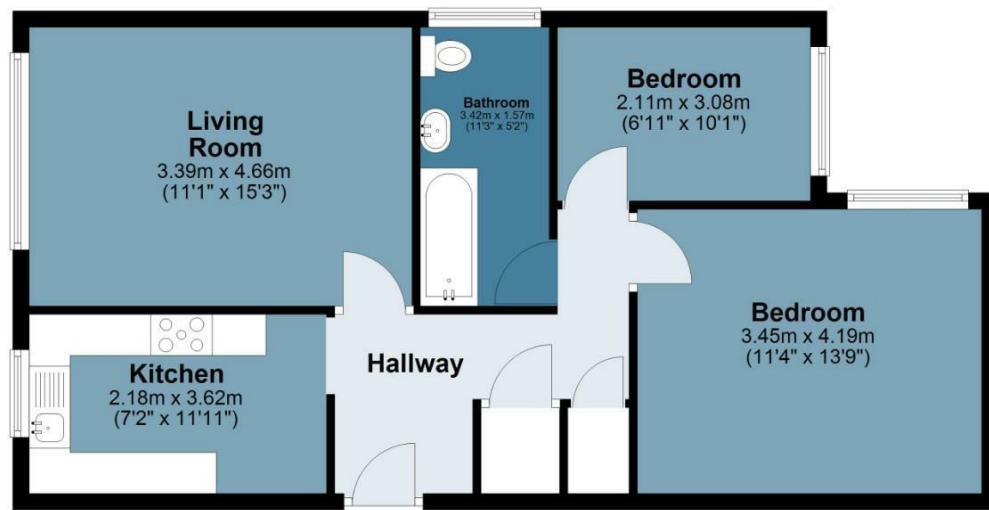

Measurements are approximate and for illustration purposes only. While we do not doubt the accuracy and completeness, we advise you conduct a careful independent assessment of the property to determine monetary value.
© @modephotouk www.modephoto.co.uk

IMPORTANT NOTICE - These particulars have been prepared in good faith and they are not intended to constitute part of an offer or contract. We have not performed a structural survey on this property and the services, appliances and specific fittings have not been tested. All photographs, measurements, floor plans and distances referred to are given as a guide and should not be relied upon.

BUTLER & STAG

☎ 020 8504 9000

🏠 184 Queen's Road, Buckhurst Hill, IG9 5BD

✉ buckhursthill@butlerandstag.com

www.butlerandstag.uk