



Tudor Court, Walthamstow, E17

BUTLER & STAG



**Two double bedroom,  
ground floor apartment  
with private rear  
garden. Set in a quiet  
E17/Walthamstow Cul-  
De-Sac. St James Street  
Overground 0.7 miles.**



## Leasehold

- Two Double Bedroom Ground Floor Apartment
- Beautifully Presented
- Private Rear Garden
- High Quality Fitted Kitchen & Bathroom

Welcome to Tudor Court, located in the charming area of Walthamstow! This delightful flat boasts a character that is truly unique, perfect for those seeking a home with a story to tell.

Upon entering, you are greeted by a cosy reception room, ideal for relaxing after a long day. The property features two spacious double bedrooms, offering ample space for a growing family or guests. The bathroom is conveniently located, ensuring both privacy and functionality.

One of the standout features of this property is its private rear garden. Imagine enjoying your morning coffee surrounded by lush greenery, a tranquil oasis right at your doorstep. The garden provides the perfect space for outdoor entertaining or simply unwinding in the fresh air.

This flat exudes charm and history, making it a truly special find. The property is beautifully presented, showcasing a blend of modern amenities with classic character features.

Conveniently located just 0.7 miles from St James Street Overground, commuting and exploring the city is a breeze. Whether you're looking for a peaceful retreat or a well-connected home, Tudor Court offers the best of both worlds.

Don't miss the opportunity to make this character-filled flat your own. Contact us today to arrange a viewing and step into the charm of Tudor Court!





## Tudor Court, E17

Approx. Gross Internal Area 493 Sq Ft - 45.80 Sq M

BUTLER & STAG

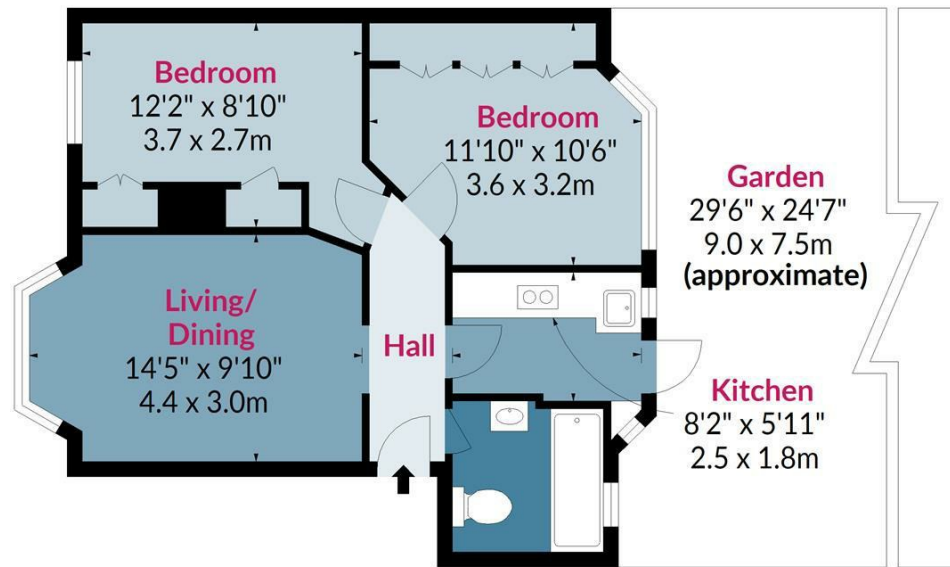

### Ground Floor

Floor Area 493 Sq Ft - 45.80 Sq M



Measured according to RICS IPMS2. Floor plan is for illustrative purposes only and is not to scale. Every attempt has been made to ensure the accuracy of the floor plan shown, however all measurements, fixtures, fittings and data shown are an approximate interpretation for illustrative purposes only. 1 sq m = 10.76 sq feet.

lpaplus.com

Date: 22/5/2024

IMPORTANT NOTICE - These particulars have been prepared in good faith and they are not intended to constitute part of an offer or contract. We have not performed a structural survey on this property and the services, appliances and specific fittings have not been tested. All photographs, measurements, floor plans and distances referred to are given as a guide and should not be relied upon.

BUTLER & STAG

☎ 020 8504 9000

🏠 184 Queen's Road, Buckhurst Hill, IG9 5BD

✉ buckhursthill@butlerandstag.com

[www.butlerandstag.uk](http://www.butlerandstag.uk)