



Queens Road, Buckhurst Hill, IG9

BUTLER & STAG



**GUIDE PRICE £325,000 -
£350,000.**

**A commuters dream located
on Queens Road. Alma
Cottage is a charming house
in the heart of Buckhurst
Hill, located on top of all your
local amenities and
transport links.**



Freehold

- Under 100 yards to Buckhurst Hill Central Line station
- Perfect first time buy
- Fully integrated kitchen
- Being sold with no onward chain
- Good decorative order throughout
- Central Buckhurst Hill location

Welcome to Alma Cottage, a perfect haven for first-time buyers seeking a blend of comfort and convenience. A commuter's dream located in the heart of Buckhurst Hill, Alma Cottage is a charming house located on top of all your local amenities and transport links.

This gated one-bedroom gem, situated on Queens Road in the heart of Buckhurst Hill, Essex, offers a delightful open-plan living space, creating a warm and inviting atmosphere. The spacious bedroom provides a tranquil retreat after a bustling day. Ideal for city commuters, this property is conveniently located near Buckhurst Hill Central Line station, ensuring a seamless journey to the city. With the added perk of proximity to Waitrose, Alma Cottage offers the perfect mix of urban connectivity and everyday convenience.





Alma Cottage, Queens Road

Approx. Gross Internal Area 41.9 Sq M (451 Sq Ft)

BUTLER & STAG

Ground Floor

Approx. 19.7 sq. metres (212.1 sq. feet)

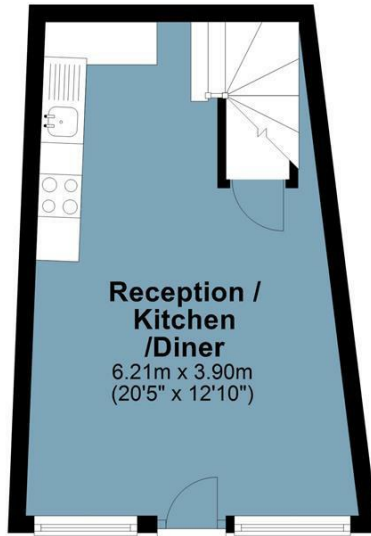

First Floor

Approx. 17.7 sq. metres (190.6 sq. feet)

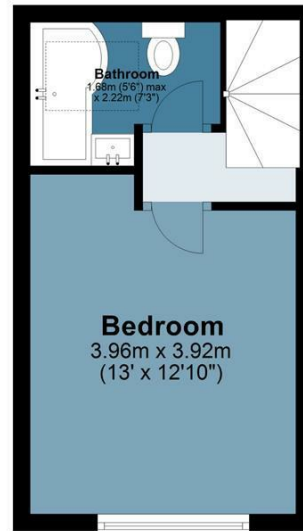

Measurements are approximate and for illustration purposes only. While we do not doubt the accuracy and completeness, we advise you conduct a careful independent assessment of the property to determine monetary value.
© @modephoto.uk www.modephoto.co.uk

BUTLER & STAG

☎ 020 8504 9000

🏠 184 Queen's Road, Buckhurst Hill, IG9 5BD

✉ buckhursthill@butlerandstag.com

www.butlerandstag.uk

IMPORTANT NOTICE - These particulars have been prepared in good faith and they are not intended to constitute part of an offer or contract. We have not performed a structural survey on this property and the services, appliances and specific fittings have not been tested. All photographs, measurements, floor plans and distances referred to are given as a guide and should not be relied upon.