



ST. THERESA
CHURCH
1, 2, 3 & 4
7, 8, 9 & 10

Forest View, London, E4

BUTLER & STAG



A very well presented, ground floor apartment set on one of North Chingford's most desirable turnings. Just moments from Royal Chingford Golf Club and with the shops, bars and transport of Station Road (TFL 5) within a half mile. Chain Free, share of freehold.



Leasehold

- Large (678 sq ft) One Bedroom Ground Floor Apartment
- Beautifully Presented Throughout
- Allocated Parking
- Chain Free
- Bright Reception Room
- Gas Central Heating (Preferable to Electric)
- Superb Location

Available to view now, Butler & Stag are delighted to offer for sale this immaculately presented ground floor apartment in popular St Theresa's court.

The property will appeal to people that are looking for something just a little higher quality than is normally expected when looking for a good home, and this apartment will appeal to younger buyers and downsizers alike that will just love the exclusive location.

Beautifully presented throughout, the property offers a bright bay fronted reception room, 136 sq ft bedroom, a modern fitted kitchen with integrated appliances and high gloss fitted kitchen units, utility room and a luxury four piece bathroom suite.

The property sits in landscaped communal grounds and benefits from allocated parking spaces.

St Theresa's Court, is set on Forest Edge in North Chingford, a hugely desirable turning set on the edge of the Royal Chingford Golf Course and the open spaces of Epping Forest.

Locally, you will find that you are also less than a half mile from popular Station Road. With a fantastic range of independent shops, bars and restaurants, it really has a lovely holiday feel over the summer months, with some fantastic outdoor dining.

Finally, Chingford Station (TFL 5). With a new fleet of very quiet trains on this overground line, Liverpool Street, The City and West End are all easily accessible.

CHAIN FREE





St Theresa Court, E4

Approx. Gross Internal Area 678 Sq Ft - 62.99 Sq M

BUTLER & STAG

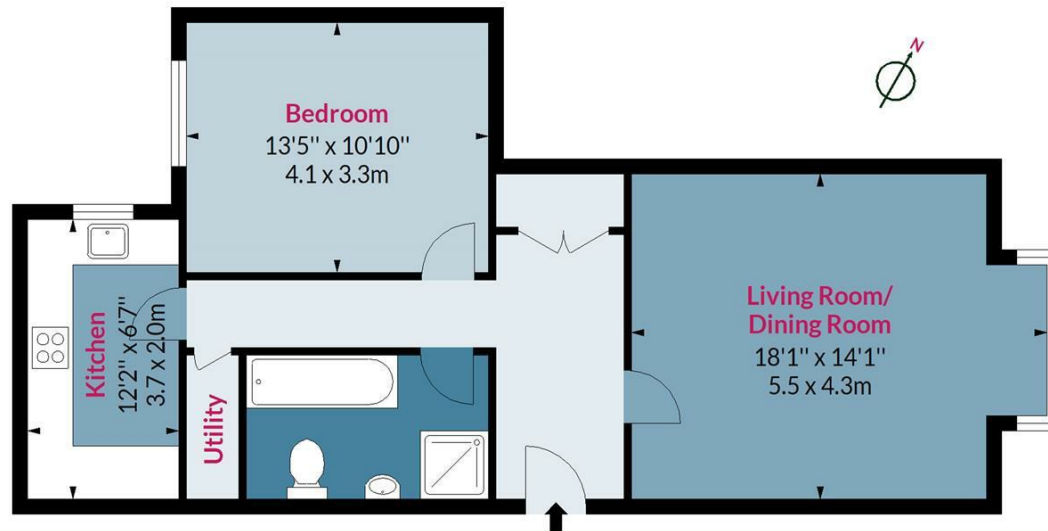

Ground Floor

Floor Area 678 Sq Ft - 62.99 Sq M



Measured according to RICS IPMS2. Floor plan is for illustrative purposes only and is not to scale. Every attempt has been made to ensure the accuracy of the floor plan shown, however all measurements, fixtures, fittings and data shown are an approximate interpretation for illustrative purposes only. 1 sq m = 10.76 sq feet.

lpaplus.com

Date: 24/10/2023

IMPORTANT NOTICE - These particulars have been prepared in good faith and they are not intended to constitute part of an offer or contract. We have not performed a structural survey on this property and the services, appliances and specific fittings have not been tested. All photographs, measurements, floor plans and distances referred to are given as a guide and should not be relied upon.

BUTLER & STAG

☎ 020 8504 9000

🏠 184 Queen's Road, Buckhurst Hill, IG9 5BD

✉ buckhursthill@butlerandstag.com

www.butlerandstag.uk