

Emma Terry Homes

moving made personal



13-15 Station Road

Lowdham, Nottingham, NG14 7DU

£1,400 Per month



13-15 Station Road, Lowdham, Nottingham NG14 7DU

£1,400 Per month

Introducing...Victoria Mews - Two Bedroom Semi Detached Property with Off-street Parking and Private Garden.

Viewing is an absolute must!

The attention to detail and quality of finish are truly something special.

Backing onto the cocker beck, the sound of running water can be heard from numerous apartments with the occasional sighting of the resident Kingfisher.

The development is brimming with quality, high class appliances, luxury fixtures and fittings at every corner. From French windows for natural light, to solid oak internal doors. With parking for each property and outside space for all, we are sure this development will not disappoint.

Lowdham has a wealth of amenities including local shops, a variety of pubs, hair salons, a post office, along with bus and rail links giving commuters direct options into Nottingham, Southwell and Newark town centre.



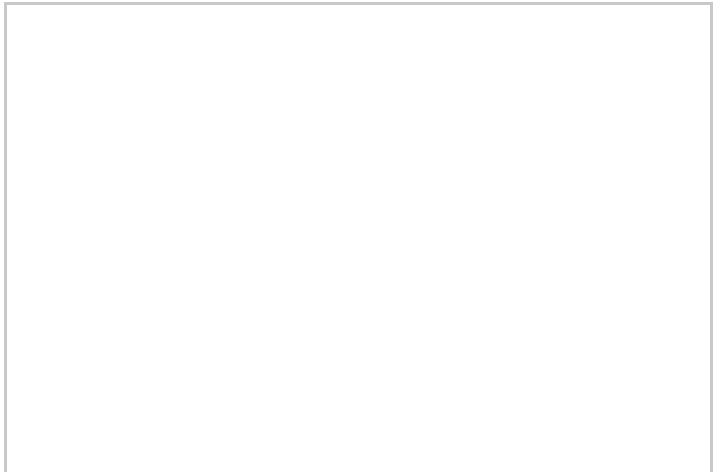
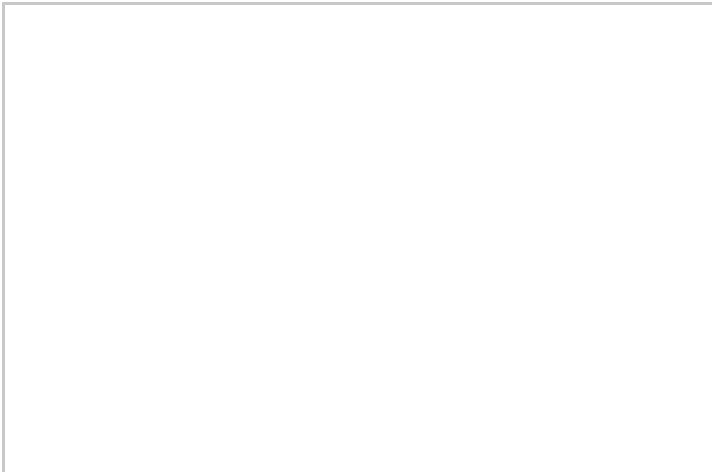
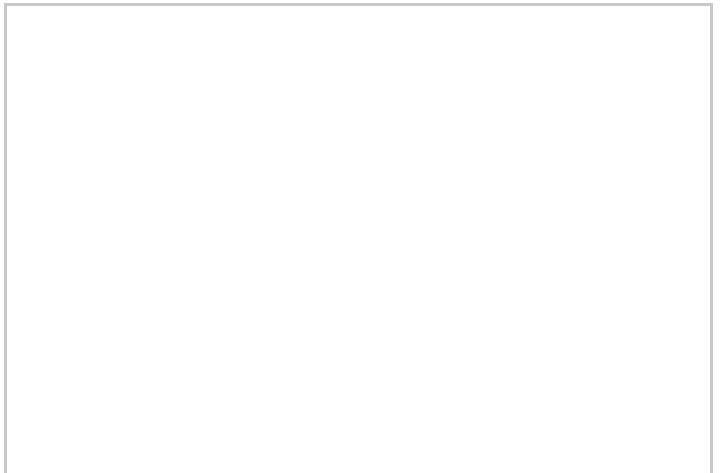

Road Map

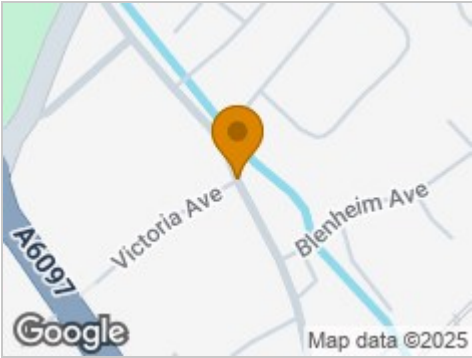

Hybrid Map



Terrain Map

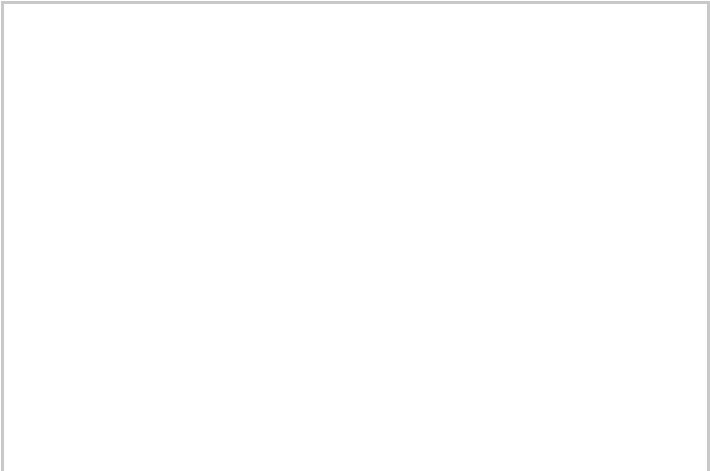
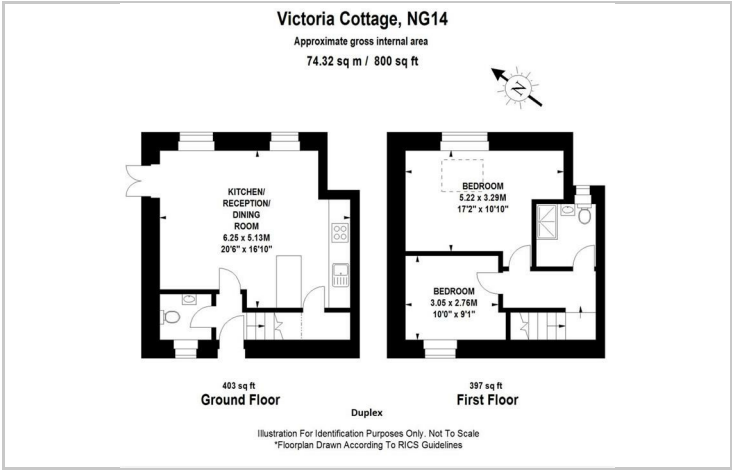

Viewing

Please contact our Emma Terry Homes Office on 0115 966 57 41 if you wish to arrange a viewing appointment for this property or require further information.

Energy Efficiency Graph

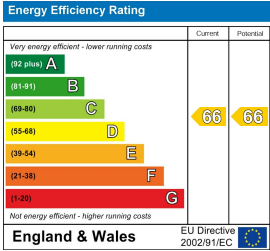

These particulars, whilst believed to be accurate are set out as a general outline only for guidance and do not constitute any part of an offer or contract. Intending purchasers should not rely on them as statements of representation of fact, but must satisfy themselves by inspection or otherwise as to their accuracy. No person in this firms employment has the authority to make or give any representation or warranty in respect of the property.