

GUILDHALL

SALES & LETTINGS



6 Melrose Avenue

Fulwood, Preston, PR2 8DE

£230,000



Situated in the heart of Fulwood, one of Preston's most desirable residential areas, this spacious and versatile three/four-bedroom semi-detached home offers an excellent opportunity for families or anyone seeking flexible living accommodation in a well-connected location.

The property is thoughtfully laid out and well maintained throughout. On the ground floor, you'll find a generously sized main reception room, a separate dining room, and a modern fitted kitchen offering ample cupboard space and work surfaces, perfect for everyday family living or entertaining guests. The ground floor bathroom is a practical feature, particularly for growing families or those requiring accessible facilities.

A standout feature of the property is the flexible fourth bedroom, located on the ground floor, which can alternatively be used as a second lounge, playroom, home office, or guest room—tailored to suit your lifestyle needs.

Upstairs, the property benefits from an extended layout thanks to a professionally constructed dormer, allowing for spacious and well-proportioned bedrooms with enhanced natural light and headroom. All rooms are



Ground Floor

- Kitchen 10'2" x 7'6" (3.1m x 2.3m)
- Reception Room One 15'5" x 7'2" (4.7m x 2.2m)
- Reception Room Two 12'5" x 9'2" (3.8m x 2.8m)
- Bathroom 5'6" x 5'6" (1.7m x 1.7m)
- Bedroom Four 9'2" x 9'2" (2.8m x 2.8m)

First Floor

- Bedroom One 12'5" x 8'2" (3.8m x 2.5m)
- Storage 7'2" x 6'6" (2.2m x 2.0m)
- Bedroom Two 12'9" x 7'6" (3.9m x 2.3m)
- Bedroom Three 8'10" x 5'6" (2.7m x 1.7m)

Area Map



Floor Plans

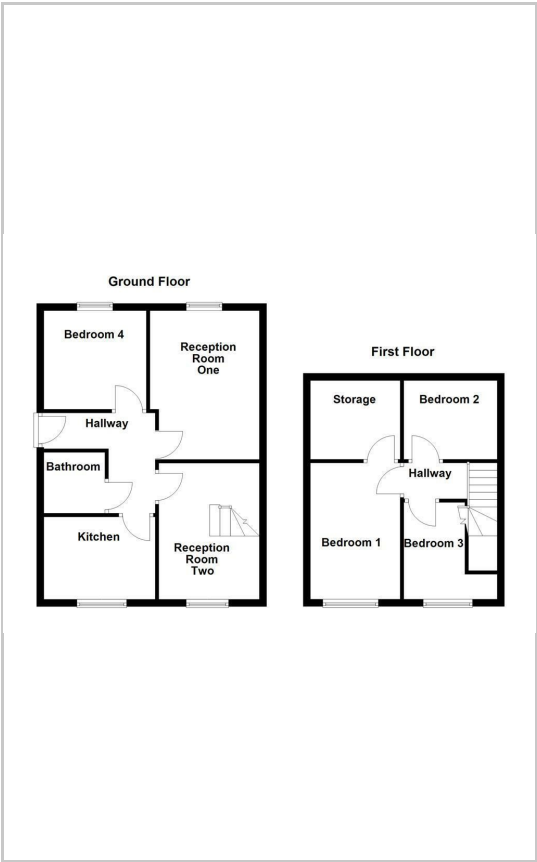

Energy Efficiency Graph

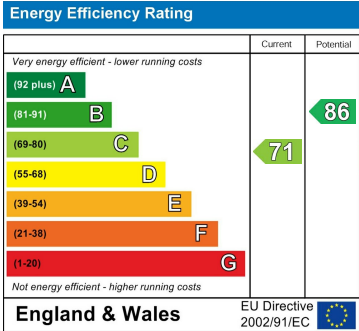

These particulars, whilst believed to be accurate are set out as a general outline only for guidance and do not constitute any part of an offer or contract. Intending purchasers should not rely on them as statements of representation of fact, but must satisfy themselves by inspection or otherwise as to their accuracy. No person in this firms employment has the authority to make or give any representation or warranty in respect of the property.