

GUILDHALL

SALES & LETTINGS



66 Lower Hill Drive

, Heath Charnock, PR6 9JP

£475,000



EXQUISITE DETACHED BUNGALOW SITUATED ON AN IMPRESSIVE PLOT

Welcome to Lower Hill Drive, Heath Charnock, Chorley - positioned on an impressive plot in a desirable cul-de-sac stands this charming and beautifully maintained bungalow. This property boasts two reception rooms, three spacious bedrooms and a four piece bathroom making it the perfect home for entertaining guests or simply relaxing with the family.

One of the standout features of this property is the ample off-road parking, ensuring you never have to worry about finding a space for your vehicle.

This property is not overlooked and benefits from stunning countryside views to the rear, providing you with the privacy and tranquillity you desire. Imagine waking up to these views every morning and enjoying the serenity of the surroundings. The stunning garden is perfect for those with green fingers or for simply unwinding after a long day.



Ground Floor

Entrance Porch

UPVC double glazed frosted front door, UPVC double glazed frosted window, wood effect laminate flooring and hardwood single glazed frosted door and window to hall.

Hall 14'7" x 6'0" (4.45m x 1.83m)

Central heating radiator, doors leading to reception room, kitchen/dining area, bathroom, two bedrooms, storage cupboard and wood effect laminate flooring.

Reception Room 18'0" x 11'8" (5.49m x 3.58m)

Two UPVC double glazed windows, two central heating radiators, coving to ceiling, gas stove with exposed brick surround, television point and two feature wall lights.

Kitchen/Dining Room 18'0" x 15'10" (5.49m x 4.83m)

Two UPVC double glazed windows, two central heating radiators, range of wall and base units with granite effect worktops, tiled splashbacks, composite one and a half bowl sink and drainer with mixer tap, Belling oven with seven burner gas hob and Rangemaster extractor hood, plate warmer and grill, space for fridge freezer, plumbing for washing machine, space for dryer, multifuel log burner, tiled effect vinyl flooring, door to study and UPVC double glazed door to rear.

Bedroom Three/Split Level 14'4" x 11'1" (4.37m x 3.38m)

UPVC double glazed window, central heating radiator, door to en suite cloakroom and stairs to first floor.

TV Room/Study (Split Level) 12'0" x 11'1" (3.68m x 3.38m)

Hardwood double glazed Velux window, electric heater and access to eaves storage.

WC

UPVC double glazed frosted window, electric heater, wall mounted wash basin with traditional taps, flush handle WC and part tiled elevations.

Bedroom One 14'9" x 12'11" (4.50m x 3.94m)

UPVC double glazed window, central heating radiator, loft access and fitted wardrobes.

Bedroom Two 11'10" x 9'6" (3.63m x 2.90m)

UPVC double glazed window and central heating radiator.

Bathroom 11'3" x 8'11" (3.43m x 2.72m)

UPVC double glazed frosted window, electric heated towel rail, flush handle WC, pedestal wash basin with traditional taps, electric feed shower enclosed, panel bath with traditional taps, part tiled elevations, extractor fan and tiled effect vinyl flooring.

Exterior

Rear

Enclosed garden with paved patio, stone chippings, laid to lawn, mature shrubbery, trees, vegetable plot, decked seating area, access to second garage/workshop, greenhouse and summerhouse.

Front

Laid to lawn, stone chippings, off road parking leading to garage and open access to rear garden.

Garage 17'7" x 11'1" (5.38m x 3.38m)

Power, electric and up and over garage door.

Area Map



Floor Plans

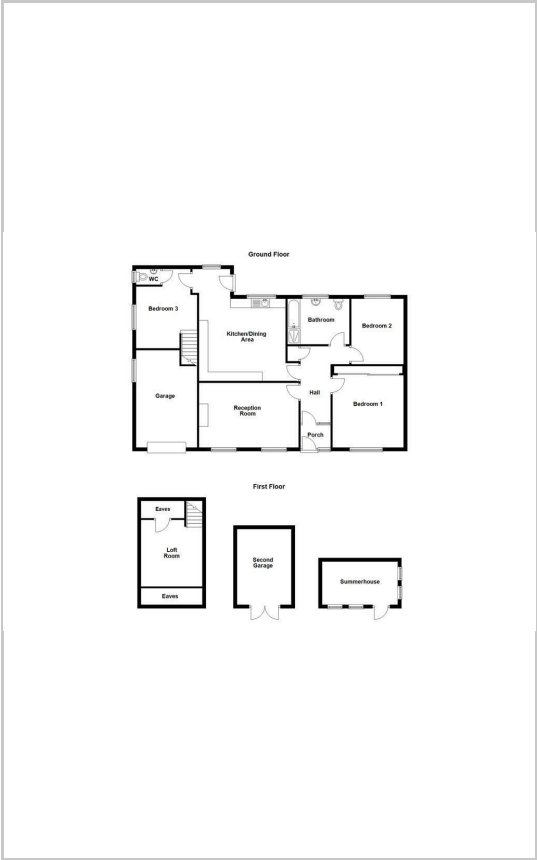

Energy Efficiency Graph

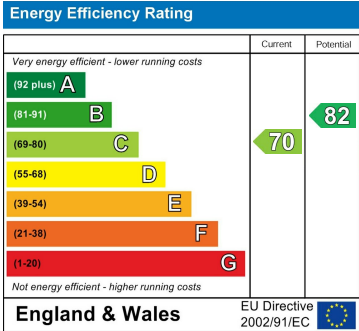

These particulars, whilst believed to be accurate are set out as a general outline only for guidance and do not constitute any part of an offer or contract. Intending purchasers should not rely on them as statements of representation of fact, but must satisfy themselves by inspection or otherwise as to their accuracy. No person in this firms employment has the authority to make or give any representation or warranty in respect of the property.