

GUILDHALL

SALES & LETTINGS



57 Blackburn Road

Whittle-Le-Woods, Chorley, PR6 8LF

Price Guide £400,000



GUIDE PRICE £400,000 TO £425,000

Nestled in the sought-after area of Whittle-Le-Woods, Chorley, this impressive four-bedroom detached dormer bungalow on Blackburn Road offers a perfect blend of space and comfort. The property boasts a generous layout, making it an ideal family home.

As you approach, you will be greeted by a spacious driveway leading to a double garage, providing ample parking and storage options. The rear gardens are a delightful feature, offering a private outdoor space perfect for relaxation or entertaining guests during the warmer months.

The interior of the bungalow is thoughtfully designed, with bedroom one featuring a convenient dressing room, adding a touch of luxury to your daily routine. Each of the four bedrooms is well-proportioned, ensuring that there is plenty of room for family members or guests.



Ground Floor

Porch

Hallway

Kitchen 10'8 x 10'3 (3.25m x 3.12m)

Utilty 5'5 x 16'0 (1.65m x 4.88m)

Dining Room 14'5 x 10'11 (4.39m x 3.33m)

Lounge 14'5 x 13'4 (4.39m x 4.06m)

WC 5'3 x 2'10 (1.60m x 0.86m)

Bedroom One 14'4 x 13'5 (4.37m x 4.09m)

Dressing Room 29'6""36'1" x 16'4""3'3" (9'11 x 5'1)

Bedroom Two 11'1 x 8'7 (3.38m x 2.62m)

Bathroom 16'4 x 9'11 (4.98m x 3.02m)

Storage Cupboard 10'10 x 6'4 (3.30m x 1.93m)

Bathroom 52'5""13'1" x 29'6""36'1" (16'4 x 9'11)

First Floor

Bedroom Three 14'5 x 12'8 (4.39m x 3.86m)

Bedroom Four 14'4 x 12'8 (4.37m x 3.86m)

Area Map



Floor Plans

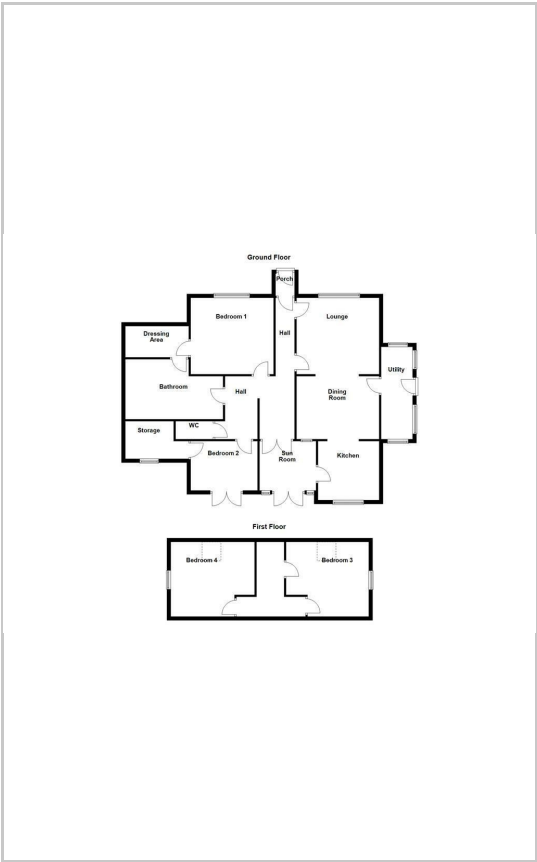

Energy Efficiency Graph

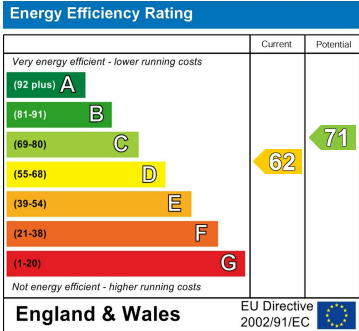

These particulars, whilst believed to be accurate are set out as a general outline only for guidance and do not constitute any part of an offer or contract. Intending purchasers should not rely on them as statements of representation of fact, but must satisfy themselves by inspection or otherwise as to their accuracy. No person in this firms employment has the authority to make or give any representation or warranty in respect of the property.