

GUILDHALL

SALES & LETTINGS



307 Cemetery Road

, Preston, PR1 5UT

£105,000



Guildhall Sales and Lettings are pleased to introduce this two bedroomed, mid terraced property to the market. Situated within the popular area of Ribbleton, within close proximity to local amenities, commuter links and schools. Boasting deceptively spacious accommodation throughout, this property is ideally suited for first time buyers or investors and internally comprises briefly:

Entrance through to the entrance porch providing access to the lounge which houses double doors to the fitted kitchen. From the kitchen is the staircase to the first floor and open access to the dining area with double doors to the rear. To the first floor are two double bedrooms and a three piece family bathroom suite.

Externally to the rear is an enclosed rear yard. To the front of the property is on street parking.

Viewings are essential, for further information or to arrange a viewing, please call the team on 01772 769999.



Ground Floor

Entrance Porch

Lounge 12'7 x 12'2 (3.84m x 3.71m)

Kitchen 9'3 x 8' (2.82m x 2.44m)

Dining Area 9'7 x 5'1 (2.92m x 1.55m)

First Floor

Landing

Bedroom One 15'3 x 9'7 (4.65m x 2.92m)

Bedroom Two 11'1 x 9'3 (3.38m x 2.82m)

Bathroom 8'0 x 6'2 (2.44m x 1.88m)

External

Rear

Enclosed rear yard.

Area Map

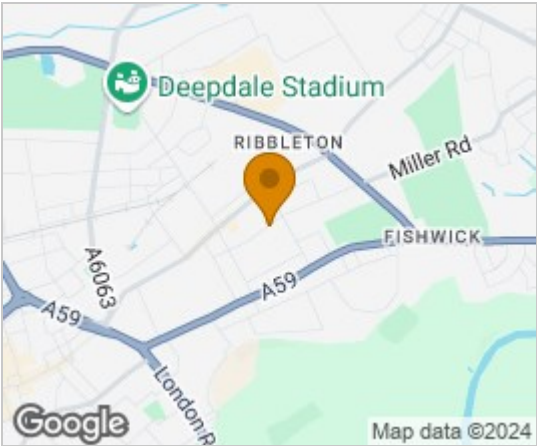

Floor Plans

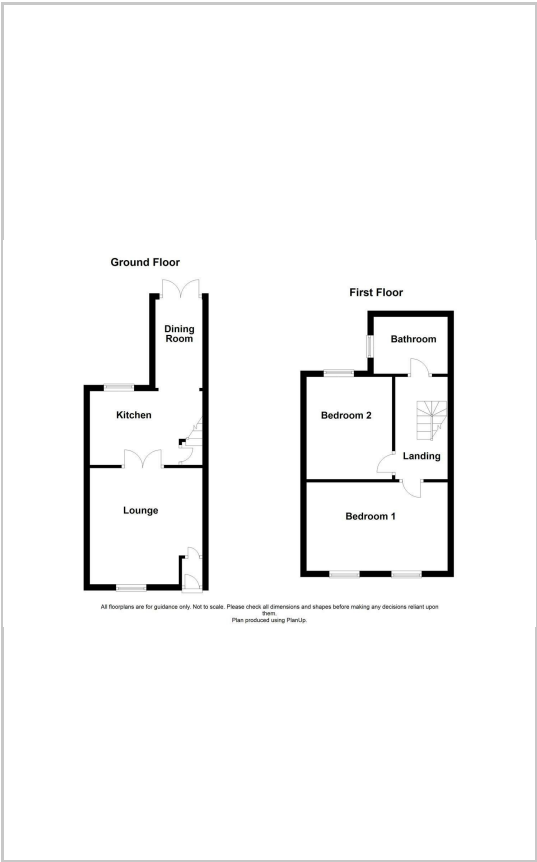

Energy Efficiency Graph

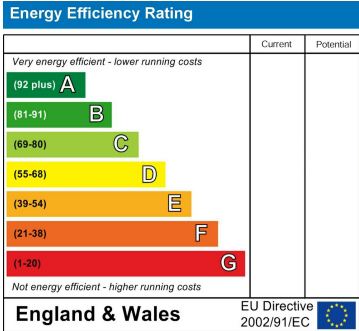

These particulars, whilst believed to be accurate are set out as a general outline only for guidance and do not constitute any part of an offer or contract. Intending purchasers should not rely on them as statements of representation of fact, but must satisfy themselves by inspection or otherwise as to their accuracy. No person in this firms employment has the authority to make or give any representation or warranty in respect of the property.