



Green Lane | Walsall | WS4 1RW

Asking Price £280,000



Summary

****HEAVILY EXTENDED TRADITIONAL THREE BEDROOM SEMI DETACHED HOME**UTILITY ROOM**RENOVATED THROUGHOUT**DRIVEWAY AND PORCH TO THE FRONT**REFITTED KITCHEN**LANDSCAPED REAR GARDEN**THREE GENEROUSLY SIZED BEDROOMS**REFITTED BATHROOM****

Welcome to this beautifully extended and improved three-bedroom semi-detached home on Green Lane, offering spacious and modern living while retaining its traditional charm.

The property is set back behind a walled, block-paved front garden, leading into a porch and welcoming entrance hall. To the front, a generously sized lounge features a well-in bay window, creating a bright and inviting space. Off the hallway, there is a separate utility room, adding practicality to the home. The rear of the property has been impressively extended, opening into an L-shaped kitchen diner. This stunning space boasts a refitted kitchen with modern fittings and patio doors that lead seamlessly to the rear garden, perfect for entertaining.

Upstairs, the first floor offers three generously sized bedrooms and a stylishly refitted family bathroom.

Key Features

- TRADITIONAL BAY FRONTED SEMI DETACHED HOME
- HEAVILY EXTENDED
- REFITTED OPEN PLAN KITCHEN DINING ROOM
- LANDSCAPED REAR GARDEN
- CLOSE TO ALL LOCAL AMENITIES
- THREE GENEROUS BEDROOMS
- IMPROVED THROUGHOUT
- SEPERATE UTILITY ROOM
- POPULAR LOCATION
- CALL WEBBS TODAY TO SECURE YOUR VIEWING OR FREE NO OBLIGATION VALUATION

Rooms and Dimensions

Identification Checks B

Porch

Entrance Hall

Lounge

14'8" x 12'5" (4.474m x 3.796m)

Dining Area

11'9" x 11'5" (3.599m x 3.504m)

Extended Kitchen

17'2" x 8'9" (5.233m x 2.676m)

Utility Room

7'8" x 6'4" (2.345m x 1.954m)

First Floor Landing

Bedroom One

12'5" x 11'9" (3.799m x 3.605m)

Bedroom Two

11'10" x 11'6" (3.622m x 3.517m)

Bedroom Three

8'11" x 7'9" (2.740m x 2.387m)

Family Bathroom

7'10" x 5'8" (2.399m x 1.740m)





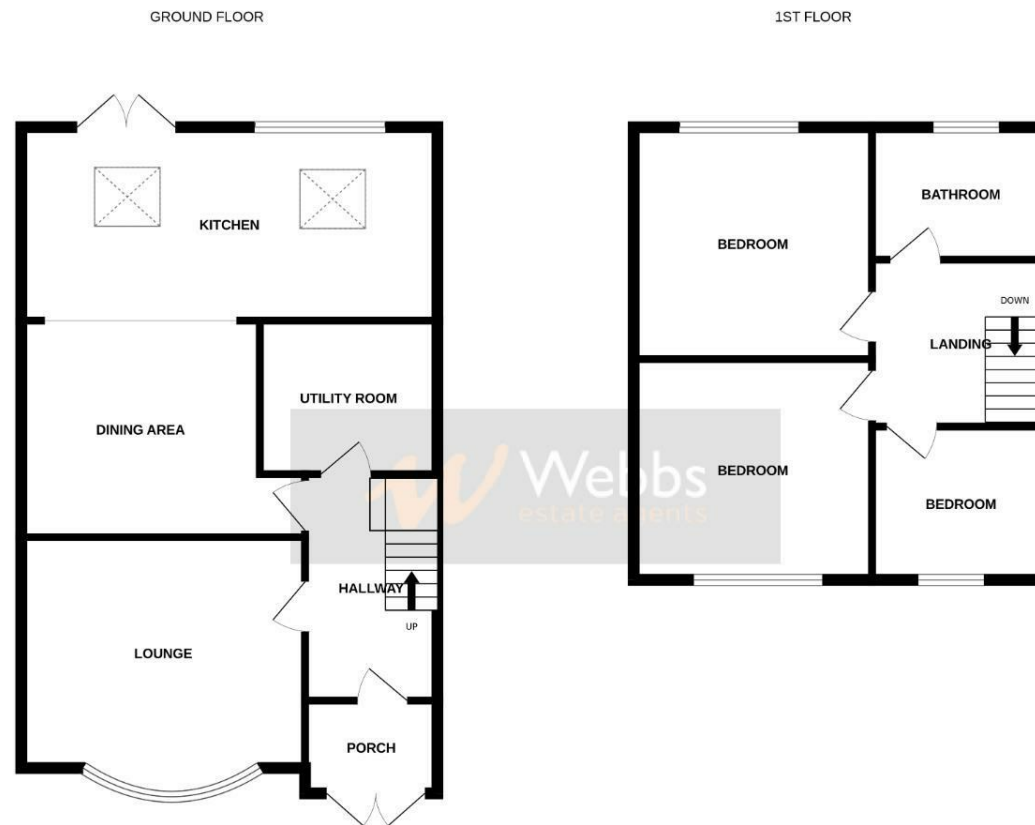

Whilst every attempt has been made to ensure the accuracy of the floorplans contained here, measurements of doors, windows, rooms and any other items are approximate and no responsibility is taken for any error, omission or mis-statement. This plan is for illustrative purposes only and should be used as such by any prospective purchaser. The services, systems and appliances shown have not been tested and no guarantee as to their operability or efficiency can be given.
Made with Metropix ©2025

Webbs Estate Agents - endeavour to maintain accurate depictions of properties in Virtual Tours, Floor Plans and descriptions, however, these are intended only as a guide and purchasers must satisfy themselves by personal inspection.

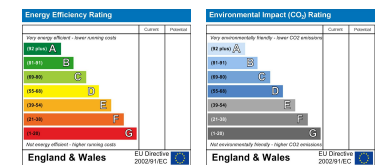

28 High Street, Aldridge, Walsall, WS9 8LZ

Tel: 01922 288800 | Email: aldridge@webbestateagents.co.uk | www.webbestateagents.co.uk

