



Twyford Close | Walsall | WS9 0SN

£220,000

 **Webbs**
estate agents

Summary

**** MID TERRACE BUNGALOW ** DESIRABLE LOCATION ** RETIREMENT DEVELOPMENT ** QUIET CUL DE SAC ** CLOSE TO AMENITIES AND SHOPS
** DECEPTIVELY SPACIOUS AND WELL MAINTAINED ** TWO GOOD SIZED BEDROOMS ** SHOWER ROOM/WC ** LARGE MAIN LIVING ROOM **
KITCHEN ** COMMUNAL GARDENS AND PARKING ** DOUBLE GLAZING ** ELECTRIC CENTRAL HEATING ** EARLY VIEWING ADVISED ****

Webbs Estate Agents have pleasure in offering this very well maintained mid terrace bungalow, set in a quiet cul-de-sac and situated in a desirable and convenient location, being close to all local amenities and shops. Briefly comprising : Reception porch , kitchen , living room, two good sized double bedrooms and a shower room/WC. Externally there are communal gardens and parking. For a viewing please call our Aldridge branch on 01922 288800.

Key Features

- QUIET CUL-DE-SAC LOCATION
- RETIREMENT DEVELOPMENT
- 2 BEDROOMS
- KITCHEN
- COMMUNAL GARDEN & PARKING
- CLOSE TO AMENITIES
- MID TERRACE BUNGALOW
- LIVING ROOM
- BATHROOM
- EARLY VIEWING ADVISED

Rooms and Dimensions

ENTRANCE PORCH

LIVING ROOM

19'4" x 9'9" (5.9 x 2.99)

KITCHEN

9'7" x 8'11" (2.93 x 2.73)

INNER LOBBY

BEDROOM ONE

13'7" x 8'5" (4.15 x 2.57)

BEDROOM TWO

10'2" x 9'4" (3.1 x 2.87)

BATHROOM

6'0" x 7'3" (1.84 x 2.23)

OUTSIDE

Identification Checks





GROUND FLOOR

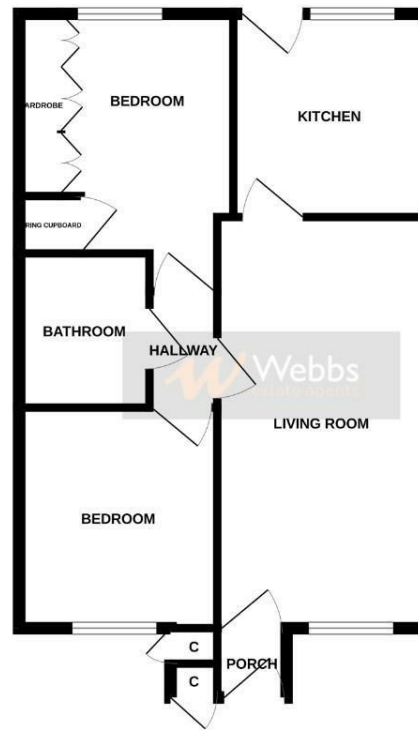

Whilst every attempt has been made to ensure the accuracy of the floorplan contained here, measurements of doors, windows, rooms and any other items are approximate and no responsibility is taken for any error, omission or mis-statement. This plan is for illustrative purposes only and should be used as such by any prospective purchaser. The services, systems and appliances shown have not been tested and no guarantee as to their operability or efficiency can be given.
Made with floorplan 6/2025

Webbs Estate Agents - endeavour to maintain accurate depictions of properties in Virtual Tours, Floor Plans and descriptions, however, these are intended only as a guide and purchasers must satisfy themselves by personal inspection.

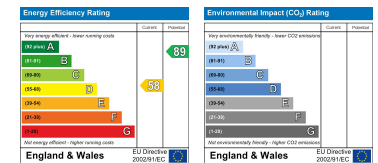

28 High Street, Aldridge, Walsall, WS9 8LZ

Tel: 01922 288800 | Email: aldridge@webbestateagents.co.uk | www.webbestateagents.co.uk

