



**Barrow Close | Aldridge, Walsall | WS9 9BS**

**Asking Price £129,950**



## Summary

Perfect for First Time Buyers or Investors.

Webbs Estate Agents are thrilled to bring to the sales market, this rather lovely and very substantial two bedroom apartment located in a fantastic cul de sac in Walsall Wood. Barrow Close is a development of modern houses and apartments and is situated close to all local amenities including some great schools, shops, supermarkets and restaurants.

Internally we can offer a hallway, a great size lounge diner, kitchen, two double bedrooms and a family bathroom. Externally we have a private parking space plus plenty of visitor spaces along with some green areas to act as communal gardens.

**\*\*GOOD SIZE TWO BEDROOM APARTMENT\*\* \*\*MODERN DEVELOPMENT IN WALSALL WOOD\*\***

**\*\*CALL WEBBS TODAY\*\***

## Key Features

- FIRST FLOOR APARTMENT
- TWO BEDROOMS
- JULIET BALCONY
- PRIVATE PARKING
- COMMUNAL GROUNDS
- MODERN
- LARGE LOUNGE DINER
- NO CHAIN
- PLUS VISITOR PARKING
- WALSALL WOOD LOCATION

## Rooms and Dimensions

### COMMUNAL HALLWAY

### ENTRANCE HALLWAY

### LOUNGE DINER

16'4 x 11'6 (4.98m x 3.51m)

### KITCHEN

7'6 x 7'6 (2.29m x 2.29m )

### BEDROOM ONE

10'5 x 9'2 (3.18m x 2.79m)

### BEDROOM TWO

7'6 x 7'2 (2.29m x 2.18m)

### FAMILY BATHROOM

### ALLOCATED PARKING PLUS VISITORS SPACES

### OUTSIDE GREEN AREAS

### Material Information - WL

### Identification Checks





# GROUND FLOOR

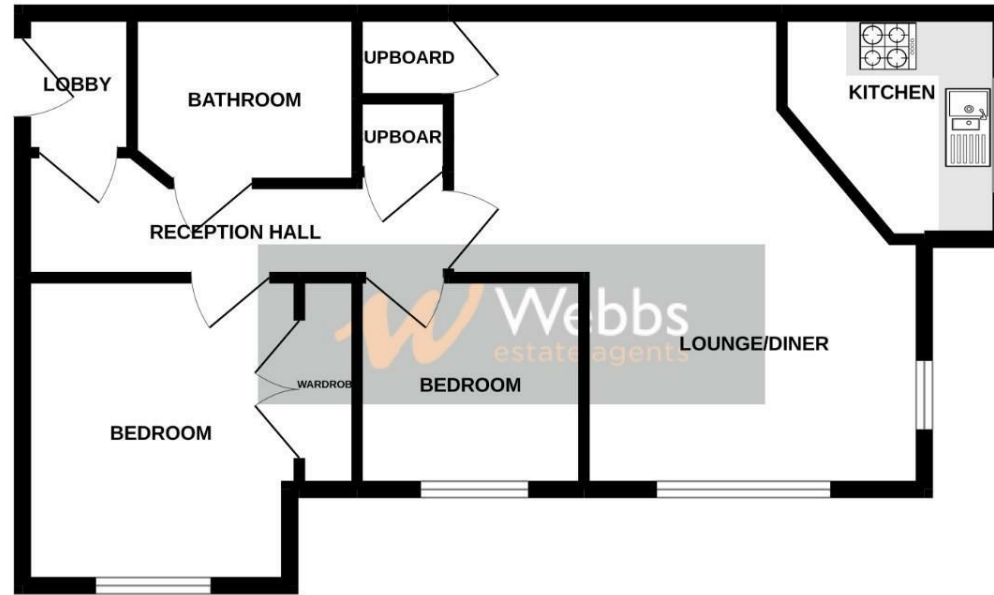

Whilst every attempt has been made to ensure the accuracy of the floorplan contained here, measurements of doors, windows, rooms and any other items are approximate and no responsibility is taken for any error, omission or mis-statement. This plan is for illustrative purposes only and should be used as such by any prospective purchaser. The services, systems and appliances shown have not been tested and no guarantee as to their operability or efficiency can be given.  
 Made with Metropix 62022

Webbs Estate Agents - endeavour to maintain accurate depictions of properties in Virtual Tours, Floor Plans and descriptions, however, these are intended only as a guide and purchasers must satisfy themselves by personal inspection.

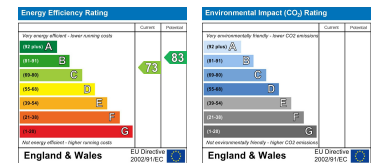

28 High Street, Aldridge, Walsall, WS9 8LZ

Tel: 01922 288800 | Email: [aldridge@webbestateagents.co.uk](mailto:aldridge@webbestateagents.co.uk) | [www.webbestateagents.co.uk](http://www.webbestateagents.co.uk)

