

Woodend Road, Woolwell, Plymouth, PL6

£190,000

 2  1  1



Key Features

- Well Presented Two Bedroom Terraced House
- Spacious Lounge / Diner
- Allocated Parking
- Perfect First Time Buy
- Council Tax Band B EPC Grade C
- Sought After Location of Woolwell
- Enclosed Rear Garden
- Two Double Bedrooms
- Great Rental Investment Potential
- Viewing Highly Recommended

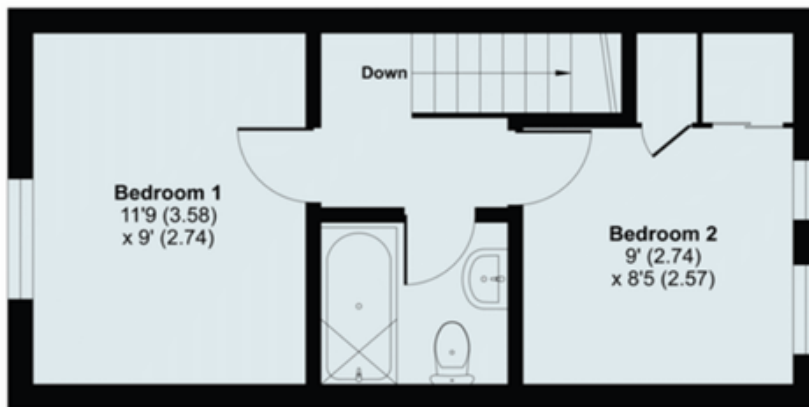

FIRST FLOOR



GROUND FLOOR

