



View Farm, Caxton End, Bourn, Cambridge



View Farm, Bourn, Cambridgeshire, CB23 2SS

Knight Frank are pleased to offer this truly unique country home set in enviable gardens and grounds in excess of 2 acres.

Bourn is an attractive west Cambridgeshire village with a good range of local facilities, including a post office/shop, church, hairdressers, cafe, two public houses/restaurants, and a primary school rated as outstanding by Ofsted. Cambridge Country Club (formerly Bourn Golf and Country Club) is a luxurious new complex, offering a wellness centre, gym, luxury spa, swimming pool, and a bar and restaurant with views over the well-established 18-hole golf course.



Guide price: £1,250,000

Tenure: Available freehold

Local authority: South Cambridgeshire District Council

Council tax band: G

Services: Mains water, electricity and drainage. Oil fired central heating.

Elevated gracefully beneath a pitched tile and slate roof, View Farm is a charmingly presented period family residence featuring characterful accommodation and modern enhancements, notably highlighted by its contemporary, architecturally designed extension.

Upon entering, you are welcomed into a spacious hall that serves as the central hub connecting the original and new sections seamlessly.

Turning left from the entrance hall leads you to the original cottage, where the dining room takes centre stage around an inset wood burner. A spiral staircase leads to a mezzanine level, currently used as a study. Continuing from the dining room is a sitting room featuring a striking inglenook fireplace with a wood burner and stairs leading to the guest bedroom, equipped with a cloakroom and built-in wardrobes. Flowing from the sitting room is the sun room, providing captivating views over the gardens and direct access to the rear patio. The sitting room also grants access to the wine cellar. The centrally positioned kitchen comprises wall and base cabinetry, with a mono-pitched ceiling with roof lights and Velfac windows offering picturesque views onto the paved patio and gardens beyond.





A glazed corridor, with a utility room and cloakroom, leads to the single storey barn with four bedrooms and a family bathroom. The principal bedroom suite is vaulted, creating a spacious feel, and features built-in wardrobes and an en suite bathroom. Two bedrooms offer a unique living space, featuring a small living/study area on the ground floor and a mezzanine sleeping level accessible via a ladder.





A blend of period
and modern styling

Gardens and Grounds

The property encompasses front and rear gardens spanning just over two acres. A private gravel driveway provides ample parking, leading to a substantial open fronted garage with a studio/office above, accessed via a rear staircase. A further 5-bar gate to one side gives vehicle access to the side of the rear plot and gardens if required. A neighbour has agricultural access only to a meadow backing on to View Farm.

The expansive patio area from the rear serves as an ideal outdoor entertaining space, enclosed by raised beds and featuring an ornamental fish pond. Steps lead to the extensive lawned area with herbaceous borders, mature trees, and another pond. The gardens also contain a generous workshop with light and power adjacent to the growing area with three greenhouses, raised and covered beds, and a potting shed. At the top of the garden is extensive storage, including a seven-bay wood store area, a separate three-bay unit, which stores a trailer and lawn mower with additional storage and access to the meadow beyond.



Approximate Gross Internal Floor Area: 282.8 sq m / 3044.5 sq ft
Garage: 19.5 sq m / 210 sq ft
External Stores: 0.9 sq m / 10 sq ft

This plan is for guidance only and must not be relied upon as a statement of fact. Attention is drawn to the important notice on the last page of the text of the Particulars.

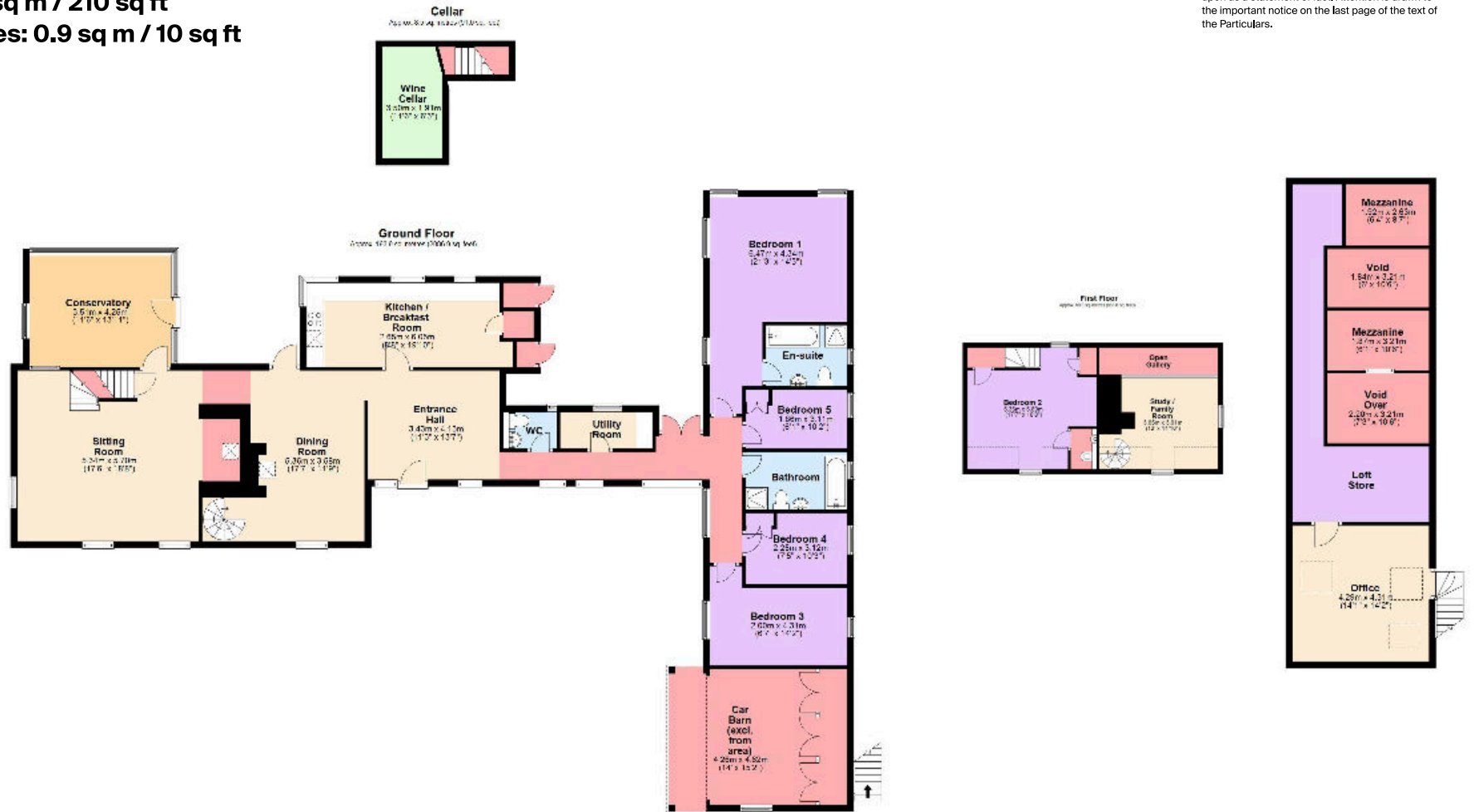

Knight Frank
 Cambridge
 20 Station Road
 Cambridge
 CB1 2JD
knightfrank.co.uk

I would be delighted to tell you more
Michael Houlden
 01223 972911
michael.houlden@knightfrank.com



Fixtures and fittings: A list of the fitted carpets, curtains, light fittings and other items fixed to the property which are included in the sale (or may be available by separate negotiation) will be provided by the Seller's Solicitors.

Important Notice: 1. Particulars: These particulars are not an offer or contract, nor part of one. You should not rely on statements by Knight Frank LLP in the particulars or by word of mouth or in writing ("information") as being factually accurate about the property, its condition or its value. Neither Knight Frank LLP nor any joint agent has any authority to make any representations about the property, and accordingly any information given is entirely without responsibility on the part of the agents, seller(s) or lessor(s). 2. Photos, Videos etc: The photographs, property videos and virtual viewings etc. show only certain parts of the property as they appeared at the time they were taken. Areas, measurements and distances given are approximate only. 3. Regulations etc: Any reference to alterations to, or use of, any part of the property does not mean that any necessary planning, building regulations or other consent has been obtained. A buyer or lessee must find out by inspection or in other ways that these matters have been properly dealt with and that all information is correct. 4. VAT: The VAT position relating to the property may change without notice. 5. To find out how we process Personal Data, please refer to our Group Privacy Statement and other notices at <https://www.knightfrank.com/legals/privacy-statement>. Particulars dated Summer 2023/January 2024. Photographs and videos dated Summer 2023/January 2024.

Knight Frank is the trading name of Knight Frank LLP. Knight Frank LLP is a limited liability partnership registered in England and Wales with registered number OC305934. Our registered office is at 55 Baker Street, London W1U 8AN where you may look at a list of members' names. If we use the term 'partner' when referring to one of our representatives, that person will either be a member, employee, worker or consultant of Knight Frank LLP and not a partner in a partnership. If you do not want us to contact you further about our services then please contact us by either calling 020 3544 0692, email to marketing.help@knightfrank.com or post to our UK Residential Marketing Manager at our registered office (above) providing your name and address.