



# Abbots Drive

WENTWORTH • £5,000,000



Discover unparalleled elegance in this detached house on Abbots Drive, Wentworth. With five bedrooms, six bathrooms, and spacious living areas, this property offers an exceptional lifestyle.

## DESCRIPTION

This premium detached house is located on Abbots Drive situated within the prestigious Wentworth estate. With a generous build area of 7,902 Sq. Ft, this freehold property provides ample space for luxurious living. The residence includes five bedrooms and six bathrooms, ensuring comfort and privacy for all residents.

Wentworth is known for its exclusivity and charm, making it a coveted location for discerning buyers. The area is home to beautiful parks and green spaces, offering a serene environment. Residents can also enjoy convenient access to nearby transport links and amenities.

The property features a spacious garage, and gated drive way providing secure parking and additional storage space. The layout is designed to accommodate modern living with expansive rooms and high-quality finishes throughout. This luxury home represents an opportunity for those seeking an exceptional lifestyle on one of the UK's most prestigious gated estates.

## TERMS

**Price:** £5,000,000

**Tenure:** Freehold

**Ground Rent:**

**Service Charge:**

**Local Authority:** Runnymede

**Council Tax:** H

**Energy Rating:** 79.00















## Abbots Drive, Wentworth Estate

Approximate Gross Internal Area = 734 sq m / 7902 sq ft

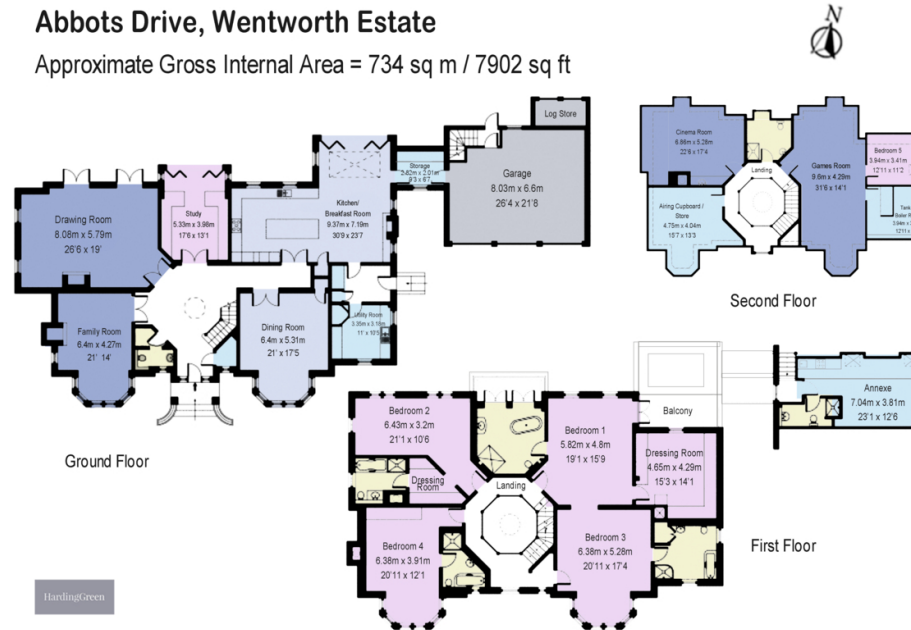

Floor Plan measurements are approximate and are for illustrative purposes only. While we do not doubt the floor plans accuracy, we make no guarantee, warranty or representation as to the accuracy and completeness of the floor plan.



**Jack Graham-Lindsey**

Partner

0207 046 9464

jack.graham-lindsey@hardinggreen.com

Important Notice. We would like to inform prospective purchasers that these sales particulars have been prepared as a general guide only. A detailed survey has not been carried out, nor the services, appliances and fittings tested. Room sizes should not be relied upon for furnishing purposes and are approximate. If floor plans are included, they are for guidance only and illustration purposes only and may not be to scale. If there are any important matters likely to affect your decision to buy, please contact us before viewing the property.



FIND OUT MORE