



Chippenham Mews

• OFFERS IN EXCESS OF £1,000,000

- Mews House
- Freehold Property
- Great W9 Location
- Development Opportunity





A rare development opportunity for a freehold mews house in W9 (subject to planning)

DESCRIPTION

A gem of a freehold mews house in the heart of Maida Hill area. The property is currently arranged over two floors with double garage and workspace across the whole of the ground floor. The first floor comprises of one double bedroom, kitchen, bathroom, spacious reception. The property could be developed into a dream freehold home of c1500sqft of flexible living space arranged over three floors (subject to planning)

Chippenham Mews is a one-way street connecting Marylands Road with Chippenham Road. Located in Maida Hill a short walk from the heart of Maida Vale to the north and only a few minutes' walk to the grand union canal and Notting Hill to the south, which offer up a great mix of shops, cafes, and restaurants.

Transport links can be found at either Royal Oak and Westbourne Park (Circle Line and Hammersmith & City line) both stations are only 12 minutes' walk away.

TERMS

Price: Offers In Excess Of £1,000,000

Tenure: Freehold

Ground Rent: N/A

Service Charge: N/A

Local Authority: Westminster

Chippenham Mews, W9
Approx. Gross Internal Area *
1091 Ft² - 101.35 M²
(Including Garage/ Workshop)

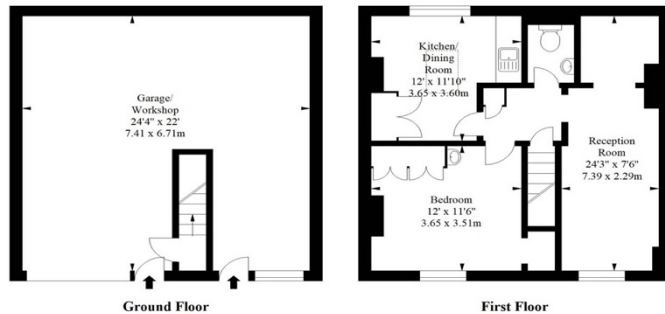

Illustration For Identification Purposes Only. Not To Scale

* As Defined by RICS - Code of Measuring Practice
© International Floorplans.
Tel 0094 115 345958
www.ifpLk



FIND OUT MORE



Noah Pearlman MNAEA
Consultant

020 8187 4836

noah.pearlman@hardinggreen.com

Important Notice. We would like to inform prospective purchasers that these sales particulars have been prepared as a general guide only. A detailed survey has not been carried out, nor the services, appliances and fittings tested. Room sizes should not be relied upon for furnishing purposes and are approximate. If floor plans are included, they are for guidance only and illustration purposes only and may not be to scale. If there are any important matters likely to affect your decision to buy, please contact us before viewing the property.