



enfields

Enfields Hythe  
5 Marsh Parade,  
Hythe, Hampshire,  
GU98 0JN  
023 8084 9210  
sales-hythe@enfields.co.uk

# 8 Hillview Road, Hythe, Southampton, SO45 5GL

Guide Price £380,000

3 1 2



- Three Bedrooms
- Kitchen/Breakfast Room
- Bathroom with Four Piece Suite
- Driveway Parking for Multiple Vehicles
- Lounge
- Conservatory
- Enclosed Rear Garden
- No Onward Chain



With no onward chain, Enfields Hythe are pleased to market this three bedroom detached bungalow situated within the preferred location of Hollybank in Hythe.

The accommodation on offer comprises of an entrance hall, lounge, fitted kitchen/breakfast room, conservatory, three bedrooms and bathroom.

With brick wall to the front boundary, the front garden is laid to lawn with mature bushes. The block paved driveway leads to the side of the home with parking for multiple vehicles leading to a single garage.

This home falls within Hythe Primary School and Noadswood School catchment areas.

The Local Authority is New Forest District Council. The Council Tax Band is D.

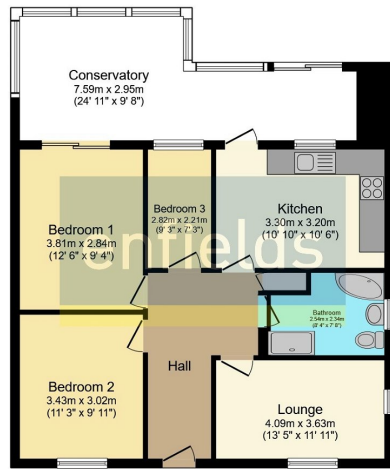

Floor Plan

This plan is for illustration purposes only and may not be representative of the property. Plan not to scale.

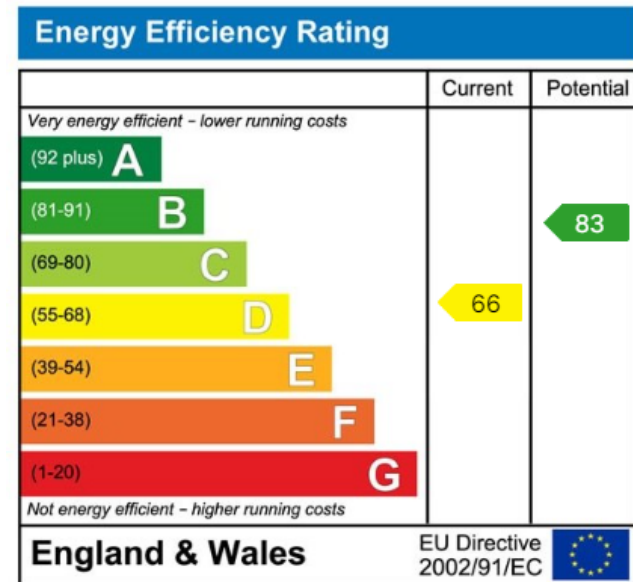

[www.enfields-southampton.co.uk](http://www.enfields-southampton.co.uk)



It is Enfields policy to respect any sole agency currently in force and we would not be able to commence marketing until this has expired or been terminated. If you fail to terminate any previous agreement you could be liable for two sets of fees. Enfields Hythe is a trading name of YTF LTD Registered office: 345 Shirley Road, Southampton, Hampshire, England, SO15 3JD. Company Registration No: 10459987. VAT Registration No: 281 2975 81.

Enfields Lettings - Embley Management LTD T/A Enfields. Registered Address: 345 Shirley Road, Southampton, Hampshire, England, SO15 3JD. Company Registration No: 14847604. VAT Registration No: 439 8546 45.