



enfields

Enfields Hythe
3 Marsh Parade,
Hythe, Southampton,
Hampshire, SO45 6AN
T 023 8084 9210
E sales-hythe@enfields.co.uk

50 Hillview Road, Hythe

Offers In Region Of £375,000

3 1 1



- Spacious lounge with log burner and bi-fold doors to garden
- Modern 4 piece family bathroom
- Separate utility room
- Recently installed combi boiler
- Planning Permission for a rear extension
- Ample off road parking and garage
- UPVC double glazing
- Great location



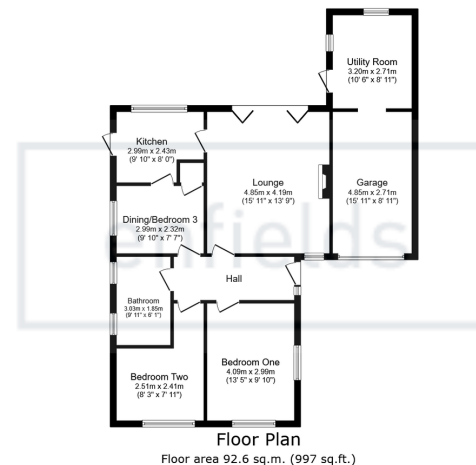

Total floor area: 92.6 sq.m. (997 sq.ft.)

This floor plan is for illustrative purposes only. It is not drawn to scale. Any measurements, floor areas (including any total floor area), openings and orientations are approximate. No details are guaranteed, they cannot be relied upon for any purpose and do not form any part of any agreement. No liability is taken for any error, omission or misstatement. A party must rely upon its own inspection(s). Powered by www.Propertybox.io



Situated in a popular location, this detached bungalow offers flexible accommodation and has Planning Permission in place for a rear extension. The spacious lounge features a log burner and bi-fold doors which lead into the enclosed rear garden, and the modern bathroom has a walk-in shower cubicle in addition to the bath. To the front of the property you will find driveway parking and a single garage.

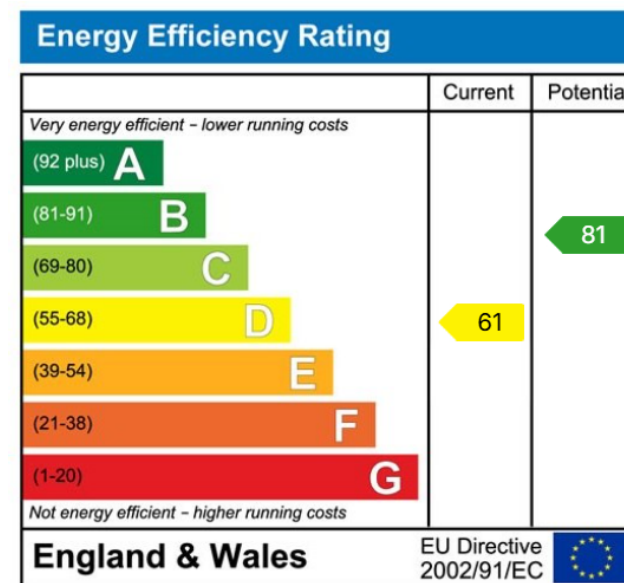

www.enfields-southampton.co.uk

It is Enfields policy to respect any sole agency currently in force and we would not be able to commence marketing until this has expired or been terminated. If you fail to terminate any previous agreement you could be liable for two sets of fees. Enfields Hythe is a trading name of YTF LTD Registered office: 345 Shirley Road, Southampton, Hampshire, England, SO15 3JD. Company Registration No: 10459987. VAT Registration No: 281 2975 81.

Enfields Lettings - Embley Management LTD T/A Enfields. Registered Address: 345 Shirley Road, Southampton, Hampshire, England, SO15 3JD. Company Registration No: 14847604. VAT Registration No: 439 8546 45.

