



Enfields Hythe
3 Marsh Parade,
Hythe, Southampton,
Hampshire, SO45 6AN
T 023 8084 9210
E sales-hythe@enfields.co.uk

Fern Road, Hollybank, SO45 5EE

Guide Price £225,000

🛏️ 2 🚿 1 🚗 1



This property is available with no onward chain and features two spacious double bedrooms, a comfortable lounge/diner, and a contemporary fitted kitchen. The bathroom includes a stylish three-piece white suite. Additional highlights include double glazing and gas central heating for your comfort.

Outside, you'll find an enclosed rear garden, perfect for relaxation, laid to lawn. The home also comes with a garage located in a nearby block.

Remaining Lease Length: 964 Years



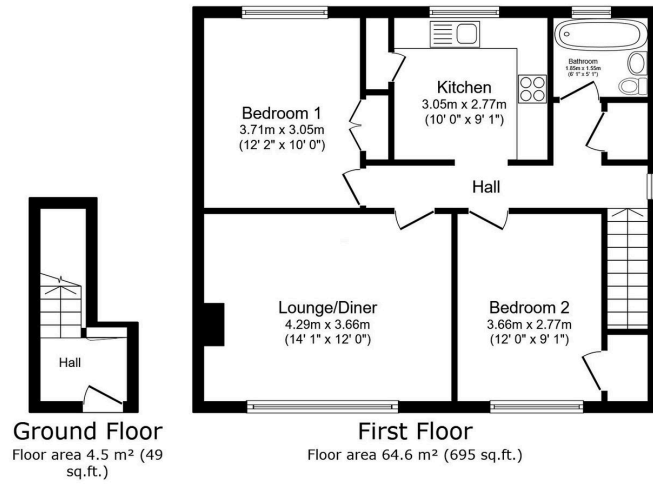

This floor plan is for illustrative purposes only. It is not drawn to scale. Any measurements, floor areas (including any total floor area), openings and orientations are approximate. No details are guaranteed, they cannot be relied upon for any purpose and do not form any part of any agreement. No liability is taken for any error, omission or misstatement. A party must rely upon its own inspection(s). Powered by www.Propertybox.co.uk

- No Forward Chain
- Two Double Bedrooms
- Garage Situated In a Nearby Block
- Long Lease Of 964 Years
- Popular Location
- Lounge/Diner
- Modern Fitted White Bathroom Suite
- Own Private Garden
- First Floor
- Viewing Highly Recommended

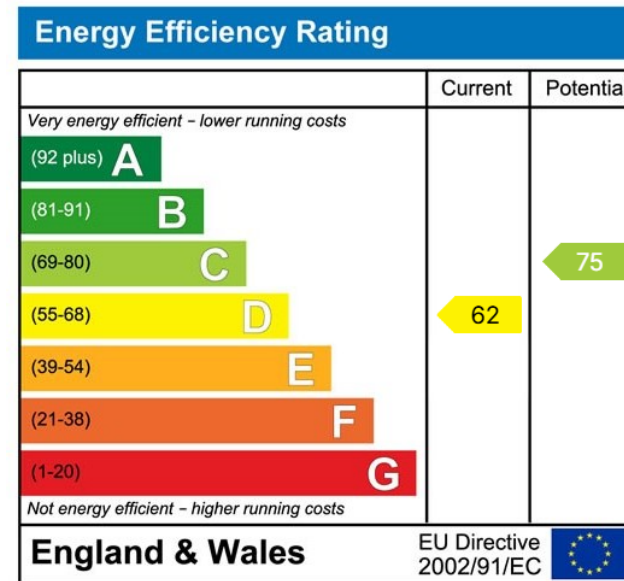

www.enfields-southampton.co.uk



It is Enfields policy to respect any sole agency currently in force and we would not be able to commence marketing until this has expired or been terminated. If you fail to terminate any previous agreement you could be liable for two sets of fees. Enfields Hythe is a trading name of YTF LTD Registered office: 345 Shirley Road, Southampton, Hampshire, England, SO15 3JD. Company Registration No: 10459987. VAT Registration No: 281 2975 81.

Enfields Lettings - Embley Management LTD T/A Enfields. Registered Address: 345 Shirley Road, Southampton, Hampshire, England, SO15 3JD. Company Registration No: 14847604. VAT Registration No: 439 8546 45.