



enfields

Enfields Hythe
3 Marsh Parade,
Hythe, Southampton,
Hampshire, SO45 6AN
T 023 8084 9210
E sales-hythe@enfields.co.uk

106 Cumberland Way, Dibden

From £230,000

🛏️ 2 🪑 1 🚗 1



- Immediate 'Exchange Of Contracts' Available
- Two Double Bedrooms
- Driveway Parking
- Private Rear Garden
- No Forward Chain
- Sold Via 'Secure Sale'
- Semi Detached House
- Modern Kitchen
- Modern Bathroom
- Popular Location



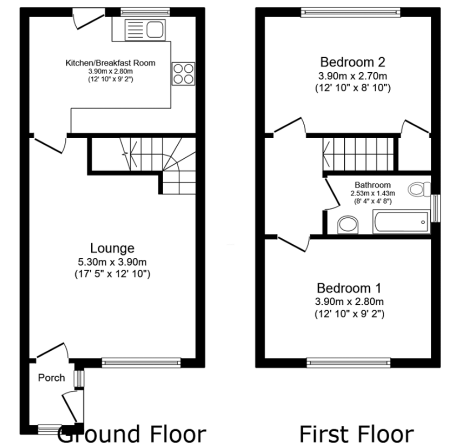

Ground Floor Floor area 34.6 m² (372 sq.ft.) First Floor Floor area 32.8 m² (353 sq.ft.)

TOTAL: 67.4 m² (725 sq.ft.)

This floor plan is for illustrative purposes only. It is not drawn to scale. Any measurements, floor areas (including any total floor area), openings and orientations are approximate. No details are guaranteed, they cannot be relied upon for any purpose and do not form any part of any agreement. No liability is taken for any error, omission or misstatement. A party must rely upon its own inspection(s). Powered by www.Property24.co

Being sold via Secure Sale online bidding. Terms & Conditions apply. Starting Bid £230,000. This property will be legally prepared enabling any interested buyer to secure the property immediately once their bid/offer has been accepted. Ultimately a transparent process which provides speed, security and certainty for all parties.

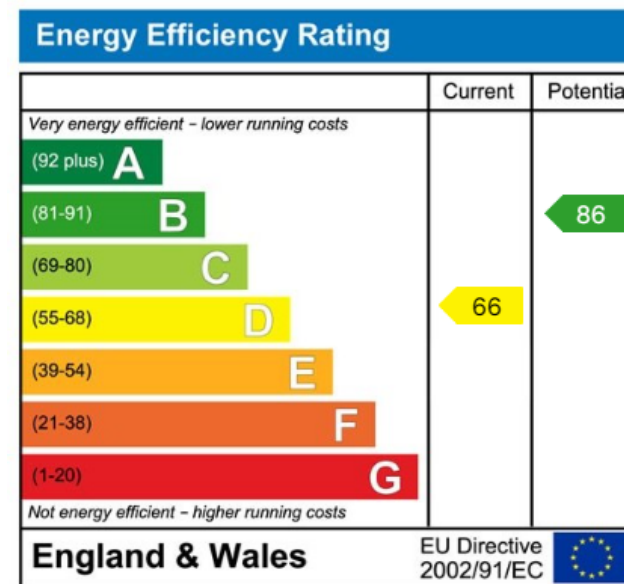

www.enfields-southampton.co.uk



It is Enfields policy to respect any sole agency currently in force and we would not be able to commence marketing until this has expired or been terminated. If you fail to terminate any previous agreement you could be liable for two sets of fees. Enfields Hythe is a trading name of YTF LTD Registered office: 345 Shirley Road, Southampton, Hampshire, England, SO15 3JD. Company Registration No: 10459987. VAT Registration No: 281 2975 81.

Enfields Lettings - Embley Management LTD T/A Enfields. Registered Address: 345 Shirley Road, Southampton, Hampshire, England, SO15 3JD. Company Registration No: 14847604. VAT Registration No: 439 8546 45.

