



Adderley Street, Uppingham

A charming stone character cottage situated at the end of a cul-de-sac close to Uppingham town centre, idea FTB or investment offered to the market with no onward chain.



FEATURES

- NO ONWARD CHAIN
- Great Location
- South facing enclosed garden
- Two bedrooms
- Inglenook fireplace with feature log burner
- Walking distance to amenities
- Charming stone character cottage.



ACCOMMODATION

Accommodation comprises; Living room complete with inglenook fireplace with feature log burner leading into the kitchen with storage cupboard. A spiral staircase brings you up to the first floor with a double bedroom, a single bedroom and a family bathroom.

Externally is an enclosed south facing garden with lawn and patio area, a pathway leading to the front door, original flag stones forming a patio area and a pathway to the shed. There are areas of garden to either side and walling.

To book a viewing call our area experts

www.mooresestateagents.com

Moore's Property Hub 01572 757979 | Moore's Move to the Country 020 301 11361
 Melton 01664 491610 | Uppingham 01572 821935 | Stamford 01780 484555
 Grantham Meet & Greet 01476 855618 | Peterborough Meet & Greet 01733 788888
 A1 Meet & Greet Stoke Rochford | office@mooresestateagents.com



EXTERNAL

Uppingham is a highly desirable and historic Market Town with a range of boutique shops and restaurants surrounding the quaint market square and adjoining high street. There are excellent Primary and Secondary schools in the area. The town is conveniently located close to the A47, giving access to Leicester and Peterborough. Mainline trains into London and the North can be reached from Peterborough, Leicester, Rutland and Kettering.



To book a viewing call our area experts

www.mooresestateagents.com

Moore's Property Hub 01572 757979 | Moore's Move to the Country 020 301 11361
 Melton 01664 491610 | Uppingham 01572 821935 | Stamford 01780 484555
 Grantham Meet & Greet 01476 855618 | Peterborough Meet & Greet 01733 788888
 A1 Meet & Greet Stoke Rochford | office@mooresestateagents.com

Ground Floor

Approx. 25.2 sq. metres (270.8 sq. feet)

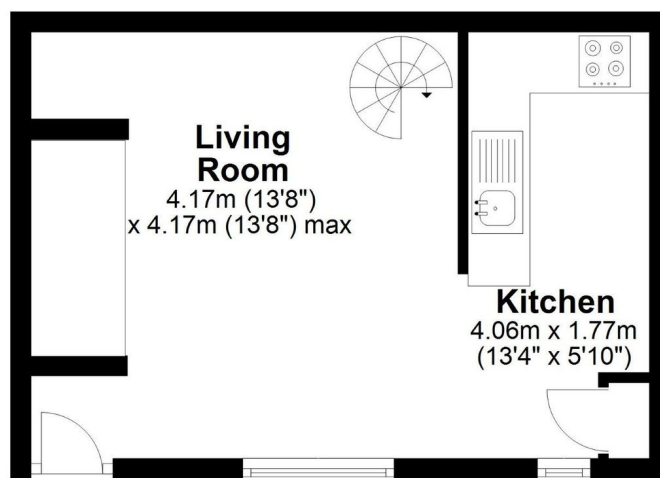

First Floor

Approx. 25.8 sq. metres (278.0 sq. feet)



Total area: approx. 51.0 sq. metres (548.9 sq. feet)

This floor plan is not to scale. They are for guidance only and accuracy is not guaranteed. Plan was produced by ADR Energy Assessors
Plan produced using PlanUp.

EPC RATING

	Current	Potential
Very energy efficient – lower running costs		
(92 plus) A		92
(81-91) B		
(69-80) C		
(55-68) D	64	
(39-54) E		
(21-38) F		
(1-20) G		
Not energy efficient – higher running costs		

To book a viewing call our area experts:

Moore's Property Hub	01572 757979
Moore's Move to the Country	020 301 11361
Melton	01664 491610
Uppingham	01572 821935
Stamford	01780 484555
Grantham Meet & Greet	01476 855618
Peterborough Meet & Greet	01733 788888
A1 Meet & Greet Stoke Rochford	

Follow us for Property Updates



@mooresestateagents



@mooresestatepropertyhub

For short, informative videos on our areas, please click here: <https://mooresestateagents.com/minute-guides/>

Moore V Ltd trading as Moore's Estate Agents gives notice that: 1. These particulars do not constitute an offer or contract or part thereof. 2. All descriptions, photographs and plans are for guidance only and should not be relied upon as statements or representations of fact. All measurements are approximate and not necessarily to scale. Any prospective purchaser must satisfy themselves of the correctness of the information within the particulars by inspection or otherwise. 3. Moore V Ltd trading as Moore's Estate Agents does not have any authority to give any representations or warranties whatsoever in relation to this property (including but not limited to planning/building regulations), nor can it enter into any contract on behalf of the Vendor. 4. Moore V Ltd trading as Moore's Estate Agents does not accept responsibility for any expenses incurred by prospective purchasers in inspecting properties which have been sold, let or withdrawn. 5. If there is anything of particular importance to you, please contact this office and we will try to have the information checked for you.