



**Granby Lane, Plungar**

Notttingham, NG13 0JJ

**Five bedroom Detached Property**



## Granby Lane, Plungar

Nottingham, NG13 0JJ

Five bedroom Detached Property

### Features

Individually Designed

Five Bedrooms

Recently Refurbished

Kitchen/Diner

Master Bedroom With Ensuite

Generous Sized Landscaped Garden

Alfresco Kitchen

Outdoor Sauna

Village Location

Individually designed and built quality home having attractive stone features. This property has recently undergone a full restoration and refurbishment and is now excellently presented both inside and out.

Ground floor comprises; Entrance porch, W/C, hand build kitchen/diner with island and bifold doors to patio area. Utility, living room with feature log burner, family room, refitted family bathroom and two bedrooms lending itself to flexible living as one is currently used as an office.

The first floor comprises; Master bedroom with ensuite, two further bedrooms and a refitted family bathroom, one bedroom currently being used as a cinema / bar.

The property is accessed via a five bar double gate with a large driveway providing ample off road parking including a double garage looking onto neighbouring paddocks. To the rear is a generous sized landscaped garden with multiple seating areas, including a covered alfresco kitchen set up , sauna and play area. All fully enclosed, mainly laid to lawn with trees and shrub borders.

Plungar is a well thought of village in the Melton district of Leicestershire , England. It is about 9 miles north of the market town of Melton Mowbray and 7 miles west from Grantham. Plungar is adjacent to the Grantham Canal and stands in the Vale of Belvoir.



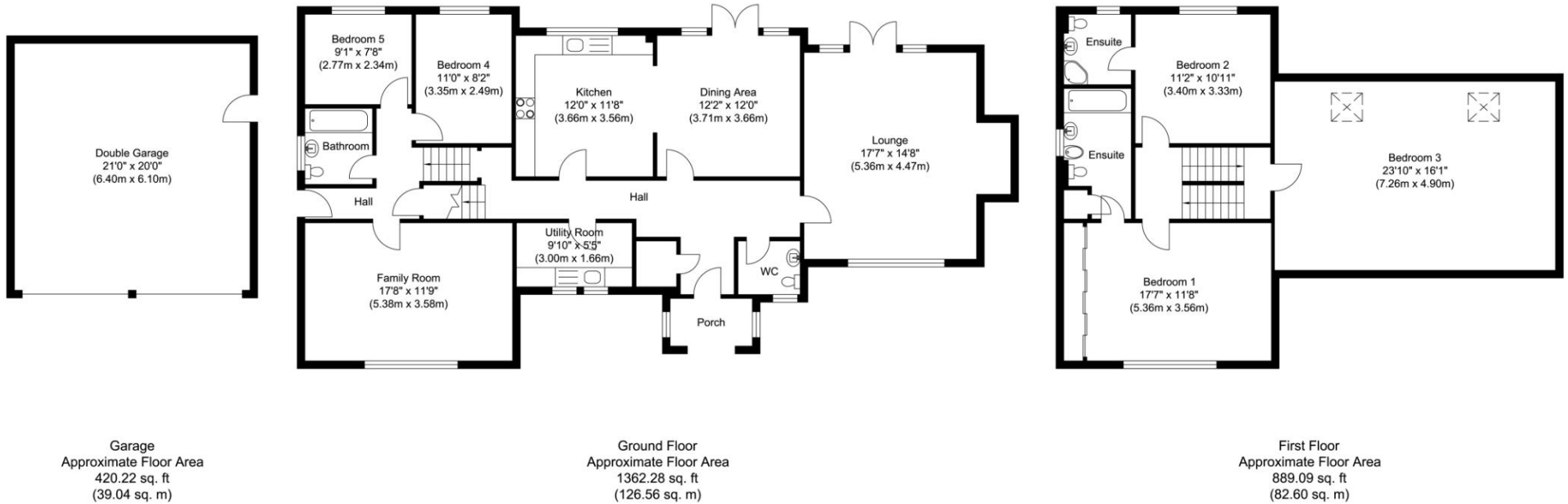

Illustration for identification purposes only, measurements are approximate, not to scale.



Moores Property Hub 01572 757979 | Uppingham 01572 821935 | Stamford 01780 484555 | Melton 01664 491610  
 Peterborough Meet & Greet 01733 788888 | Grantham Meet & Greet 01476 855618 | A1 Meet & Greet Stoke Rochford  
 office@mooresestateagents.com | www.mooresestateagents.com

Moore V Ltd trading as Moores Estate Agents gives notice that: 1. These particulars do not constitute an offer or contract or part thereof. 2. All descriptions, photographs and plans are for guidance only and should not be relied upon as statements or representations of fact. All measurements are approximate and not necessarily to scale. Any prospective purchaser must satisfy themselves of the correctness of the information within the particulars by inspection or otherwise. 3. Moore V Ltd trading as Moores Estate Agents does not have any authority to give any representations or warranties whatsoever in relation to this property (including but not limited to planning/building regulations), nor can it enter into any contract on behalf of the Vendor. 4. Moore V Ltd trading as Moores Estate Agents does not accept responsibility for any expenses incurred by prospective purchasers in inspecting properties which have been sold, let or withdrawn. 5. If there is anything of particular importance to you, please contact this office and we will try to have the information checked for you.

Energy Efficiency Rating		Current	Potential
<i>Very energy efficient - lower running costs</i>			
(92 plus)	<b>A</b>		
(81-91)	<b>B</b>		
(69-80)	<b>C</b>	69	80
(55-68)	<b>D</b>		
(39-54)	<b>E</b>		
(21-38)	<b>F</b>		
(1-20)	<b>G</b>		
<i>Not energy efficient - higher running costs</i>			
<b>England &amp; Wales</b>		EU Directive 2002/91/EC	

Follow us on... Facebook Twitter Instagram

www.mooresestateagents.com | office@mooresestateagents.com onTheMarket.com rightmove

