



35 Buckingham Gate

, London, SW1E 6PA

£600



Welcome to Buckingham Gate, London - a charming property that offers a delightful living experience in the heart of the city. This lovely house features 1 bedroom, 1 Reception and 1 bathroom, perfect for those seeking a spacious living space.

Situated in a prime location, this property boasts easy access to St James Park station, making commuting a breeze. The convenience of having shops and restaurants nearby ensures that you'll never run out of options for dining and entertainment.

Built in 1958, this house exudes character and charm, offering a unique blend of modern comfort and vintage appeal. The 527 sq ft of living space provides ample room for relaxation and entertainment, making it ideal for individuals or couples looking for a stylish urban retreat.

One of the standout features of this property is the live-in concierge service, and balcony adding an extra layer of security and convenience to your everyday life. Whether you're a busy professional or someone who enjoys the finer things in life, this property is sure to cater to your needs and preferences.



Area Map



Floor Plans

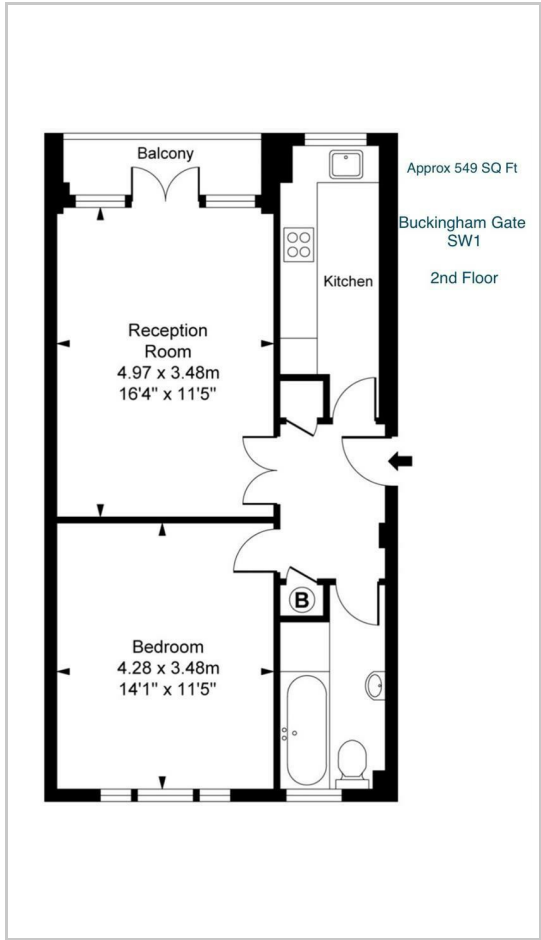

Energy Efficiency Graph

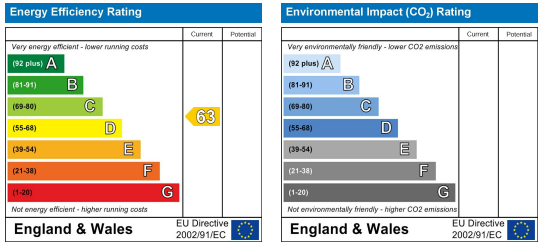

These particulars, whilst believed to be accurate are set out as a general outline only for guidance and do not constitute any part of an offer or contract. Intending purchasers should not rely on them as statements of representation of fact, but must satisfy themselves by inspection or otherwise as to their accuracy. No person in this firm's employment has the authority to make or give any representation or warranty in respect of the property.