

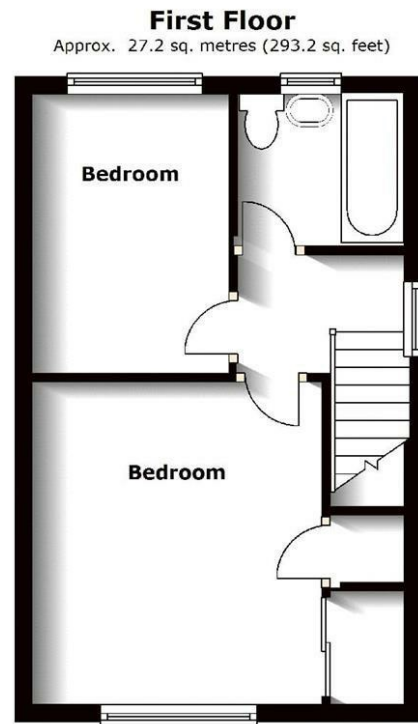

2 Solent Close, Pendeford, Wolverhampton, West Midlands, WV9 5QF

Neatly presented modern-style 2 Bedroom Semi-Detached House in corner position within estate setting on northern outskirts of Wolverhampton, convenient for all facilities. This freshly redecorated and re-carpeted home briefly comprises: Entrance Hall; Lounge with bay window and laminate flooring; Dining Kitchen with electric cooker, extractor hood, space and plumbing for washing machine, space for fridge freezer, ample cupboard space, dining area and pantry off; Two double Bedrooms, the principal having built-in mirrored wardrobes and boiler cupboard housing modern Worcester Bosch combination boiler; Modern Bathroom with panel bath, electric shower over, wash hand basin unit and WC; Gas central heating and uPVC double glazing; Off-Road Parking; Enclosed part walled rear garden with lawn and hard landscaping; ****IMMEDIATE AVAILABILITY - UNFURNISHED - SECURITY DEPOSIT £1200 OF WHICH HOLDING DEPOSIT £240 - LONG TERM LET AVAILABLE - NO TENANT FEES****

£1,050 PCM

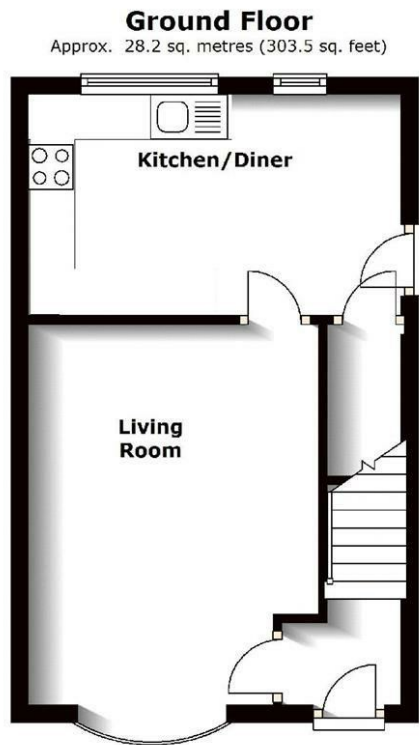

Total area: approx. 55.4 sq. metres (596.6 sq. feet)

Please do not scale.

We accept no responsibility for any mistake or inaccuracy contained within the floorplan. The floorplan is provided as a guide only and should be taken as an illustration. The contents and positioning are approximations only and provided as a guidance tool and not an exact replication of the property.

Plan produced using The Mobile Agent.

