



Flat 7 College Court High Street, Tettenhall, Wolverhampton, West Midlands, WV6 8QP

Excellent first floor Apartment in attractive modern-style block superbly positioned just off Upper Green with all village amenities within short walking distance. Comfortably proportioned accommodation presented in lovely order. Spacious Living Room (approx 185 sq.ft.). Stylish modern Kitchen. Double Bedroom with fitted wardrobes. Smart contemporary-style Bathroom including shower. Electric heating. Double glazed windows. Garage in court to rear. Beautifully landscaped communal gardens. EPC Rating: D. ****UNFURNISHED - IMMEDIATE AVAILABILITY - DEPOSIT £950 OF WHICH HOLDING DEPOSIT £190 - SORRY NO PETS - NO TENANT FEES****

£825 PCM

7 College Court

Approx. 45.3 sq. metres (487.9 sq. feet)

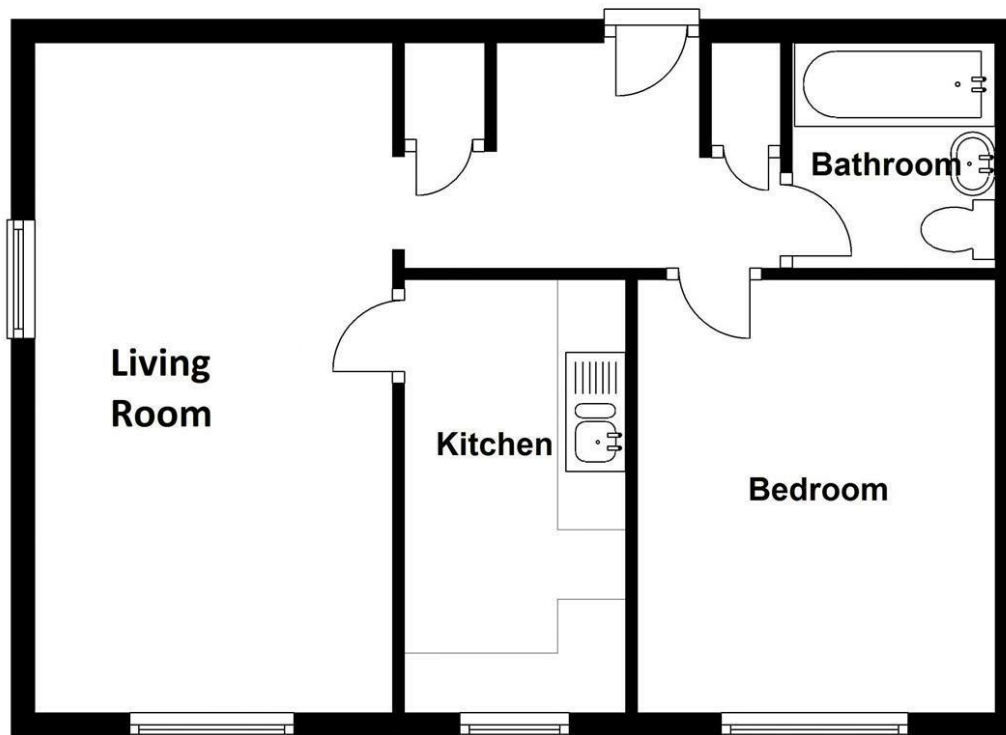

Total area: approx. 45.3 sq. metres (487.9 sq. feet)

Energy Efficiency Rating		
	Current	Potential
Very energy efficient - lower running costs		
(92 plus) A		
(81-91) B		
(69-80) C		
(55-68) D	57	68
(39-54) E		
(21-38) F		
(1-20) G		
Not energy efficient - higher running costs		
England & Wales	EU Directive 2002/91/EC	