

Directions

Viewings

Viewings by arrangement only. Call 0114 483 0038 to make an appointment.

EPC Rating

B

Energy Efficiency Rating		Current	Potential
Very energy efficient - lower running costs			
(92 plus) A			
(81-91) B		85	85
(69-80) C			
(55-68) D			
(39-54) E			
(21-38) F			
(1-20) G			
Not energy efficient - higher running costs			
England & Wales		EU Directive 2002/91/EC	

JC SALES & LETTINGS

Tel: 0114 483 0038

E-mail: sales@jc-salesandlettings.com

Website: www.jc-salesandlettings.com

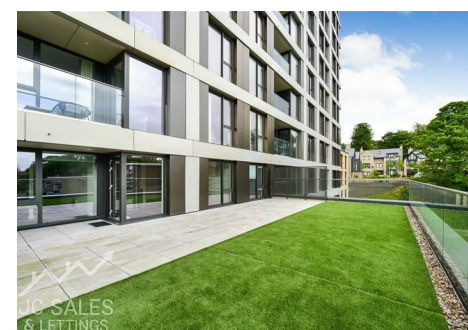

Apartment 305 Hallam Towers, Fulwood Road, Sheffield, South Yorkshire S10 3AZ £1,950 Per month

- Huge, outdoor terrace
- Available furnished or unfurnished
- Stunning, third floor apartment
- On-site fitness suite and swimming pool
- Early viewing is highly recommended
- Available for immediate occupation
- Incredible, far reaching views over Sheffield
- Full use of extensive on-site amenities
- Ideal for a professional couple or small family
- EPC Grade B



Total Area: 85.3 m² ... 919 ft² (excluding terrace)
All measurements are approximate and for display purposes only

JC SALES & LETTINGS

Apartment 305 Hallam Towers, Fulwood Road, Sheffield S10 3A7

AVAILABLE FOR IMMEDIATE OCCUPATION is this STUNNING, third floor apartment with a HUGE OUTDOOR TERRACE. Available furnished or unfurnished. This two DOUBLE bedroom, two bathroom apartment benefits from INCREDIBLE, FAR REACHING VIEWS over Sheffield and has full use of the EXTENSIVE ON-SITE AMENITIES, which includes a state of the art FITNESS SUITE and SWIMMING POOL. In brief the accommodation comprises: entrance hallway, utility room, large open plan living room / kitchen, two double bedrooms one with en-suite and a family bathroom / WC. One allocated car parking space. An internal inspection is highly recommended to appreciate the size and standard of accommodation on offer! EPC Grade B.

 2  2  1  B

Council Tax Band: C

