



## Flat 1, 33, Montgomery Place Montgomery Terrace , Sheffield, S6 3BW

£80 Per week



\*\*\* STUDENT / PROFESSIONAL SHARERS \*\*\* £80 PER PERSON PER WEEK \*\*\* BILLS INCLUDED OPTION AVAILABLE AT £105 PER PERSON PER WEEK  
\*\*\* AVAILABLE FOR A GROUP OF 4

A MODERN and PURPOSE BUILT student apartment with UNDER FLOOR HEATING and comes FULLY FURNISHED, with high quality fixtures and fittings.

Located conveniently for THE UNIVERSITY OF SHEFFIELD and a stones throw to the 24 HOUR TESCO and THE SUPERTRAM.

In brief the accommodation comprises: entrance hall, large open plan living room / kitchen, four double bedrooms and a bathroom / WC.

An early viewing is highly recommended to avoid disappointment! EPC Grade C.



Area Map



Floor Plans

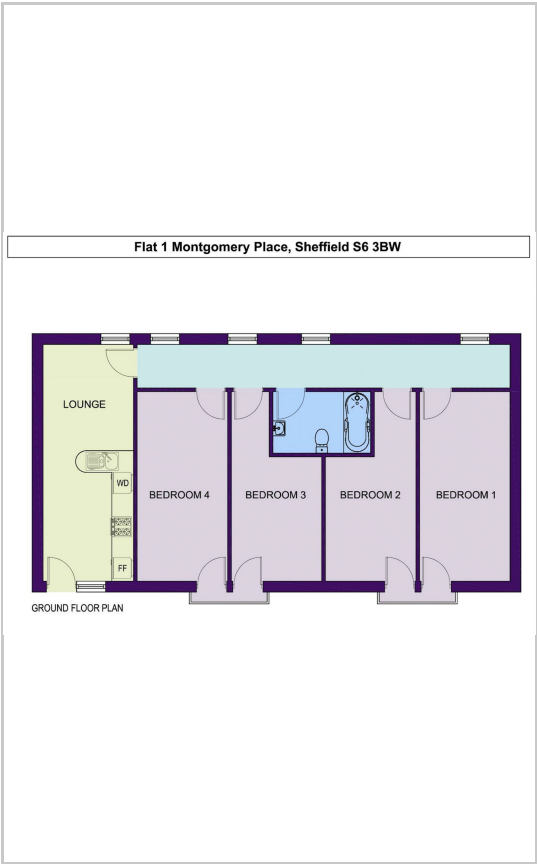

Energy Efficiency Graph

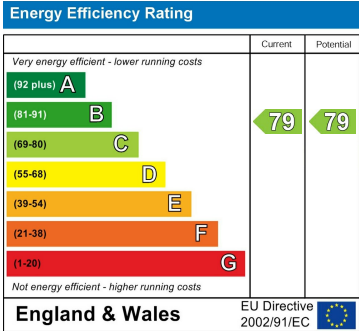

These particulars, whilst believed to be accurate are set out as a general outline only for guidance and do not constitute any part of an offer or contract. Intending purchasers should not rely on them as statements of representation of fact, but must satisfy themselves by inspection or otherwise as to their accuracy. No person in this firms employment has the authority to make or give any representation or warranty in respect of the property.