



## Apartment 3, Lion Works 92 Arundel Street , Sheffield, S1 4RE

**£100 Per week**



\*\*\* STUDENT / PROFESSIONAL SHARERS \*\*\* £100 PER PERSON PER WEEK \*\*\* BILLS INCLUDED OPTION AVAILABLE AT £125 PER PERSON PER WEEK \*\*\* AVAILABLE FOR A GROUP OF 4

Four DOUBLE bedroom apartment with TWO BATHROOMS occupying an enviable position on the TOP FLOOR in a PRIME CITY CENTRE LOCATION. Situated "On Campus" for Sheffield Hallam University and situated close to an abundance of local amenities. Fully furnished with luxury fittings throughout and gas under floor heating.

In brief the accommodation comprises: entrance hall, large open plan living room / kitchen, four double bedrooms and two bathrooms. An internal inspection is highly recommended to appreciate the size and standard of accommodation on offer! EPC Grade C.



Area Map



Floor Plans

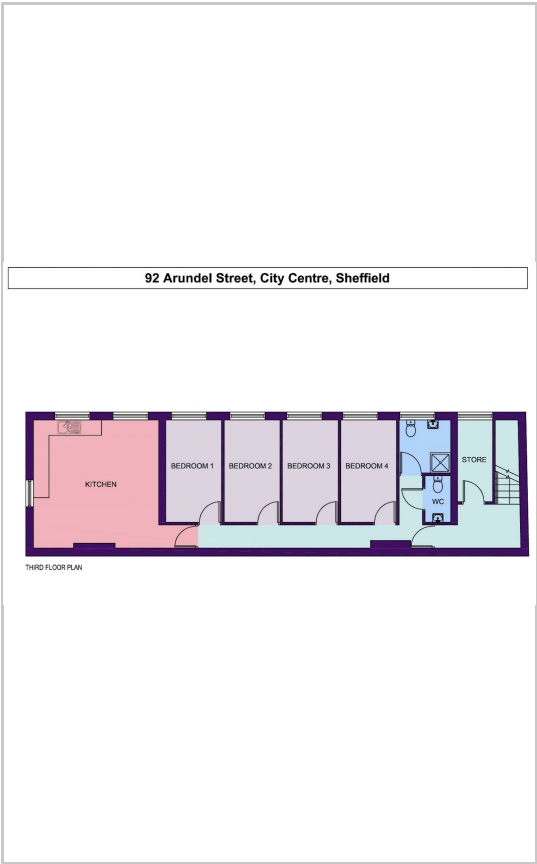

Energy Efficiency Graph

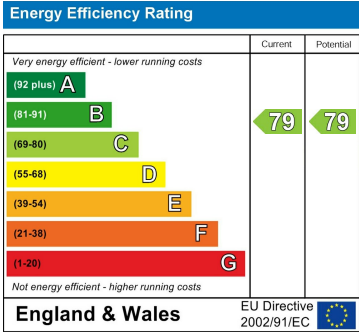

These particulars, whilst believed to be accurate are set out as a general outline only for guidance and do not constitute any part of an offer or contract. Intending purchasers should not rely on them as statements of representation of fact, but must satisfy themselves by inspection or otherwise as to their accuracy. No person in this firms employment has the authority to make or give any representation or warranty in respect of the property.