



**A TWO BEDROOM FIRST FLOOR APARTMENT IN THE HEART OF CHORLEYWOOD
VILLAGE WITH NO ONWARD CHAIN**

St Christophers Court, Lower Road, Chorleywood, Hertfordshire, WD3 5JZ

ROBSONS

St Christophers Court, Lower Road, Chorleywood,
Hertfordshire, WD3 5JZ

**RECEPTION ROOM • KITCHEN • TWO
BEDROOMS • BATHROOM • PARKING •
CENTRAL VILLAGE LOCATION • NO ONWARD
CHAIN**

Description

Situated in the charming and sought-after Chorleywood Village, this delightful first-floor 2-bedroom apartment offers a perfect blend of comfort, convenience, and community living. Benefiting from no onward chain, this property presents an ideal opportunity for first-time buyers, downsizers, or investors.

Boasting a spacious layout, the apartment features two well-proportioned bedrooms, a bright and airy living area, a kitchen and a bathroom. Residents will also enjoy the convenience of allocated parking, a valuable asset in such a central location.





Perfectly positioned just a short stroll from local shops, cafes, and amenities, this property also enjoys proximity to highly regarded schools and excellent transport links, including Chorleywood Station, offering easy access to London via the Metropolitan Line and Chiltern Railways.

Location

Chorleywood Village's facilities include a wide choice of boutique shops, coffee houses and restaurants. Marks & Spencer and Waitrose food halls are available in Rickmansworth. The area is also well served for sought after state and private schools for all ages. Leisure facilities include golf courses, cricket, football clubs, horse riding and fitness centres, together with Chorleywood Common and Rickmansworth Aquadrome, providing acres of outdoor space for walks and further activities. The Metropolitan and Main lines at Chorleywood Station offer a frequent service into London and beyond. The M25 is easily accessible via Junctions 17 and 18.

Additional Information

Tenure: Freehold

Local Authority: Three Rivers District Council

Council Tax Band: D

Energy Efficiency Rating: C

Lease Term: 87 years remaining

Service Charge: £1,920 pa

Ground Rent: £250.00 pa

For additional information, please refer to www.robsonsworld.com or call us on: 01923 285525.



Approximate Gross Internal Area
64.6 sq m / 695 sq ft

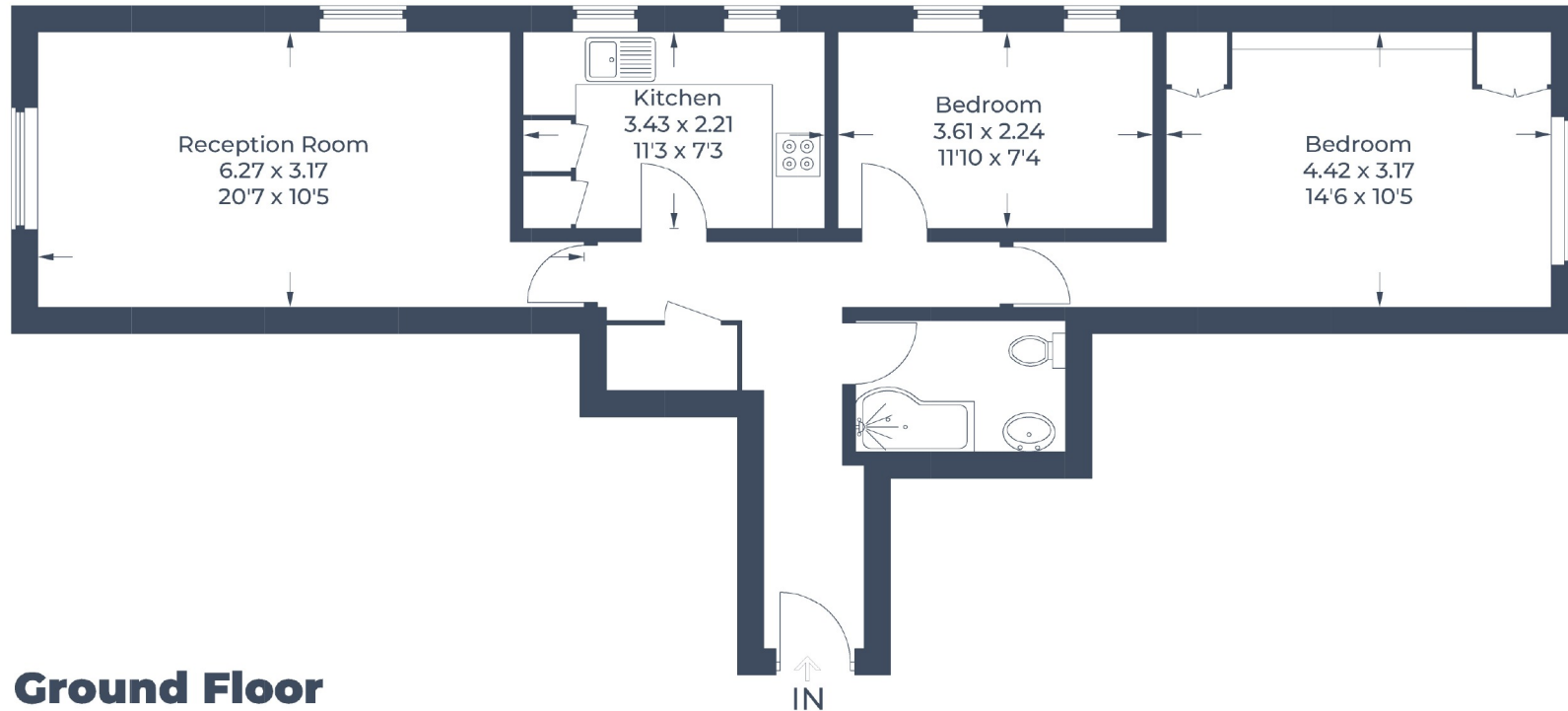

Ground Floor

Illustration for identification purposes only,
measurements are approximate, not to scale.
© CJ Property Marketing Produced for Robsons

ROBSONS

2 New Parade, Chorleywood, Hertfordshire, WD3 5NJ
Tel: 01923 285525 Email: chorleywood@robsonswb.com

www.robsonswb.com

SCAN TO VISIT



OUR WEBSITE

Important notice: Robsons, their clients and any joint agents give notice that 1: They are not authorised to make or give any representations or warranties in relation to the property either here or elsewhere, either on their own behalf or on behalf of their client or otherwise. They assume no responsibility for any statement that may be made in these particulars. These particulars do not form part of any offer or contract and must not be relied upon as statements or representations of fact. 2: Any areas, measurements or distances are approximate. Plot sizes and dimensions are taken from Promap and are approximate. The text, photographs and plans are for guidance only and are not necessarily comprehensive. It should not be assumed that the property has all necessary planning, building regulation or other consents and Robsons have not tested any services, equipment or facilities. Purchasers must satisfy themselves by inspection or otherwise.