

Burchetts Green Lane

Maidenhead • • SL6 3QW
: £1,325,000



coopers
est 1986

Burchetts Green Lane

Maidenhead • • SL6 3QW

NO CHAIN

A substantial five-bedroom detached residence in the heart of Burchett's Green, offering over 4,500 sq. ft. of living space and set within a generous 0.6-acre plot.

No Chain

Desirable Location

0.6 Acres Of Land

Potential To Extend STPP

Generous Accommodation Over Three Floors

Double Garage

Principle Bedroom With Dressing Room & En-Suite

Swimming Pool & Wraparound Gardens

Three Reception Rooms

Five Bedrooms

These particulars are intended as a guide and must not be relied upon as statements of fact. Your attention is drawn to the Important Notice on the last page.





The ground floor welcomes you with an inviting entrance hall leading to a formal dining room and a bright study, ideal for working from home. A generous sitting room with a bay window provides a comfortable family space, while the striking game room offers an additional reception of excellent proportions. The well-equipped kitchen/breakfast room benefits from abundant storage and direct access to the garden, complemented by a practical utility room.

On the first floor, four generously sized bedrooms include a luxurious principal suite, featuring a spiral staircase leading to a private dressing room, balcony, and a four-piece en-suite bathroom. A family bathroom serves the remaining bedrooms.

Set within approximately 0.6 acres, the property is approached via a private driveway through woodlands, leading to extensive parking for multiple vehicles and a double garage. The gardens wrap around the home, offers privacy and ample space for outdoor entertaining, with mature planting and lawned areas.

Ideally located close to Henley-on-Thames, the property enjoys easy access to a variety of amenities, including boutique shops, cafés, and restaurants. The area is celebrated for its riverside setting, scenic countryside walks, and excellent state and independent schools. Maidenhead railway station offers regular services to London Paddington while the M4 and M40 motorways are within easy reach, making this an exceptional choice for those seeking a harmonious blend of town and country living.



Schools:

Beech Lodge School 0.6 miles
 Burchetts Green CoE Infants' School 0.6 miles
 Newlands Girls' School 1.1 miles



Train:

Maidenhead Station 2.6 miles
 Furze Platt Station 2.6 miles
 Marlow Station 3.8 miles



Car:

M4, A40, M25, M40



Council Tax Band:

H

(Distances are straight line measurements from centre of postcode)



Burchetts Green Lane, Burchetts Green, Maidenhead, SL6

Approximate Area = 4121 sq ft / 382.8 sq m
 Garage = 351 sq ft / 32.6 sq m
 Total = 4472 sq ft / 415.4 sq m

For identification only - Not to scale

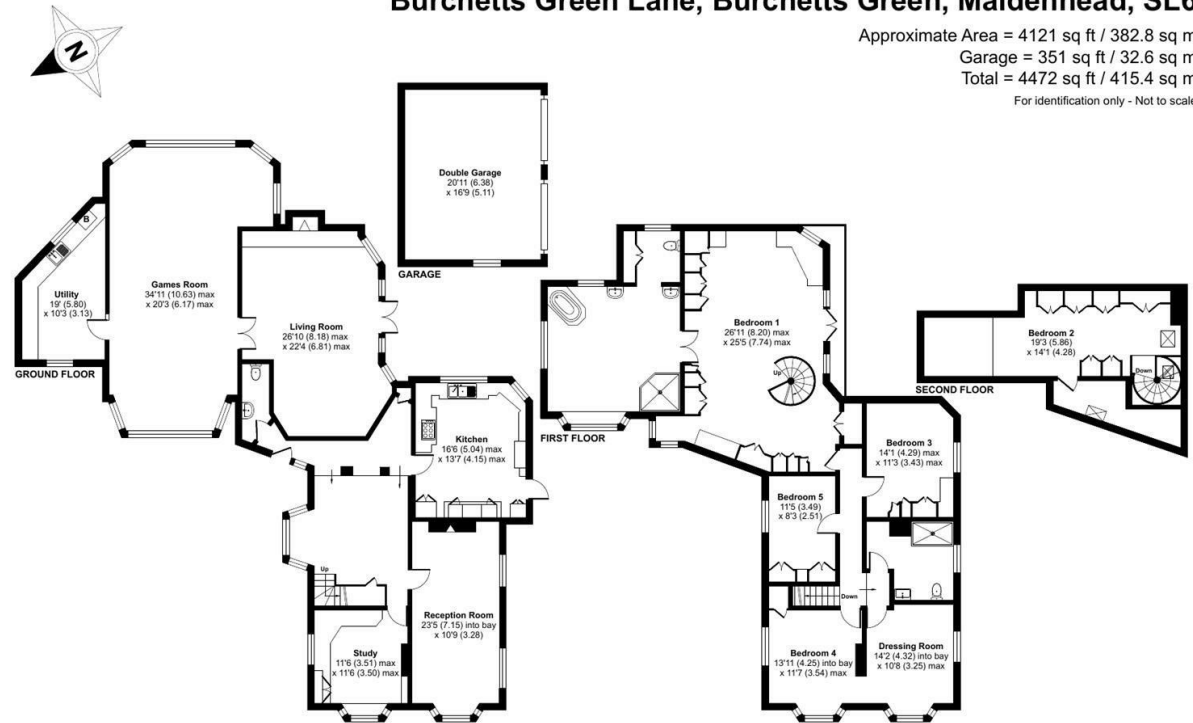

Floor plan produced in accordance with RICS Property Measurement 2nd Edition, incorporating International Property Measurement Standards (IPMS2 Residential). © nichecom 2025. Produced for Coopers. REF: 1345092

coopers
est 1986

coopers
est 1986

01628 232 550

42 Queen Street, Maidenhead,
SL6 1HZ

maidenhead@coopersresidential.co.uk

CoopersResidential.co.uk

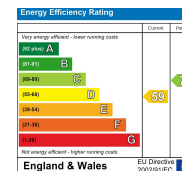

Important Notice: These particulars, whilst believed to be accurate are set out as a general outline only for guidance and do not constitute any part of an offer or contract. Intending purchasers should not rely on them as statements or representation of fact, but must satisfy themselves by inspection or otherwise has the authority to make or give any representation or warranty in respect of the property.