

51 Lower Cookham Road

M Maidenhead • • SL6 8JX
Offers In Excess Of: £490,000



coopers
est 1986

51 Lower Cookham Road

Maidenhead • • SL6 8JX

A beautifully presented three-bedroom apartment situated in Maidenhead's desirable riverside area.

Prestigious Gated Development

Three Bedrooms

Open Plan

Ensuite to Masterbedroom

Maidenheads Riverside Area

Two Allocated Parking Spaces and Guest Parking

Beautiful Communal Garden

Balcony

Close to Local Amendities

Excellent Schools Nearby

These particulars are intended as a guide and must not be relied upon as statements of fact. Your attention is drawn to the Important Notice on the last page.





Property

This charming first-floor apartment boasts a bright and spacious open-plan kitchen, living, and dining area, where French doors open onto a balcony overlooking the serene communal garden. The master bedroom benefits from an ensuite, while two additional bedrooms and a thoughtfully positioned family bathroom complete this beautifully designed home.

Outside

Set within a prestigious gated development with lovely communal gardens, this apartment offers the convenience of two allocated parking spaces along with additional visitor parking.

Location

Located in the tranquil northern area of Maidenhead Riverside, near the borders of Cookham, this apartment is local to Maidenheads Elizabeth Line and well connected to the M4, M404.





Schools:

St Nicolas' Church of England Combined School 0.8 miles
RBWM Alternative Learning Provision 1.2 miles



Train:

Furze Platt Station 1.2 miles
Taplow Station 1.4 miles
Cookham Station 1.5 miles



Car:

M4, A40, M25, M40



Council Tax Band:

E

(Distances are straight line measurements from centre of postcode)

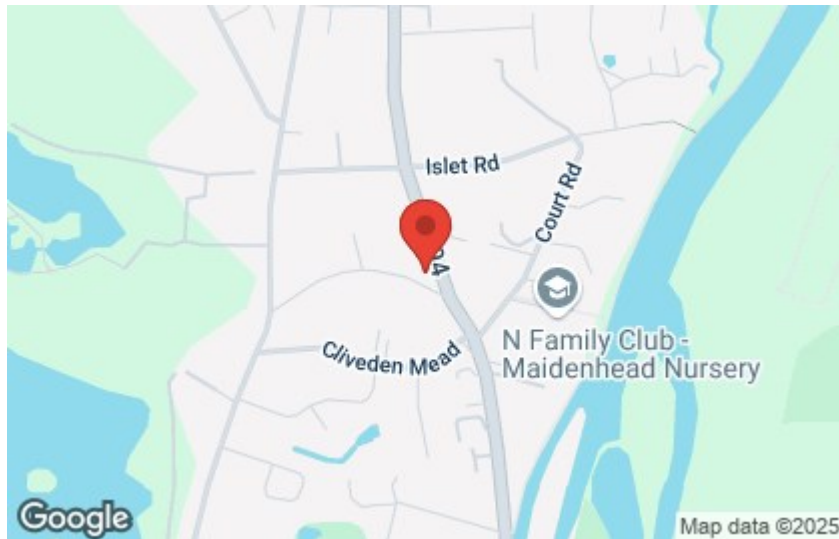

Lower Cookham Road, Maidenhead, SL6

Approximate Area = 1008 sq ft / 93.6 sq m
Outbuilding = 6 sq ft / 0.5 sq m
Total = 1014 sq ft / 94.1 sq m
For identification only - Not to scale

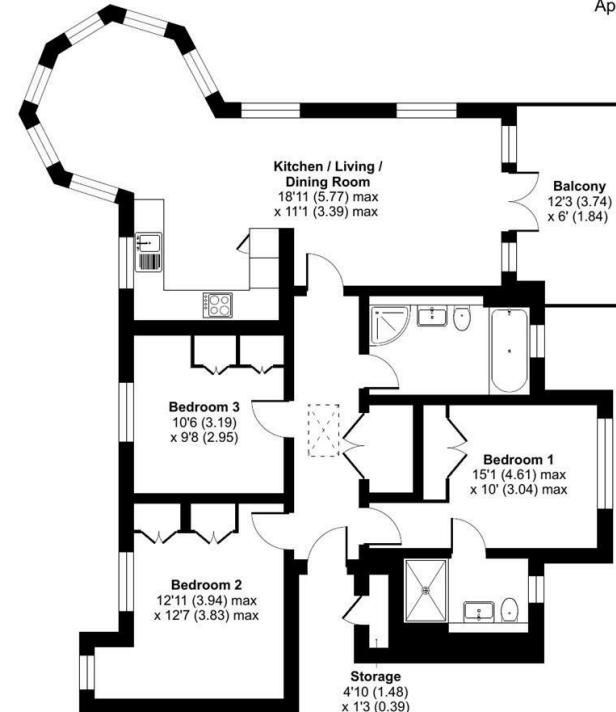

FIRST FLOOR



Floor plan produced in accordance with RICS Property Measurement 2nd Edition, incorporating International Property Measurement Standards (IPMS2 Residential). © nichcom 2025. Produced for Coopers. REF: 1233986

coopers
est 1986

coopers
est 1986

01628 232 550

42 Queen Street, Maidenhead,
, SL6 1HZ

maidenhead@coopersresidential.co.uk

CoopersResidential.co.uk

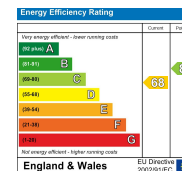

Important Notice: These particulars, whilst believed to be accurate are set out as a general outline only for guidance and do not constitute any part of an offer or contract. Intending purchasers should not rely on them as statements or representation of fact, but must satisfy themselves by inspection or otherwise has the authority to make or give any representation or warranty in respect of the property.